

## DMBP 250A Suregrip Digi-Pull Mig/Mag Torch Range

Rating: 230A CO<sub>2</sub>, 200A mixed gas, EN60974-7 @ 60% duty cycle. 0.8 to 1.2mm wires

Air-Cooled Mig Welding Torch

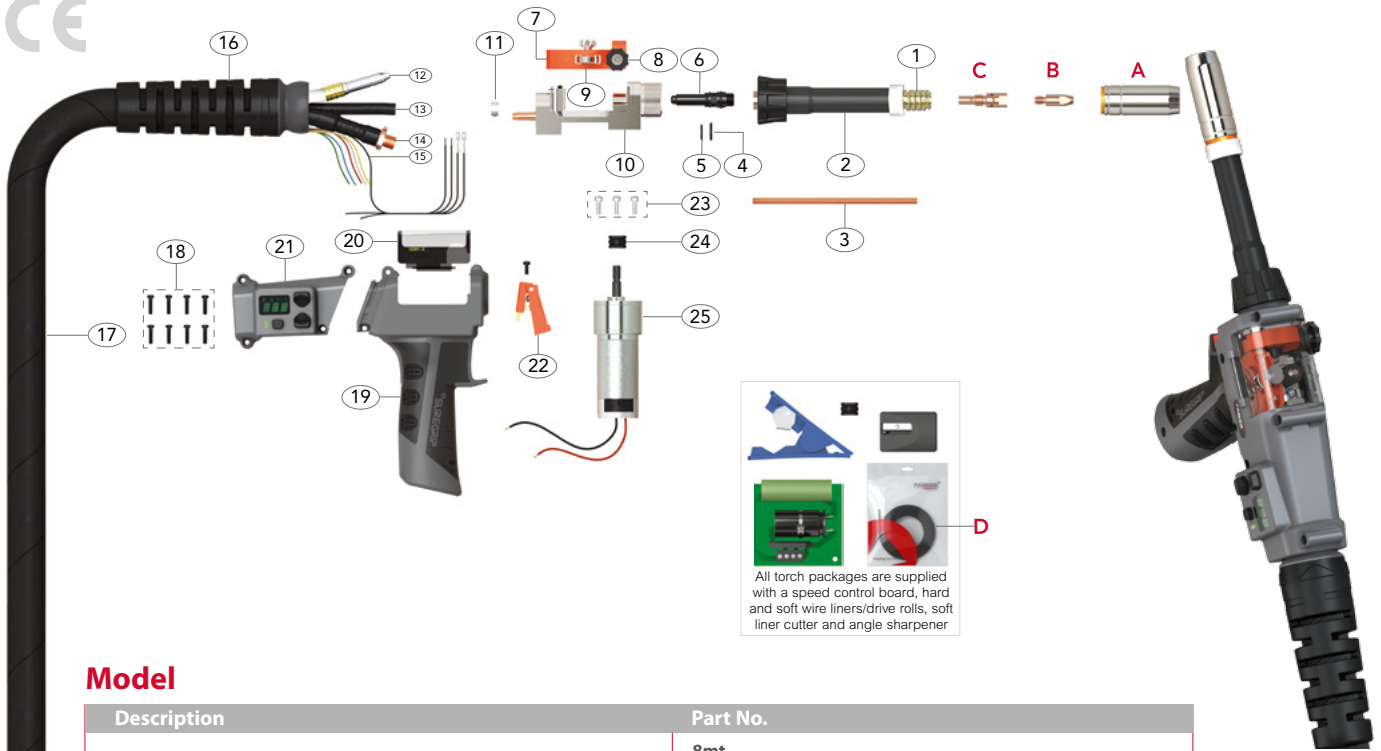

### Model

| Description  | Part No.   |
|--|--|
|  | <b>8mt</b>   |
| <b>Suregrip 42V Digi-Pull Mig Package Neck x 8mt</b> | <b>DMBP2500-42-A180-DM3-80ER</b>   |
|  | Torch packages can be fitted with an optional wire speed control Potentiometer |

Alternative torch packages can be configured using the configurator on page 11

### Wear Parts

#### A Nozzles

| Part No. | Description         | Bore | Wall  | Material |
|----------|---------------------|------|-------|----------|
| PB2507   | Cylindrical Nozzle  | 18.0 | 1.5mm | Cu       |
| *PB2508  | Conical Nozzle      | 15.0 | 1.5mm | Cu       |
| PB2509   | Tapered Nozzle      | 12.0 | 1.5mm | Cu       |
| PB2510   | Bottle Nozzle       | 14.5 | 1.5mm | Cu       |
| PB2511   | Spot Welding Nozzle | 18.0 | 1.5mm | Cu       |

#### B Contact Tips

| Part No.    | Description | Material | Wire Size    |
|-------------|-------------|----------|--------------|
|             |             |          | mm    Inch   |
| PB2504-08   | Contact Tip | Cu       | 0.8    0.030 |
| PB2504-09   | Contact Tip | Cu       | 0.9    0.035 |
| PB2504-10   | Contact Tip | Cu       | 1.0    0.040 |
| PB2504-12   | Contact Tip | Cu       | 1.2    0.045 |
| PB2504-10A  | Contact Tip | Cu       | 1.0    0.040 |
| *PB2504-12A | Contact Tip | Cu       | 1.2    0.045 |
| PB2505-08   | Contact Tip | CuCrZr   | 0.8    0.030 |
| PB2505-09   | Contact Tip | CuCrZr   | 0.9    0.035 |
| PB2505-10   | Contact Tip | CuCrZr   | 1.0    0.040 |
| PB2505-12   | Contact Tip | CuCrZr   | 1.2    0.045 |
| PB2505-10A  | Contact Tip | CuCrZr   | 1.0    0.040 |
| PB2505-12A  | Contact Tip | CuCrZr   | 1.2    0.045 |

#### C Tip Adaptors

| Part No. | Description    | Material |
|----------|----------------|----------|
| *PB2506  | Tip Adaptor    | Brass    |
| PB2536   | Tip Adaptor M8 | Brass    |

#### D Liner

| Part No.   | Description           | Length | Wire Size |
|------------|-----------------------|--------|-----------|
|            |                       |        | mm        |
| *PB2564-80 | Polyamide Liner x 8mt | 8.6mt  | 1.0-1.2   |

### Cable Parts

| Description             | Part No.    |
|-------------------------|-------------|
|                         | <b>8mt</b>  |
| 12 Outer Liner Assembly | PGP3608-80  |
| 13 Gas Hose Assembly    | PGP36413-80 |
| 14 Power Cable Assembly | PGP36015-80 |
| 15 Switch Lead Assembly | PGP36410-80 |

\*Denotes torch package standard wear part set-up  
For more information please refer to the following sections:  
• Master Wear Parts Table    Page 20-25  
• Rear-End / Cable Parts    Page 26

# DMBP 250A Suregrip Digi-Pull Mig/Mag Torch Range

Rating: 230A CO<sub>2</sub>, 200A mixed gas, EN60974-7 @ 60% duty cycle. 0.8 to 1.2mm wires

Air-Cooled Mig Welding Torch



## Spare Parts

| Part No. | Description                       |
|----------|-----------------------------------|
| 1        | PB2502 Shroud Spring              |
| 2        | PSP2501 Straight Neck Assembly    |
| 3        | PGP3602A Jump Liner               |
| 4        | 9×1.5 "O" ring                    |
| 5        | 7×1.5 "O" ring                    |
| 6        | PGP36006 Jump Liner Nipple        |
| 7        | PGP36402 Pressure Arm Assembly    |
| 8        | PGP36402B Tension Knob            |
| 9        | PGP36402R Pressure Roll           |
| 10       | PGP36001 Motor Body               |
| 11       | PB5041 Water Hose Clamp 8.7mm     |
| 16       | PGP3208 Handle Cable Support      |
| 17       | PGP36419-80 Canvas Cover Assembly |
| 18       | PKA3X20 Handle Screw Pack         |
| 19       | PGP2515/KJ Digi Push Pull Handle  |

| Part No. | Description  |
|----------|--|
| 20       | PGP2514/C Push Pull Handle Cover                       |
| 21       | PGP2515DM3 Digi Push Pull Handle / Control Module      |
| 22       | PGP2516 Trigger  |
| 23       | PGPMS1 Motor Screw Pack                                |
| 24       | SGP8224W-08 Drive Roll For Steel Wire $\phi$ 0.8       |
|          | SGP8224W-09 Drive Roll For Steel Wire $\phi$ 0.9       |
|          | SGP8224W-10 Drive Roll For Steel Wire $\phi$ 1.0       |
|          | SGP8224W-12 Drive Roll For Steel Wire $\phi$ 1.2       |
|          | SGP8224W-16 Drive Roll For Steel Wire $\phi$ 1.6       |
|          | SGP8224W-08U Drive Roll For Aluminium Wire $\phi$ 0.8  |
|          | SGP8224W-09U Drive Roll For Aluminium Wire $\phi$ 0.9  |
|          | SGP8224W-10U Drive Roll For Aluminium Wire $\phi$ 1.0  |
|          | *SGP8224W-12U Drive Roll For Aluminium Wire $\phi$ 1.2 |
|          | SGP8224W-16U Drive Roll For Aluminium Wire $\phi$ 1.6  |
| 25       | SGP8224-24 Motor 24V DC                                |
|          | SGP8224-42 Motor 42V DC                                |