

# SCMP 120R Suregrip Surecut Plasma Cutting Torch Range

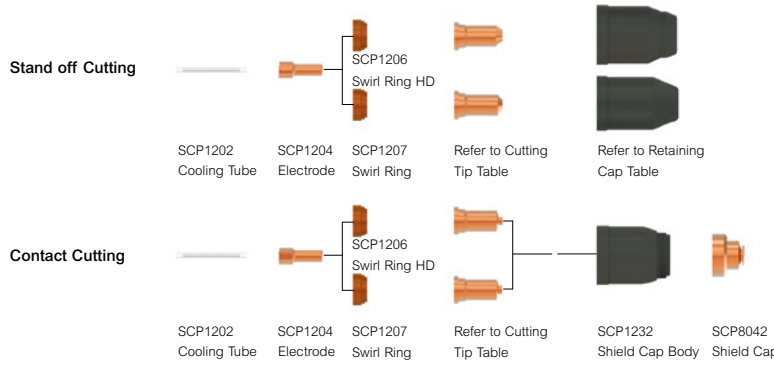

Rating: 120A Air/N<sub>2</sub> gas, @ 60% duty cycle.  
Air-Cooled Cutting Torch Range

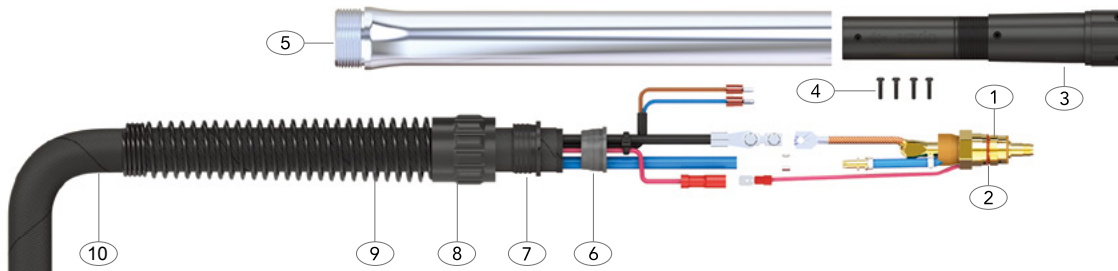

## Model

Description	Part No.	
Suregrip Plasma Cutting Torch Package	4mt	6mt
	SCMP120R-40-CF5	SCMP120R-60-CF5

Alternative torch packages can be configured using the configurator on page 12

## Wear Parts

### Cutting Tips

Part No.	Description	Bore $\phi$ A	Amps
SCP1220-10	Cutting Tip	1.0mm	40-50A
SCP1220-11	Cutting Tip	1.1mm	50-60A
SCP1220-12	Cutting Tip	1.2mm	60-70A
SCP1221-14	Cutting Tip	1.4mm	80-90A
SCP1221-15	Cutting Tip	1.5mm	100-110A
*SCP1221-16	Cutting Tip	1.6mm	110-120A
SCP1222-09	Cutting Tip Contact	0.9mm	30-40A
SCP1228-22	Gouging Tip	2.2mm	120A
SCP1226-10	Cutting Tip Contact	1.0mm	40-50A
SCP1226-11	Cutting Tip Contact	1.1mm	50-60A
SCP1226-12	Cutting Tip Contact	1.2mm	60-70A
SCP1227-14	Cutting Tip Contact	1.4mm	80-90A
SCP1227-15	Cutting Tip Contact	1.5mm	100-110A
SCP1227-16	Cutting Tip Contact	1.6mm	110-120A

### Retaining Caps

Part No.	Description
*SCP1230	Retaining Cap,30-70A
SCP1231	Retaining Cap,80-120A

### Spare Parts

Part No.	Description
1	SCMP1201 SCMP120 180° Torch Head Kit
2	SCP1208 O Ring
3	SCP8118 Auto Torch Head Housing
4	SCPSP1-1 Screw Pack
5	SCP8110 Auto Handle
6	SCP8010 Plasma Plastic Insert
7	PB8110A Auto Handle Insert
8	PB8030A Auto Handle Lock Nut
9	PBL8017A Auto Handle Spring
10	*SCP8119C-40 -# Cable Assembly Complete x 4mt
	*SCP8119C-60 -# Cable Assembly Complete x 6mt



\*Denotes torch package standard wear part set-up  
For more information please refer to the following sections:  
•Cable Terminations Page 10  
•Master Wear Parts Table Page 24-30  
•Wear Parts Configuration Tables Page 31-33