

SCP 25 Suregrip Surecut Plasma Cutting Torch Range

Rating: 25A Air/N₂ gas, @ 60% duty cycle.

Air-Cooled Cutting Torch Range

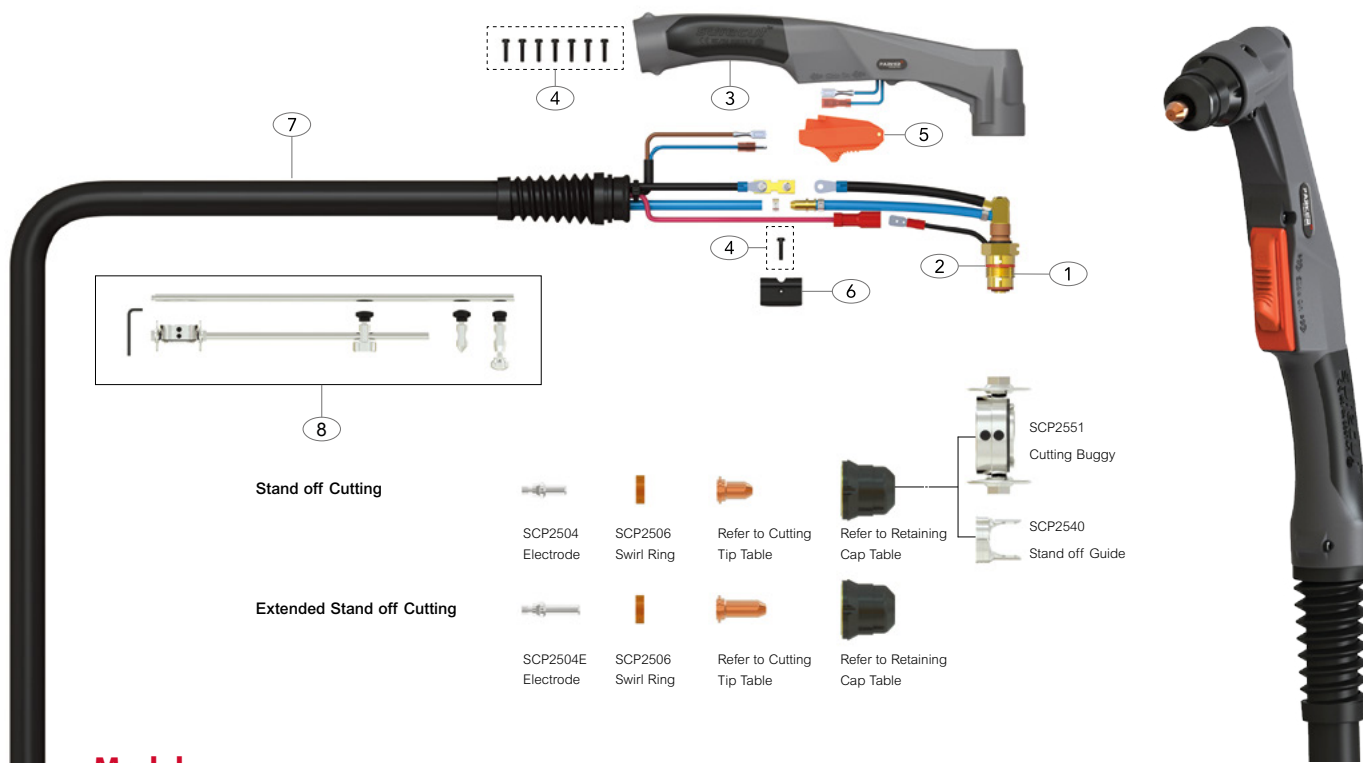

Stand off Cutting

Extended Stand off Cutting

- | | | | | | |
|-----------------------|-----------------------|-------------------------------|---------------------------------|--------------------------|----------------------------|
| SCP2504
Electrode | SCP2506
Swirl Ring | Refer to Cutting
Tip Table | Refer to Retaining
Cap Table | SCP2551
Cutting Buggy | SCP2540
Stand off Guide |
| SCP2504E
Electrode | SCP2506
Swirl Ring | Refer to Cutting
Tip Table | Refer to Retaining
Cap Table | | |

Model

Description	Part No.	
Suregrip Plasma Cutting Torch Package	4mt	6mt
	SCP25-40-CF1	SCP25-60-CF1

Alternative torch packages can be configured using the configurator on page 12

Wear Parts

Cutting Tips

Part No.	Description	Bore ϕ A	Amps
SCP2520-06	Cutting Tip	0.65mm	10-20A
*SCP2520-08	Cutting Tip	0.8mm	20-30A
SCP2520-06E	Cutting Tip Extended	0.65mm	10-20A
SCP2520-08E	Cutting Tip Extended	0.8mm	20-30A

Retaining Caps

Part No.	Description
SCP2530-1	Retaining Cap, 1 hole
*SCP2530-2	Retaining Cap, 2 holes
SCP2530-4	Retaining Cap, 4 holes

Spare Parts

Part No.	Description
1 SCP2501	SCP25 70° Torch Head Kit
2 SCP2508	O Ring
3 SCP2514	Plasma Handle Kit
4 SCPSP1	Screw Pack
5 SCP2516	Plasma Safety Trigger
6 SCP2515	Location Block
7 *SCP2519-40-#	Cable Assembly Complete x 4mt
*SCP2519-60-#	Cable Assembly Complete x 6mt
8 SCP2550	Circle Cutting Attachment Kit

CF1

*Denotes torch package standard wear part set-up
For more information please refer to the following sections:
• Cable Terminations Page 10
• Master Wear Parts Table Page 24-30
• Wear Parts Configuration Tables Page 31-33