

SCP 80R Suregrip Surecut Plasma Cutting Torch Range

Rating: 80A Air/N₂ gas, @ 60% duty cycle.

Air-Cooled Cutting Torch Range

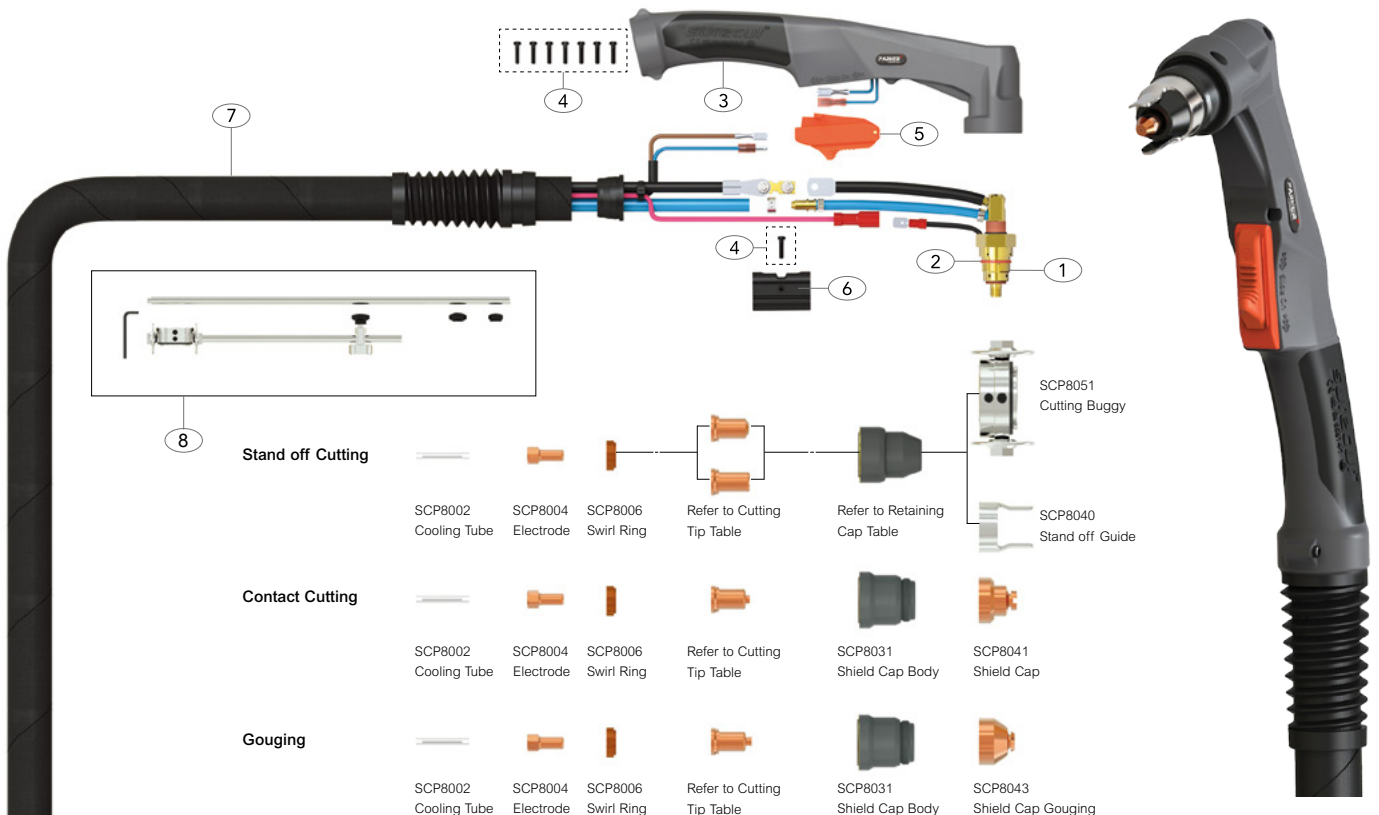

Stand off Cutting

SCP8002	SCP8004	SCP8006	Refer to Cutting	Refer to Retaining	SCP8051
Cooling Tube	Electrode	Swirl Ring	Tip Table	Cap Table	Cutting Buggy
					SCP8040
					Stand off Guide

Contact Cutting

SCP8002	SCP8004	SCP8006	Refer to Cutting	SCP8031	SCP8041
Cooling Tube	Electrode	Swirl Ring	Tip Table	Shield Cap Body	Shield Cap

Gouging

SCP8002	SCP8004	SCP8006	Refer to Cutting	SCP8031	SCP8043
Cooling Tube	Electrode	Swirl Ring	Tip Table	Shield Cap Body	Shield Cap Gouging

Model

Description	Part No.	
	Suregrip Plasma Cutting Torch Package	4mt
SCP80R-40-CF4		SCP80R-60-CF4

Alternative torch packages can be configured using the configurator on page 12

Wear Parts

Part No.	Description	Bore Ø A	Amps
SCP8022-09	Cutting Tip Cross Groove	0.9mm	30-40A
SCP8028-16	Gouging Tip	1.6mm	80A
SCP8020-10	Cutting Tip	1.0mm	40-50A
SCP8020-11	Cutting Tip	1.1mm	50-60A
SCP8020-12	Cutting Tip	1.2mm	60-70A
*SCP8020-13	Cutting Tip	1.3mm	70-80A
SCP8026-10	Cutting Tip Contact	1.0mm	40-50A
SCP8026-11	Cutting Tip Contact	1.1mm	50-60A
SCP8026-12	Cutting Tip Contact	1.2mm	60-70A
SCP8026-13	Cutting Tip Contact	1.3mm	70-80A

Retaining Caps

Part No.	Description
*SCP8030	Retaining Cap

Spare Parts

Part No.	Description
1	SCP8001 SCP80 70° Torch Head Kit
2	SCP2508 O Ring
3	SCP8014C Plasma Handle Kit
4	SCPSP1 Screw Pack
5	SCP2516 Plasma Safety Trigger
6	SCP8015 Location Block
7	*SCP8019C-40-# Cable Assembly Complete x 4mt
	*SCP8019C-60-# Cable Assembly Complete x 6mt
8	SCP8050 Circle Cutting Attachment Kit

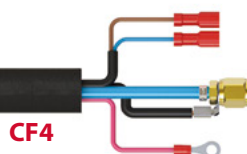

*Denotes torch package standard wear part set-up
 For more information please refer to the following sections:
 • Cable Terminations Page 10
 • Master Wear Parts Table Page 24-30
 • Wear Parts Configuration Tables Page 31-33