

STR A81 Suregrip TRF Plasma Cutting Torch Range

Rating: 80A Air/N₂ gas, @ 60% duty cycle.

Air-Cooled Cutting Torch Range

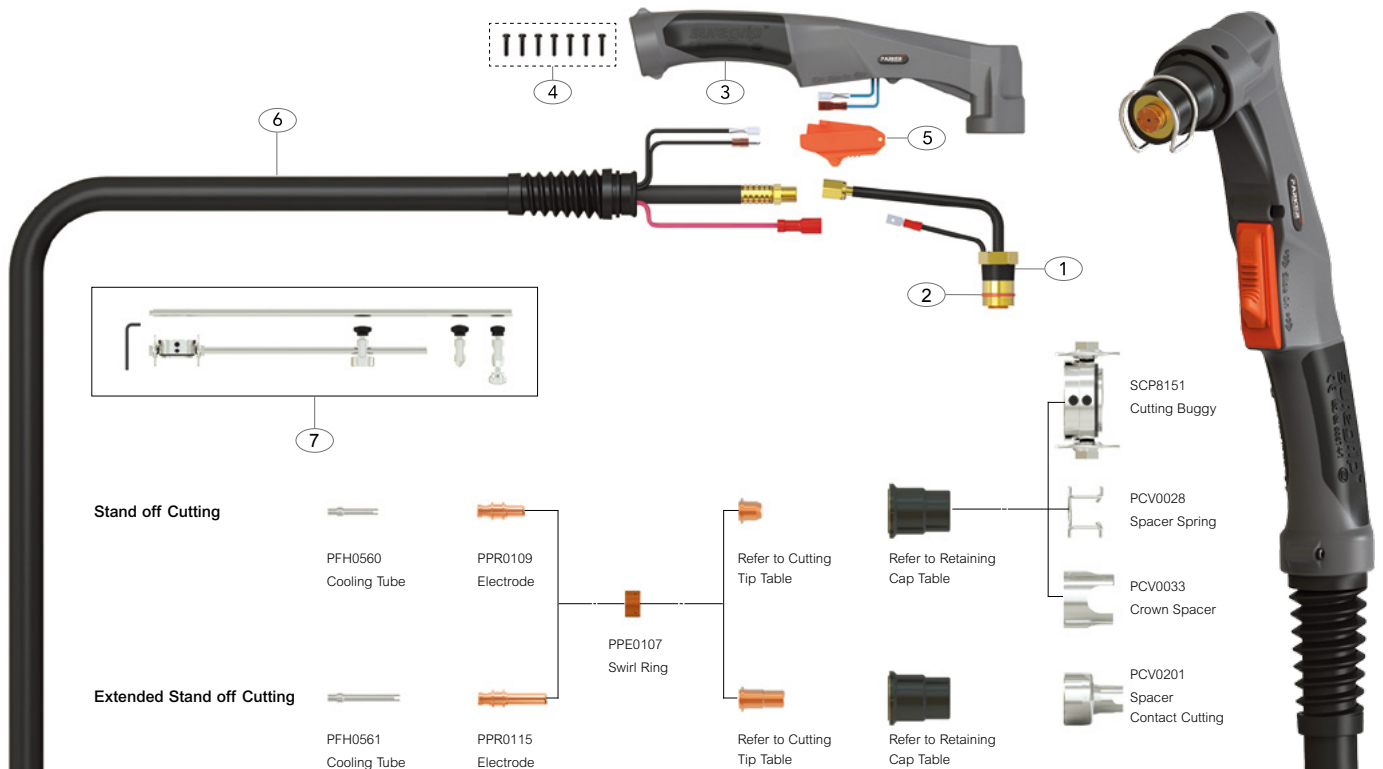

Stand off Cutting



PFH0560
Cooling Tube



PPR0109
Electrode



PPE0107
Swirl Ring



Refer to Cutting
Tip Table



Refer to Retaining
Cap Table



SCP8151
Cutting Buggy



PCV0028
Spacer Spring



PCV0033
Crown Spacer



PCV0201
Spacer
Contact Cutting

Extended Stand off Cutting



PFH0561
Cooling Tube



PPR0115
Electrode



Refer to Cutting
Tip Table



Refer to Retaining
Cap Table

Model

Description	Part No.	
	4mt	6mt
Suregrip TRF Plasma Cutting Torch Package	STR A81-40-CF9	STR A81-60-CF9

Alternative torch packages can be configured using the configurator on page 12

Wear Parts

Cutting Tips

Part No.	Description	Bore \varnothing A	Amps
*PPD0105-10	Cutting Tip	1.0mm	50A
PPD0105-11	Cutting Tip	1.1mm	60A
PPD0105-12	Cutting Tip	1.2mm	70A
PPD0106-10	Cutting Tip Extended	1.0mm	50A
PPD0106-12	Cutting Tip Extended	1.2mm	70A

Retaining Caps

Part No.	Description
*PPC0115	Retaining Cap

Spare Parts

Part No.	Description
1 STR0140	STR81 70° Torch Head Kit
2 SCP8008	O Ring
3 SCP8014/HF	Plasma Handle Kit
4 SCPSP1	Screw Pack
5 SCP2516	Plasma Safety Trigger
6 *SCP8119-40 -#	Cable Assembly Complete x 4mt
*SCP8119-60 -#	Cable Assembly Complete x 6mt
7 PCV0052	Circle Cutting Attachment Kit

CF9

*Denotes torch package standard wear part set-up
For more information please refer to the following sections:
•Cable Terminations Page 10
•Master Wear Parts Table Page 30-37
•Wear Parts Configuration Tables Page 38-41