

SUREGRIP DISTANCE
MIG/MAG SERIES



Welding Tools for the Professional

A Smart Approach

Parker Torchology is shaped by people with vision, a passion for improvement and a belief in delivering the very best Welding and Cutting Torch Range in the World.

We expect a great deal from our products, so we ask a lot of ourselves and our engineers.

Our mantra: **Innovation, Technology, Performance.**



DNA

Design and Engineering excellence are at the core of everything we do.

Every torch we build is driven by our relentless pursuit of perfection.

Premium Features

At Parker Torchology we do things differently, we strive to solve your problems with the perfect product to suit your needs. We create smart product features encased in cutting-edge design to ensure you always have the best tools to hand.





Production

A fusion of precision production engineering, our bespoke processing techniques and a fanatical attention to detail ensures every welding torch we produce is worthy of the Parker Torchology name.

Testing, Testing, Testing

It takes patience to develop a new product, it's a lot more than a great idea.

Product development is an iterative process, trying something over and over, changing one small variable at a time.

We build endless prototypes and test pieces that undergo months of rigorous testing. Only once a product has passed up to 88 different test procedures, with every single part tested separately do we consider our latest designs ready for market.

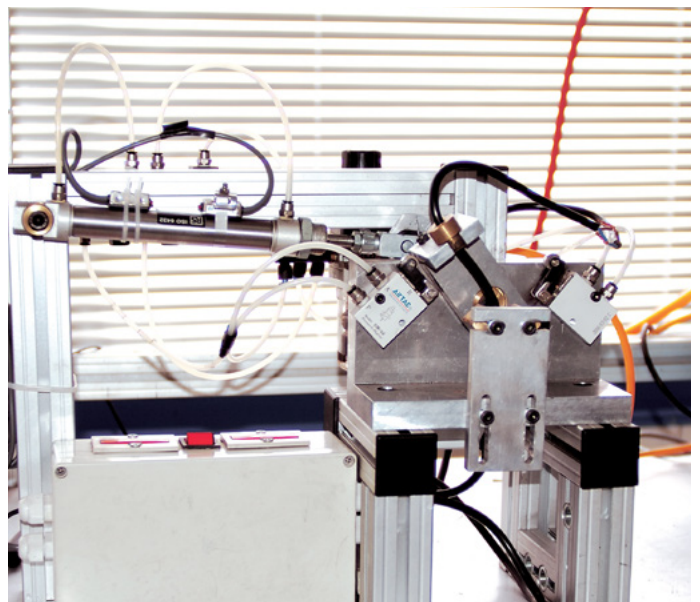

Partners

Our customers and business partners play a vital role in our development. With the core aim to strive together, we work with end-users, distributors and academic institutions alike.

As a result we share fundamental values in order to succeed in our respective market places, supporting economic growth and collaborative opportunities with others.

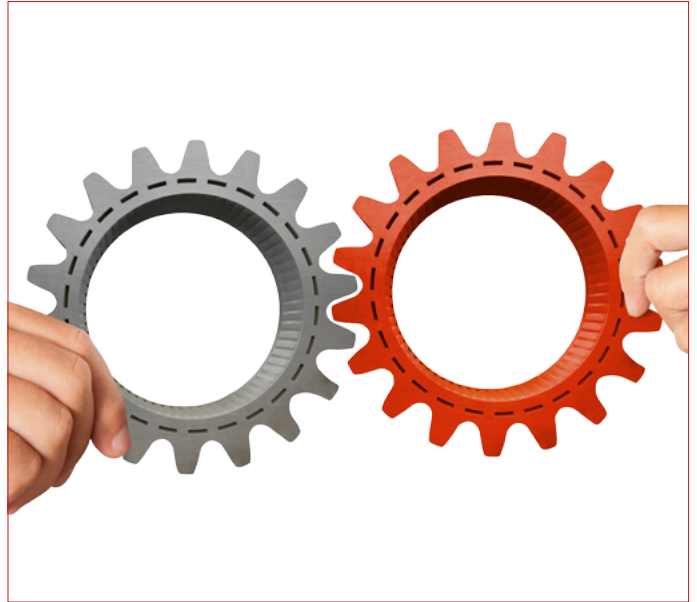

A Bright Future

Technology doesn't stand still, which is why we are constantly innovating to bring you the best products on the market.

Our strong vision and focused innovation strategy, not to mention our passion to revolutionize the industry, ensure that Parker Torchology is a byword for excellence.

We Talk Torches

Ranges

Distance Mig/Mag Torch Series

Duragrip Spool-On Mig/Mag Torch Range	5
Suregrip Pull Mig/Mag Torch Range	19

Air-Cooled

Contents

Duragrip Spool-On Mig/Mag Torch Range Features Focus	6
Duragrip Spool-On Mig/Mag Torch Range Overview and Ratings	8

Torch Range

Duragrip Spool-On Mig/Mag DSP 150A	10
Duragrip Spool-On Mig/Mag DSP 240A	12
Duragrip Spool-On Mig/Mag DSP 250A	14
Duragrip Spool-On Mig/Mag DSP 360A	16

Wear Parts

Nozzles	34
Contact Tips	36
Tip Adaptors	38
Diffusers	38

Duragrip Spool-On Mig/Mag Gun Range

Air-Cooled Features Focus

Air-Cooled

Spool-On guns are compact in design and offer a cost effective solution for low deposition Mig welding and precise control of soft wires.

A Cost Effective Solution for Long Distance and Low Deposition Welding



100% Binzel® Wear Parts Compatibility Guaranteed

Quality Wear Parts

All wear parts are manufactured to exacting specifications ensuring reliability, longevity and superior performance

- The same wear parts are utilized as standard BZL ranges minimizing stock handling
- Contact tips are manufactured using high quality copper alloys
- High-performance tip adaptors, diffusers and swan necks

Ergonomics – For Comfort and Handleability

Every detail has been considered to ensure the welder has the very best handling

- Improved balance and positionability resulting in reduced welder fatigue
- A knuckle joint enables small movements of the handle independently of the cable assembly
- Variable speed control at the handle



Infinately Adjustable Wire Tension

- A unique lever action wire retainer and brake system holds all soft wire spools in place at the correct brake tension
- A further secondary brake system is integrated into the spool holder for independent adjustment of larger steel wires on all torches over 200 Amp

Features Focus

Welding Tools for the Professional



Precision and Visibility

- Precise and constant wire feed
- Contact pressure of the feed rollers regulated directly on the handle
- Transparent window for quick and easy reference to all moving parts
- Rapid access for wire changes
- 24V or 42V Feed Motors

Flexibility and Durability

- A unique Duraflex Ultralite cable system has been developed with all torch supply elements integrated into the cable

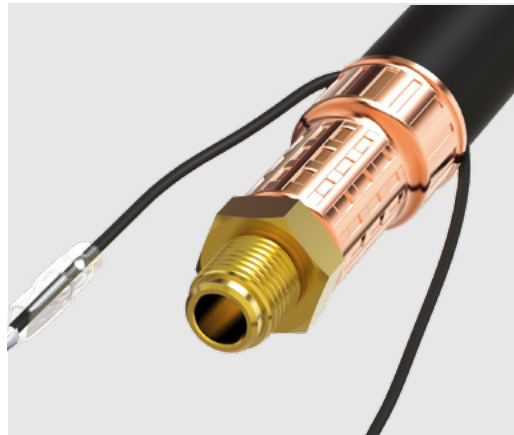

Terminations

- Terminations available in Euro and direct plug options
- The Euro body has been redesigned to improve gas seal integrity in Argon applications
- Our spring pins – often copied,, can't be beaten

The Smart Way To Buy Welding and Cutting Tools



Duragrip Spool-On Mig/Mag Torch Range

Ratings: 180 Amp to 300 Amp, Mixed Gas



Model

DSP 150A

DSP 240A

Technical Data

Cooling Method	Air-Cooled	Air-Cooled
Rating: CO ₂	180A	220A
Rating: Mixed Gas	150A	200A
Duty Cycle	35%	35%
Wire Size: AL	0.8-1.0	0.8-1.2
Wire Size: Steel	0.8-1.0	0.8-1.0
Motor Voltage	24V and 42V	24V and 42V
Motor Life	1000 Hours	1000 Hours

Order Codes	24V	DSP150A-24-P1-60ER	DSP240A-24-P1-60ER
	42V	DSP150A-42-P1-60ER	DSP240A-42-P1-60ER

Duragrip Spool-On Mig/Mag Torch Range

Ratings: 180 Amp to 300 Amp, Mixed Gas



Model	DSP 250A	DSP 360A
Technical Data		
Cooling Method	Air-Cooled	Air-Cooled
Rating: CO ₂	230A	300A
Rating: Mixed Gas	200A	270A
Duty Cycle	35%	35%
Wire Size: AL	0.8-1.2	0.8-1.2
Wire Size: Steel	0.8-1.0	0.8-1.0
Motor Voltage	24V and 42V	24V and 42V
Motor Life	1000 Hours	1000 Hours

Order Codes	24V	DSP250A-24-P1-60ER	DSP360A-24-P1-60ER
	42V	DSP250A-42-P1-60ER	DSP360A-42-P1-60ER

DSP 150A Duragrip Spool-On Mig/Mag Torch Range

Rating: 180A CO₂, 150A mixed gas, EN60974-7 @ 35% duty cycle. 0.8 to 1.0mm wires

Air-Cooled Mig Welding Torch

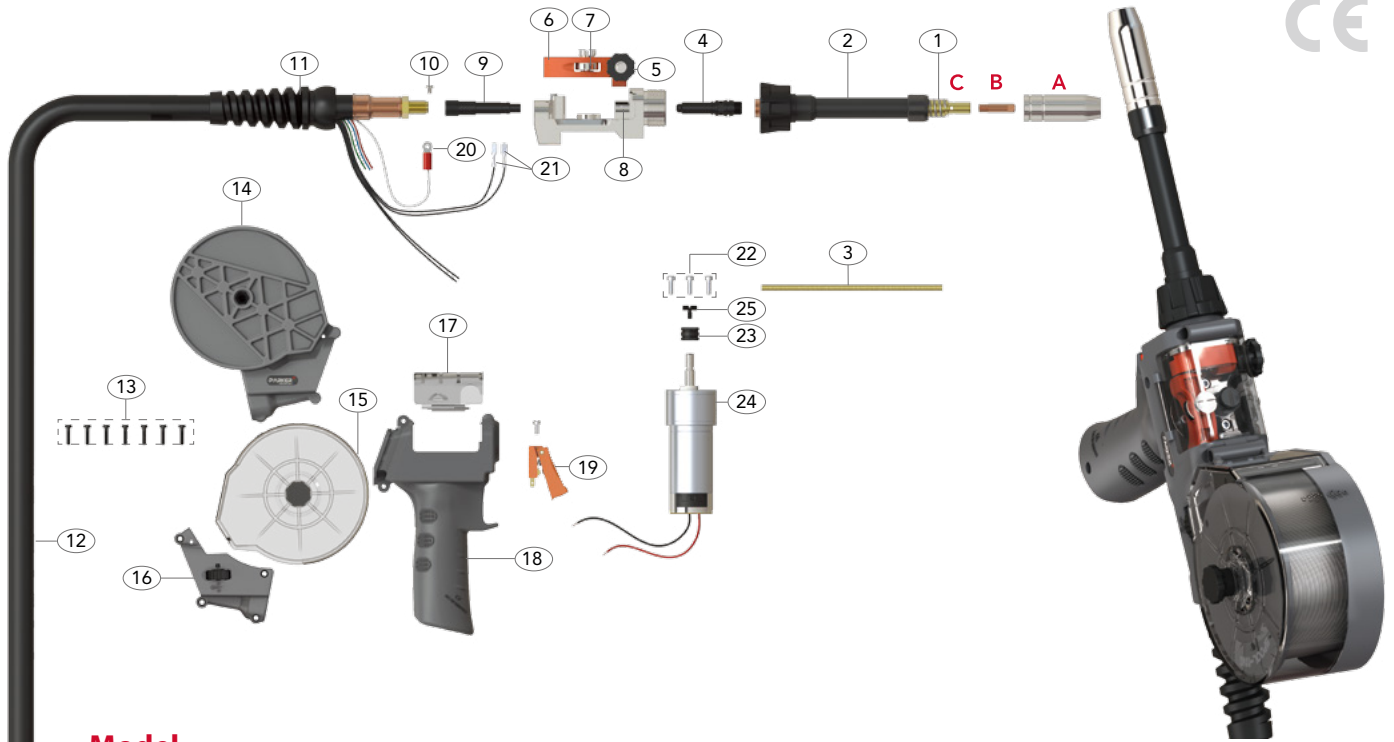

Model

Description	Part No.
	6mt
Spool-On 24V Mig Torch Euro End	DSP150A-24-P1-60ER
Spool-On 42V Mig Torch Euro End	DSP150A-42-P1-60ER
Spool-On 24V Mig Torch Surelok End	DSP150A-24-P1-60DN-GS1
Spool-On 42V Mig Torch Surelok End	DSP150A-42-P1-60DN-GS1

Wear Parts

A Nozzles

Part No.	Description	Wall	Material	Bore
PB1529	Cylindrical Nozzle	0.9mm	Cu	16.0
*PB1530	Conical Nozzle	0.9mm	Cu	12.0
PB1531	Tapered Nozzle	0.9mm	Cu	10.5
PB1532	Bottle Nozzle	0.9mm	Cu	12.8
PB1533	Spot Welding Nozzle	0.9mm	Cu	16.0

C Tip Adaptors

Part No.	Description	Material
*PB1507L/H	Tip Adaptor Left Hand	Brass

B Contact Tips

Part No.	Description	Material	Wire Size
			mm Inch
*PB1527-08	Contact Tip	Cu	0.8 0.030
PB1527-09	Contact Tip	Cu	0.9 0.035
PB1527-10	Contact Tip	Cu	1.0 0.040



*Denotes torch package standard wear part set-up
For more information please refer to the following sections:
• Master Wear Parts Table Page 34-38

DSP 150A Duragrip Spool-On Mig/Mag Torch Range

Rating: 180A CO₂, 150A mixed gas, EN60974-7 @ 35% duty cycle. 0.8 to 1.0mm wires

Air-Cooled Mig Welding Torch



Spare Parts

Part No.	Description
1	PB1504 Shroud Spring
2	PSP1501 Straight Neck Assembly
3	PSP1502 Jump Liner
4	PGP36006 Jump Liner Nipple
5	PGP36402B Tension Knob
6	PGP36402 Pressure Arm Assembly
7	PGP36402R Pressure Roll
8	PSP36001 Motor Body
9	PSP36006 Wire Guide
10	SCP2563 Screw
11	PMIG8015 Cable Support
12	DSP1517-60ER Coax Cable Assembly Euro Type
	DSP1517-60DN Coax Cable Assembly Dinse Type
13	PKA3X20 Handle Screw Pack
14	PSP2515SP-B Spool Holder
15	PSP2515SP-C Spool Cover
16	PSP2515SP-PT-1K Wire Speed Control 1K Ω
	PSP2515SP-PT-5K Wire Speed Control 5K Ω
	PSP2515SP-PT-10K Wire Speed Control 10K Ω
	PSP2515SP-PT-25K Wire Speed Control 25K Ω
	PSP2515SP-PT0 No Potentiometer

Part No.	Description
17	PGP2514-C Push-Pull Handle Cover
18	PCSP2515-KJ Spool-On Handle
19	PGP2516 Push-Pull Trigger
20	SCP2597 Circular Cable Terminal
21	PB1521 Cable Terminal
22	PGPMS1 Motor Screw Pack
23*	SGP7020W-08 Drive Roll For Steel Wire ϕ 0.8
	SGP7020W-09 Drive Roll For Steel Wire ϕ 0.9
	SGP7020W-10 Drive Roll For Steel Wire ϕ 1.0
	SGP7020W-08U Drive Roll For Al Wire ϕ 0.8
	SGP7020W-09U Drive Roll For Al Wire ϕ 0.9
	SGP7020W-10U Drive Roll For Al Wire ϕ 1.0
24	SGP7020-24 Motor 24V DC
	SGP7020-42 Motor 42V DC
25	PGP7020-24-4 Screw

DSP 240A Duragrip Spool-On Mig/Mag Torch Range

Rating: 220A CO₂, 200A mixed gas, EN60974-7 @ 35% duty cycle. 0.8 to 1.2mm wires

Air-Cooled Mig Welding Torch

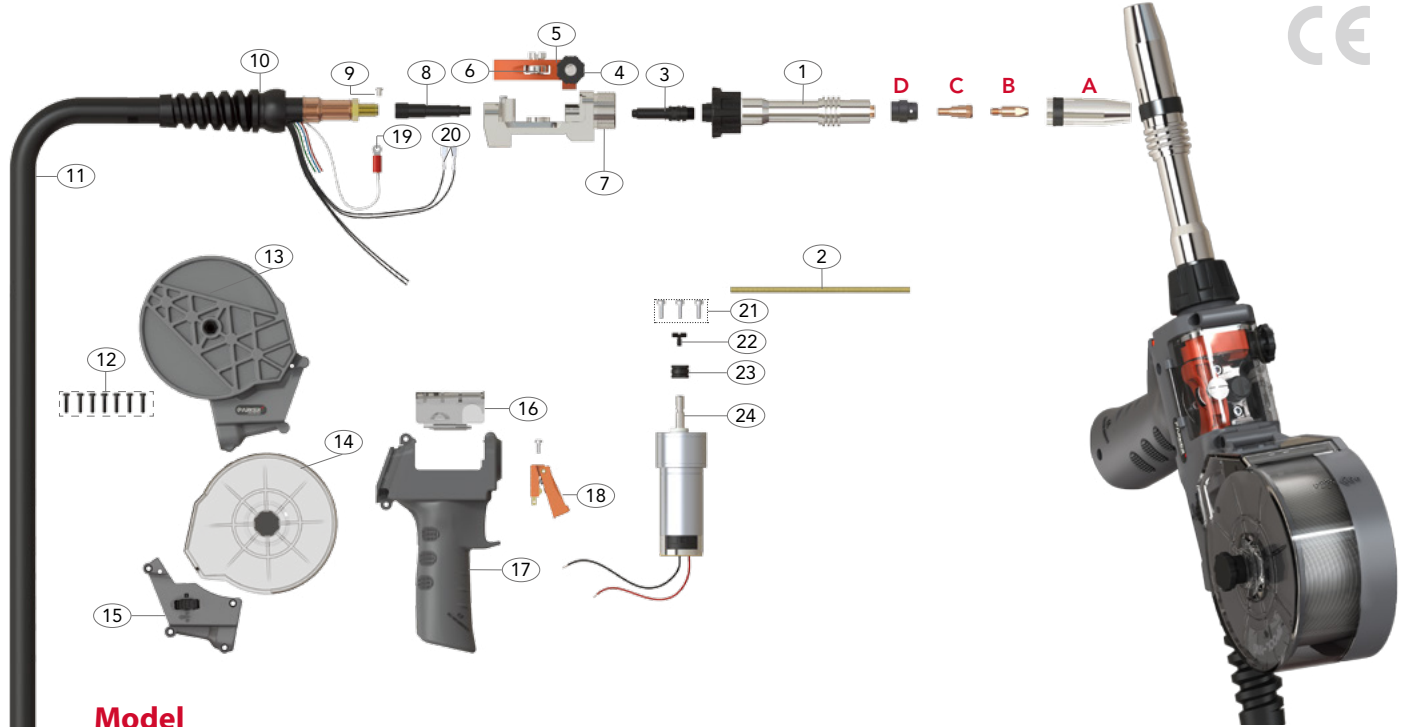

Model

	Part No.
	6mt
Spool-On 24V Mig Torch Euro End	DSP240A-24-P1-60ER
Spool-On 42V Mig Torch Euro End	DSP240A-42-P1-60ER
Spool-On 24V Mig Torch Surelok End	DSP240A-24-P1-60DN-GS1
Spool-On 42V Mig Torch Surelok End	DSP240A-42-P1-60DN-GS1

Wear Parts

A Nozzles

Part No.	Description	Wall	Material	Bore
PB2415	Cylindrical Nozzle	1.40mm	Cu	17.2
*PB2416	Conical Nozzle	1.40mm	Cu	12.6
PB2417	Tapered Nozzle	1.40mm	Cu	10.0

B Contact Tips

Part No.	Description	Material	Wire Size	mm	Inch
PB2504-08	Contact Tip	Cu	0.8	0.030	
PB2504-09	Contact Tip	Cu	0.9	0.035	
PB2504-10	Contact Tip	Cu	1.0	0.040	
PB2504-12	Contact Tip	Cu	1.2	0.045	
*PB2504-10A	Contact Tip	Cu	1.0	0.040	
PB2505-08	Contact Tip	CuCrZr	0.8	0.030	
PB2505-09	Contact Tip	CuCrZr	0.9	0.035	
PB2505-10	Contact Tip	CuCrZr	1.0	0.040	
PB2505-10A	Contact Tip	CuCrZr	1.0	0.040	
PB2505-12A	Contact Tip	CuCrZr	1.2	0.045	

C Tip Adaptors

Part No.	Description	Material
*PB2412	Tip Adaptor	Brass

D Diffusers

Part No.	Description	Material	Colour
*PB2405B	Diffuser	DMC3	Black
PB2405C	Diffuser	Ceramic	White
PB2405W	Diffuser	DMC3	White
PB2405S	Diffuser	Silicon	Red



*Denotes torch package standard wear part set-up
For more information please refer to the following sections:
• Master Wear Parts Table Page 34-38

DSP 240A Duragrip Spool-On Mig/Mag Torch Range

Rating: 220A CO₂, 200A mixed gas, EN60974-7 @ 35% duty cycle. 0.8 to 1.2mm wires

Air-Cooled Mig Welding Torch



Spare Parts

Part No.	Description
1	PSP2401A Straight Neck Assembly
2	PGP3602A Jump Liner
3	PGP36006 Jump Liner Nipple
4	PGP36402B Tension Knob
5	PGP36402 Pressure Arm Assembly
6	PGP36402R Pressure Roll
7	PSP36001 Motor Body
8	PSP36006 Wire Guide
9	SCP2563 Screw
10	PMIG8015 Cable Support
11	DSP2403-60ER Coax Cable Assembly, Euro Type
	DSP2403-60DN Coax Cable Assembly, Dinse Type
12	PKA3X20 Handle Screw Pack
13	PSP2515SP-B Spool Holder
14	PSP2515SP-C Spool Cover
15	PSP2515SP-PT-1K Wire Speed Control 1K Ω
	PSP2515SP-PT-5K Wire Speed Control 5K Ω
	PSP2515SP-PT-10K Wire Speed Control 10K Ω
	PSP2515SP-PT-25K Wire Speed Control 25K Ω
	PSP2515SP-PT0 No Potentiometer

Part No.	Description
16	PGP2514-C Push-Pull Handle Cover
17	PCSP2515-KJ Spool-On Handle
18	PGP2516 Push-Pull Trigger
19	SCP2597 Circular Cable Terminal
20	PB1521 Cable Terminal
21	PGPMS1 Motor Screw Pack
22	PGP7020-24-4 Screw
23	SGP7020W-08 Drive Roll For Steel Wire ϕ 0.8
	SGP7020W-09 Drive Roll For Steel Wire ϕ 0.9
	SGP7020W-10 Drive Roll For Steel Wire ϕ 1.0
	SGP7020W-08U Drive Roll For Al Wire ϕ 0.8
	SGP7020W-09U Drive Roll For Al Wire ϕ 0.9
	*SGP7020W-10U Drive Roll For Al Wire ϕ 1.0
	SGP7020W-12U Drive Roll For Al Wire ϕ 1.2
24	SGP7020-24 Motor 24V DC
	SGP7020-42 Motor 42V DC

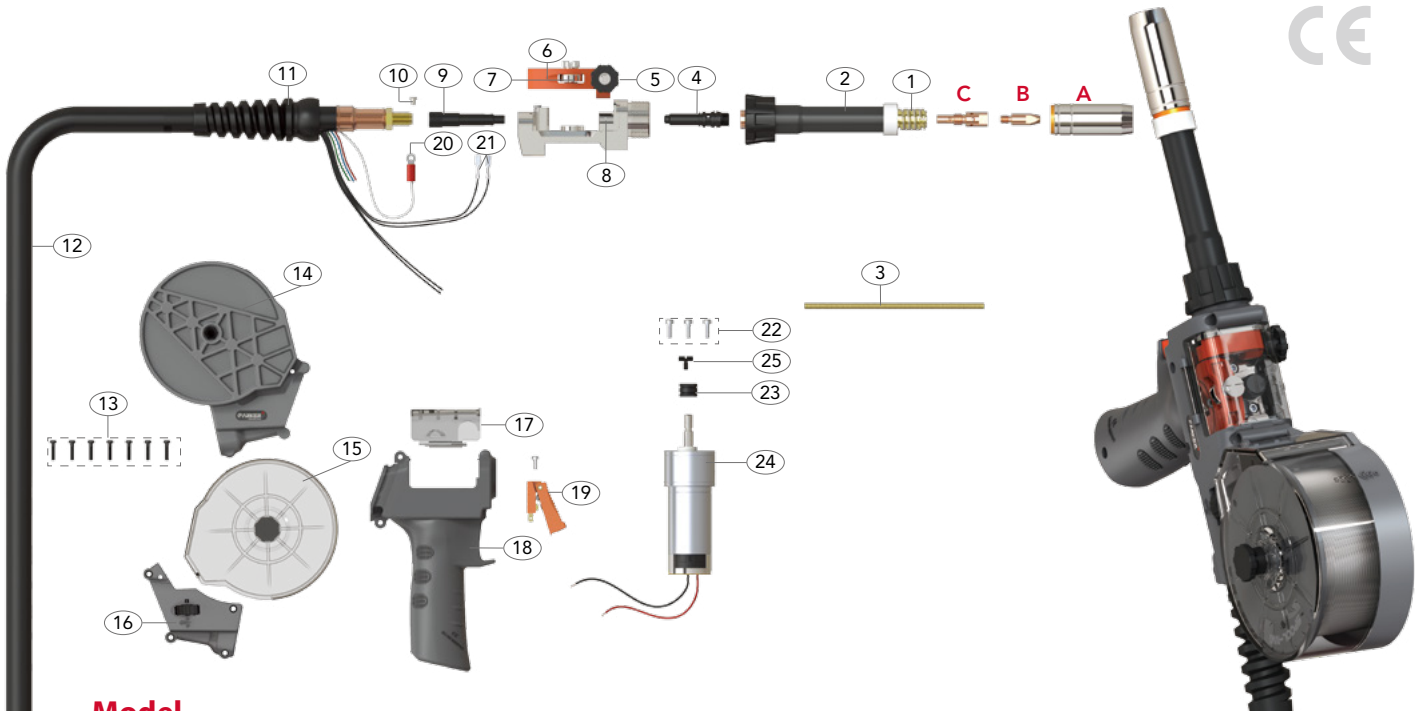

Model

Description	Part No.
	6mt
Spool-On 24V Mig Torch Euro End	DSP250A-24-60ER
Spool-On 42V Mig Torch Euro End	DSP250A-42-60ER
Spool-On 24V Mig Torch Euro End	DSP250A-24-P1-60ER
Spool-On 42V Mig Torch Euro End	DSP250A-42-P1-60ER
Spool-On 24V Mig Torch Surelok End	DSP250A-24-P1-60DN-GS1
Spool-On 42V Mig Torch Surelok End	DSP250A-42-P1-60DN-GS1

Wear Parts

A Nozzles

Part No.	Description	Wall	Material	Bore
PB2507	Cylindrical Nozzle	1.5mm	Cu	18.0
*PB2508	Conical Nozzle	1.5mm	Cu	15.0
PB2509	Tapered Nozzle	1.5mm	Cu	12.0

C Tip Adaptors

Part No.	Description	Material
*PB2506	Tip Adaptor	Brass
PB2536	Tip Adaptor M8	Brass

B Contact Tips

Part No.	Description	Material	Wire Size	
			mm	Inch
PB2504-08	Contact Tip	Cu	0.8	0.030
PB2504-09	Contact Tip	Cu	0.9	0.035
PB2504-10	Contact Tip	Cu	1.0	0.040
PB2504-12	Contact Tip	Cu	1.2	0.045
*PB2504-10A	Contact Tip	Cu	1.0	0.040
PB2505-08	Contact Tip	CuCrZr	0.8	0.030
PB2505-09	Contact Tip	CuCrZr	0.9	0.035
PB2505-10	Contact Tip	CuCrZr	1.0	0.040
PB2505-10A	Contact Tip	CuCrZr	1.0	0.040
PB2505-12A	Contact Tip	CuCrZr	1.2	0.045



*Denotes torch package standard wear part set-up
For more information please refer to the following sections:
• Master Wear Parts Table Page 34-38

DSP 250A Duragrip Spool-On Mig/Mag Torch Range

Rating: 230A CO₂, 200A mixed gas, EN60974-7 @ 35% duty cycle. 0.8 to 1.2mm wires

Air-Cooled Mig Welding Torch



Spare Parts

Part No.	Description
1	PB2502 Shroud Spring
2	PSP2501 Straight Neck Assembly
3	PGP3602A Jump Liner
4	PGP36006 Jump Liner Nipple
5	PGP36402B Tension Knob
6	PGP36402 Pressure Arm Assembly
7	PGP36402R Pressure Roll
8	PSP36001 Motor Body
9	PSP36006 Wire Guide
10	SCP2563 Screw
11	PMIG8015 Cable Support
12	DSP2503-60ER Coax Cable Assembly Euro Type
	DSP2503-60DN Coax Cable Assembly Dinse Type
13	PKA3X20 Handle Screw Pack
14	PSP2515SP-B Spool Holder
15	PSP2515SP-C Spool Cover
16	PSP2515SP-PT-1K Wire Speed Control 1K Ω
	PSP2515SP-PT-5K Wire Speed Control 5K Ω
	PSP2515SP-PT-10K Wire Speed Control 10K Ω
	PSP2515SP-PT-25K Wire Speed Control 25K Ω
	PSP2515SP-PT0 No Potentiometer

Part No.	Description
17	PGP2514-C Push-Pull Handle Cover
18	PCSP2515-KJ Spool-On Handle
19	PGP2516 Push-Pull Trigger
20	SCP2597 Circular Cable Terminal
21	PM1521 Cable Terminal
22	PGPMS1 Motor Screw Pack
23	SGP7020W-08 Drive Roll For Steel Wire ϕ 0.8
	SGP7020W-09 Drive Roll For Steel Wire ϕ 0.9
	SGP7020W-10 Drive Roll For Steel Wire ϕ 1.0
	SGP7020W-08U Drive Roll For Al Wire ϕ 0.8
	SGP7020W-09U Drive Roll For Al Wire ϕ 0.9
	*SGP7020W-10U Drive Roll For Al Wire ϕ 1.0
	SGP7020W-12U Drive Roll For Al Wire ϕ 1.2
24	SGP7020-24 Motor 24V DC
	SGP7020-42 Motor 42V DC
25	PGP7020-24-4 Screw

DSP 360A Duragrip Spool-On Mig/Mag Torch Range

Rating: 300A CO₂, 270A mixed gas, EN60974-7 @ 35% duty cycle. 0.8 to 1.2mm wires

Air-Cooled Mig Welding Torch

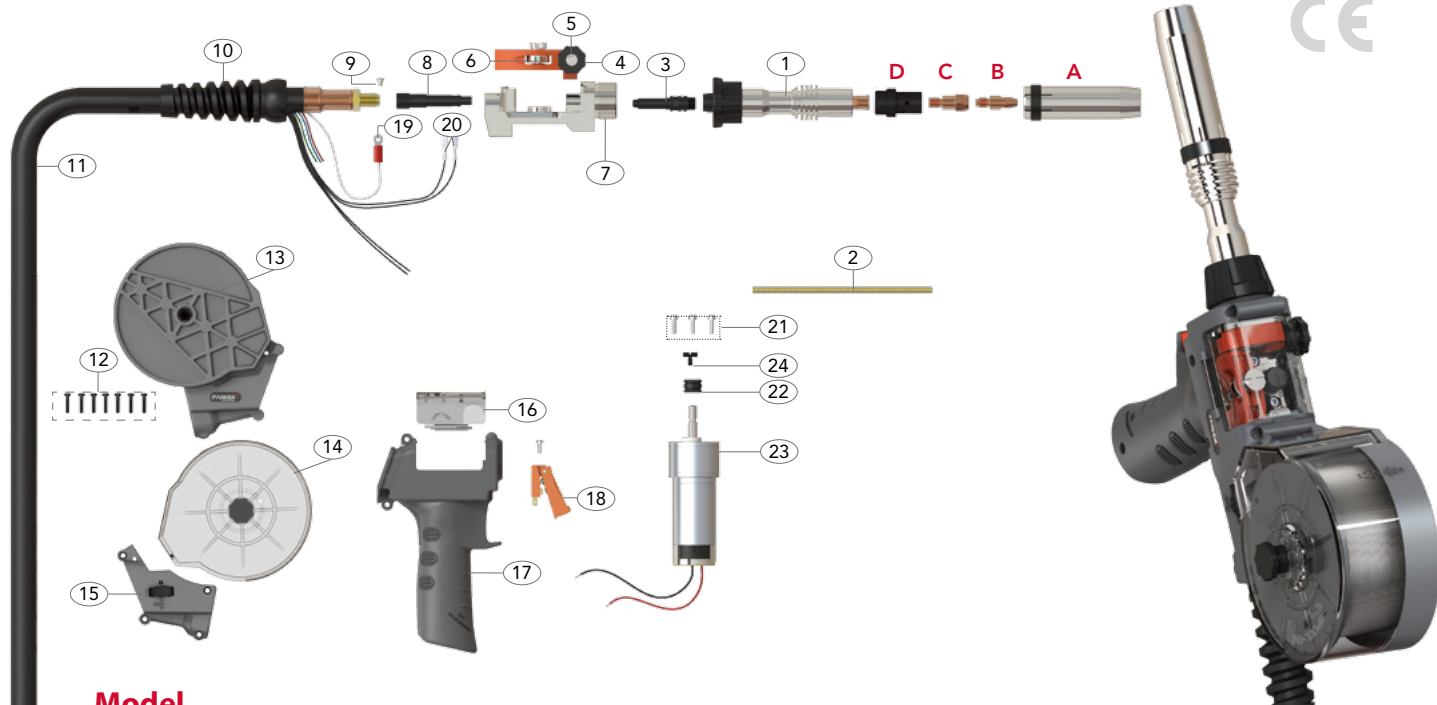

Model

Description	Part No.
	6mt
Spool-On 24V Mig Torch Euro End	DSP360A-24-P1-60ER
Spool-On 42V Mig Torch Euro End	DSP360A-42-P1-60ER
Spool-On 24V Mig Torch Surelok End	DSP360A-24-P1-60DN-GS1
Spool-On 42V Mig Torch Surelok End	DSP360A-42-P1-60DN-GS1

Wear Parts

A Nozzles

Part No.	Description	Wall	Material	Bore
PB3615	Cylindrical Nozzle	2.25mm	Cu	19.0
*PB3616	Conical Nozzle	2.25mm	Cu	16.1
PB3617	Tapered Nozzle	2.25mm	Cu	12.0

C Tip Adaptors

Part No.	Description	Material
PB3612	Tip Adaptor	Brass
PB3613	Tip Adaptor	Brass
*PB3614	Tip Adaptor	Brass

B Contact Tips

Part No.	Description	Material	Wire Size
			mm Inch
PB4014-08	Contact Tip	Cu	0.8 0.030
PB4014-09	Contact Tip	Cu	0.9 0.035
PB4014-10	Contact Tip	Cu	1.0 0.040
*PB4014-10A	Contact Tip	Cu	1.0 0.040
PB4014-12A	Contact Tip	Cu	1.2 0.045
PB4015-08	Contact Tip	CuCrZr	0.8 0.030
PB4015-09	Contact Tip	CuCrZr	0.9 0.035
PB4015-10	Contact Tip	CuCrZr	1.0 0.040
PB4015-10A	Contact Tip	CuCrZr	1.0 0.040
PB4015-12A	Contact Tip	CuCrZr	1.2 0.045

D Diffusers

Part No.	Description	Material	Colour
*PB3605B	Diffuser	DMC3	Black
PB3605C	Diffuser	Ceramic	White
PB3605W	Diffuser	DMC3	White

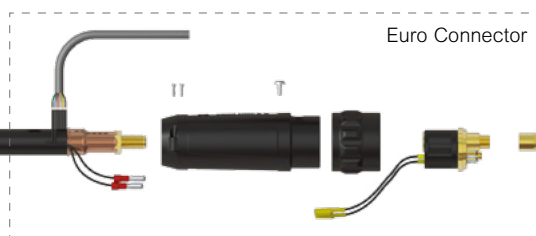

*Denotes torch package standard wear part set-up
For more information please refer to the following sections:
• Master Wear Parts Table Page 34-38

DSP 360A Duragrip Spool-On Mig/Mag Torch Range

Rating: 300A CO₂, 270A mixed gas, EN60974-7 @ 35% duty cycle. 0.8 to 1.2mm wires

Air-Cooled Mig Welding Torch



Spare Parts

Part No.	Description
1	SGP3603A Straight Neck Assembly
2	PGP3602A Jump Liner
3	PGP36006 Jump Liner Nipple
4	PGP36402B Tension Knob
5	PGP36402 Pressure Arm Assembly
6	PGP36402R Pressure Roll
7	PSP36001 Motor Body
8	PSP36006 Wire Guide
9	SCP2563 Screw
10	PMIG8015 Cable Support
11	DSP3617-60ER Coax Cable Assembly Euro Type
	DSP3617-60DN Coax Cable Assembly Dinse Type
12	PKA3X20 Handle Screw Pack
13	PSP2515SP-B Spool Holder
14	PSP2515SP-C Spool Cover
15	PSP2515SP-PT-1K Wire Speed Control 1K Ω
	PSP2515SP-PT-5K Wire Speed Control 5K Ω
	PSP2515SP-PT-10K Wire Speed Control 10K Ω
	PSP2515SP-PT-25K Wire Speed Control 25K Ω

Part No.	Description
16	PGP2514-C Push-Pull Handle Cover
17	PCSP2515-KJ Spool-On Handle
18	PGP2516 Push-Pull Trigger
19	SCP2597 Circular Cable Terminal
20	PB1521 Cable Terminal
21	PGPMS1 Motor Screw Pack
22	SGP7020W-08 Drive Roll For Steel Wire φ 0.8
	SGP7020W-09 Drive Roll For Steel Wire φ 0.9
	SGP7020W-10 Drive Roll For Steel Wire φ 1.0
	SGP7020W-08U Drive Roll For Al Wire φ 0.8
	SGP7020W-09U Drive Roll For Al Wire φ 0.9
	*SGP7020W-10U Drive Roll For Al Wire φ 1.0
	SGP7020W-12U Drive Roll For Al Wire φ 1.2
23	SGP7020-24 Motor 24V DC
	SGP7020-42 Motor 42V DC
24	PGP7020-24-4 Screw

Contents

Suregrip Pull-Mig/Mag Torch Range Features Focus	20
Suregrip Pull-Mig/Mag Torch Range Overview and Ratings	24

Torch Range

Air-Cooled	Suregrip Pull-Mig/Mag SGP 240A	26
	Suregrip Pull-Mig/Mag SGP 360A	28
Liquid-Cooled	Suregrip Pull-Mig/Mag SGP 240W	30
	Suregrip Pull-Mig/Mag SGP 401W	32

Wear Parts

Nozzles	35
Contact Tips	37
Tip Adaptors	39
Diffusers	39
Liners	40

Suregrip Pull-Mig/Mag Gun Range

Air-Cooled Features Focus

Air-Cooled

A motorized on torch feed system for long distances and precise control of soft wires.

Welding Tools for the Professional



100% Binzel® Wear Parts Compatibility Guaranteed

Quality Wear Parts

All wear parts are manufactured to the same specification as the original manufacturer ensuring reliability, longevity and superior performance

- The same wear parts are utilized as standard BZL ranges minimizing stock handling
- Contact tips are manufactured using high quality copper alloys
- High-performance tip adaptors, diffusers and swan necks

Ergonomics – For Comfort and Handleability

Every detail has been considered to ensure the welder has the very best handling

- Large surface area soft grips for improved balance and positionability
- The addition of a knuckle joint enables small movements of the handle and neck independently of the cable assembly
- Cable supports are designed to combine flexibility with smooth and consistent wire feed



Superior Visibility

Functionality and ease of access

- Quick and easy referencing of all moving parts
- Flip up cover enables rapid access for wire changes minimizing downtime

Features Focus

World Class Welding Performance



Speed Control / Tension

Optional wire feed regulation

- Consistent and problem-free wire feeding
- Quick and easy feed roller pressure regulated precisely and easily directly on the handle
- Variable speed control at the handle
- Transparent window for quick and easy reference to all moving parts
- 24V or 42V Feed Motors

Ease of Maintenance

Functionality and ease of repair

- Screwless design solutions and Euro housing sets ensure minimum downtime and productivity – No tools required!
- Euro bodies utilize the industry standard (thanks to us!) spring pins



The Smart Way To Buy Welding and Cutting Tools



Suregrip Pull-Mig/Mag Gun Range

Liquid-Cooled Features Focus

Liquid-Cooled

A motorized on torch feed system for long distances and precise control of soft wires.

Welding Tools for the Professional



100% Binzel® Wear Parts Compatibility Guaranteed

Premium Performance Wear Parts

All front-end wear parts are manufactured to improve current transfer and increase component longevity and ensure superior performance

- Contact tips are manufactured from premium grade copper alloys; we don't sacrifice performance by using low end or recycled raw materials
- Optional high conductivity tip adaptors and heavy duty diffusers are available

Swan Necks

Engineered For Extended Service Life

- Chrome plated nozzle seat provides extra durability
- Tip adaptor seats produced from a special grade copper alloy for increased service life

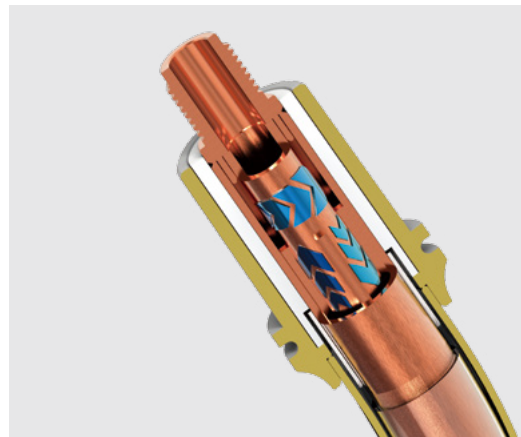

Ergonomics – For Comfort and Handleability

Every detail has been considered to ensure the welder has the very best handling

- Large surface area soft grips for improved balance and positionability
- The addition of a knuckle joint enables small movements of the handle and neck independently of the cable assembly
- Cable supports are designed to combine flexibility with smooth and consistent wire feed

Features Focus

World Class Welding Performance



Speed Control / Tension

Optional wire feed regulation

- Consistent and problem-free wire feeding
- Quick and easy feed roller pressure regulated precisely and easily directly on the handle
- Variable speed control at the handle
- Transparent window for quick and easy reference to all moving parts
- 24V or 42V Feed Motors



Superior Flexibility and Durability

Hydroflex cable systems

- Cable set materials enhanced to increase service life
- High grade outer liner material prolongs flex life, over 1 million flexes in tests
- The copper conductor is coated to prevent premature corrosion from poor quality water and coolant additives



The Smart Way To Buy Welding and Cutting Tools



Suregrip Pull-Mig/Mag Torch Range

Ratings: 220 Amp to 350 Amp, Mixed Gas



Model	SGP 240A	SGP 360A
Technical Data		
Cooling Method	Air-Cooled	Air-Cooled
Rating: CO ₂	250A	300A
Rating: Mixed Gas	220A	270A
Duty Cycle	60%	60%
Wire Size:	0.8-1.2	0.8-1.2
Motor Voltage	24V and 42V	24V and 42V
Motor Life	3000 Hours	3000 Hours
Minimum Water Flow	-	-
Minimum Water Inlet Pressure	-	-
Minimum Cooling Requirements	-	-
Maximum Water Inlet Pressure	-	-
Maximum Water Inlet Temperature	-	-
Order Codes		
	8mt	
	SGP2400-42-A180-80ER	SGP3600-42-A45-80ER
		SGP3600-42-A180-80ER

Suregrip Pull-Mig/Mag Torch Range

Ratings: 220 Amp to 350 Amp, Mixed Gas



Model	SGP 240W	SGP 401W
-------	----------	----------

Technical Data

Cooling Method	Liquid-Cooled	Liquid-Cooled
Rating: CO ₂	270A	400A
Rating: Mixed Gas	240A	350A
Duty Cycle	100%	100%
Wire Size:	0.8-1.2	1.0-1.6
Motor Voltage	24V and 42V	24V and 42V
Motor Life	3000 Hours	3000 Hours
Minimum Water Flow	1.2 l/min	1.2 l/min
Minimum Water Inlet Pressure	2.0Bar	2.0Bar
Minimum Cooling Requirements	1100W	1600W
Maximum Water Inlet Pressure	5.0Bar	5.0Bar
Maximum Water Inlet Temperature	50°C	50°C

Order Codes	8mt	SGP2400W-42-W45-80ER	SGP4001-42-W45-80ER
		SGP2400W-42-W180-80ER	SGP4001-42-W180-80ER

SGP 240A Suregrip Pull-Mig/Mag Torch Range

Rating: 250A CO₂, 220A mixed gas, EN60974-7 @ 60% duty cycle. 0.8 to 1.2mm wires

Air-Cooled Mig Welding Torch

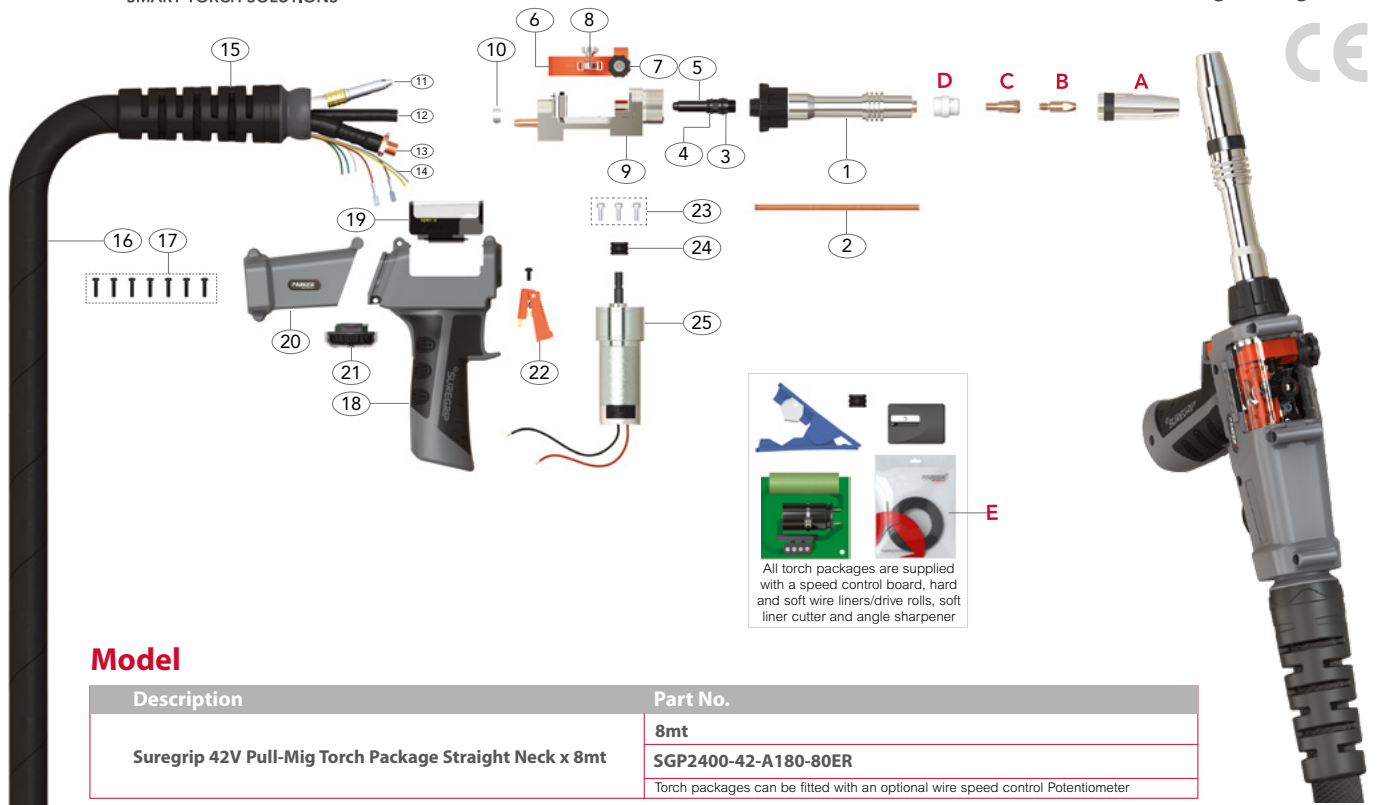

Model

Description	Part No.
Suregrip 42V Pull-Mig Torch Package Straight Neck x 8mt	8mt SGP2400-42-A180-80ER
	Torch packages can be fitted with an optional wire speed control Potentiometer

Wear Parts

A Nozzles

Part No.	Description	Bore	Wall	Material
PB2415	Cylindrical Nozzle	17.2	1.40mm	Cu
*PB2416	Conical Nozzle	12.6	1.40mm	Cu
PB2417	Tapered Nozzle	10.0	1.40mm	Cu

B Contact Tips

Part No.	Description	Material	Wire Size	
			mm	Inch
PB2504-09	Contact Tip	Cu	0.9	0.035
PB2504-10	Contact Tip	Cu	1.0	0.040
PB2504-12	Contact Tip	Cu	1.2	0.045
PB2504-10A	Contact Tip	Cu	1.0	0.040
*PB2504-12A	Contact Tip	Cu	1.2	0.045
PB2505-08	Contact Tip	CuCrZr	0.8	0.030
PB2505-10	Contact Tip	CuCrZr	1.0	0.040
PB2505-12	Contact Tip	CuCrZr	1.2	0.045
PB2505-12A	Contact Tip	CuCrZr	1.2	0.045

C Tip Adaptors

Part No.	Description	Material
*PB2412	Tip Adaptor	Brass

D Diffusers

Part No.	Description	Colour	Material
PB2405B	Diffuser	Black	DMC3
*PB2405C	Diffuser	White	Ceramic
PB2405W	Diffuser	White	DMC3
PB2405S	Diffuser	Red	Silicon

E Liner

Part No.	Description	Length	Wire Size
*PB2564-80	Polyamide Liner x 8mt	8.6mt	1.2-1.6 mm

Cable Parts

Description	Part No.
	8mt
11 Outer Liner Assembly	PGP3608-80
12 Gas Hose Assembly	PGP36413-80
13 Power Cable Assembly	PGP36015-80
14 Switch Lead Assembly	PGP36410-80

*Denotes torch package standard wear part set-up
For more information please refer to the following sections:
•Master Wear Parts Table Page 35-41

SGP 240A Suregrip Pull-Mig/Mag Torch Range

Rating: 250A CO₂, 220A mixed gas, EN60974-7 @ 60% duty cycle. 0.8 to 1.2mm wires

Air-Cooled Mig Welding Torch

Spare Parts

Part No.	Description
1	PSP2401A Straight Neck Assembly
2	PGP3602A Jump Liner
3	9×1.5 O ring
4	7×1.5 O ring
5	PGP36006 Jump Liner Nipple
6	PGP36402 Pressure Arm Assembly
7	PGP36402B Tension Knob
8	PGP36402R Pressure Roll
9	PGP36001 Motor Body
10	PB5041 Water Hose Clamp 8.7mm
15	PGP3208 Handle Cable Support
16	PGP36419-80 Canvas Cover Assembly
17	PKA3X20 Handle Screw Pack
18	PGP2515/KJ Push Pull Handle Assembly
19	PGP2514/C Push Pull Handle Cover
20	PGP2514/C Push Pull Handle Connector Module
21	PGP0807-1 Potentiometer Kit 1K
	PGP0807-5 Potentiometer Kit 5K
	PGP0807-10 Potentiometer Kit 10K
	PGP0807-25 Potentiometer Kit 25K

Part No.	Description
22	PGP2516 Trigger
23	PGPMS1 Motor Screw Pack
24	SGP8224W-08 Drive Roll For Steel Wire ϕ 0.8
	SGP8224W-09 Drive Roll For Steel Wire ϕ 0.9
	SGP8224W-10 Drive Roll For Steel Wire ϕ 1.0
	SGP8224W-12 Drive Roll For Steel Wire ϕ 1.2
	SGP8224W-16 Drive Roll For Steel Wire ϕ 1.6
	SGP8224W-08U Drive Roll For Aluminium Wire ϕ 0.8
	SGP8224W-09U Drive Roll For Aluminium Wire ϕ 0.9
	SGP8224W-10U Drive Roll For Aluminium Wire ϕ 1.0
	*SGP8224W-12U Drive Roll For Aluminium Wire ϕ 1.2
	SGP8224W-16U Drive Roll For Aluminium Wire ϕ 1.6
25	SGP8224-24 Motor 24V DC
	SGP8224-42 Motor 42V DC

SGP 360A Suregrip Pull-Mig/Mag Torch Range

Rating: Long Neck+M8 Tip: 300A CO₂ 270A mixed gas, EN60974-7 @ 60% duty cycle. 0.8 to 1.2mm wires
Short Neck+M8 Tip: 270A CO₂ 250A mixed gas, EN60974-7 @ 60% duty cycle. 0.8 to 1.2mm wires

Air-Cooled Mig Welding Torch

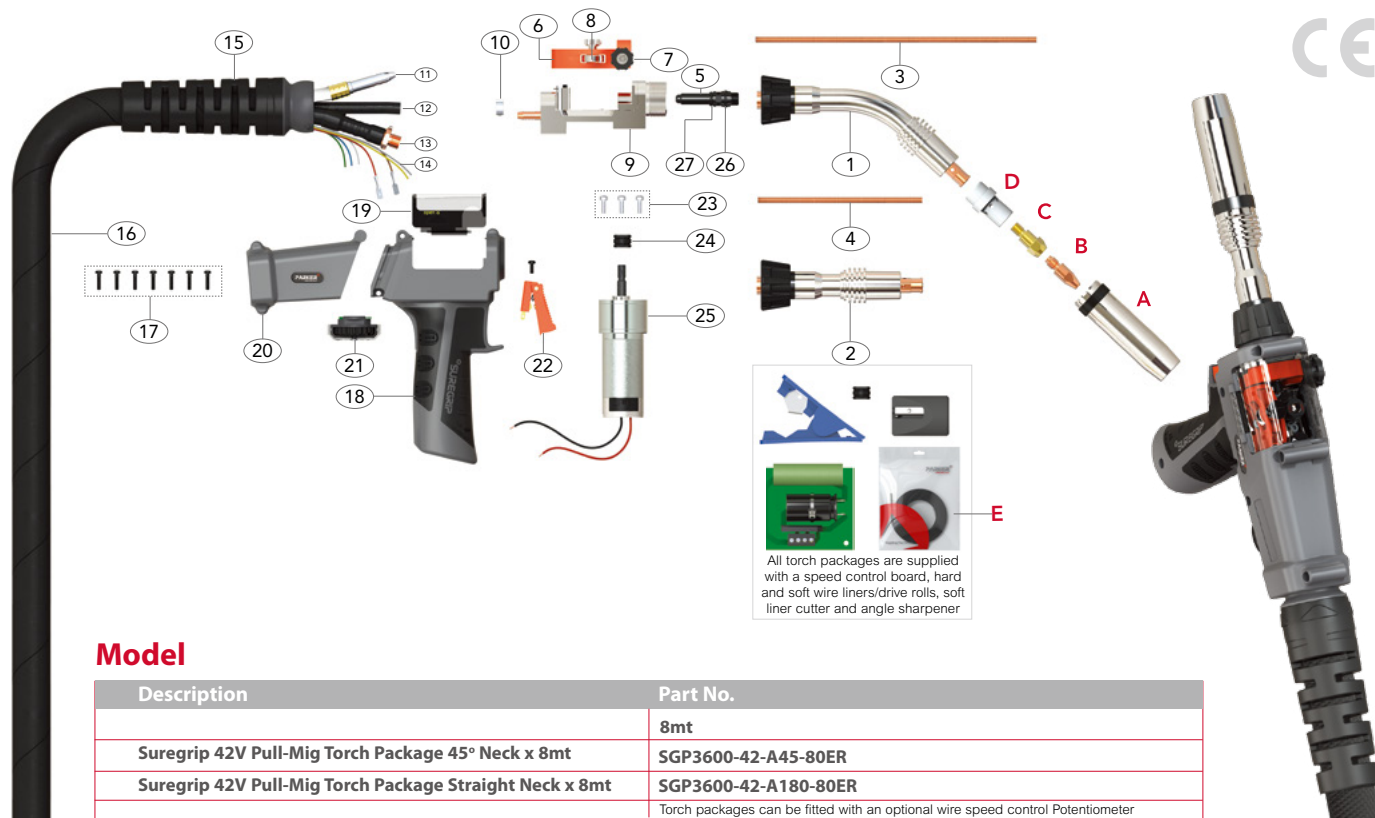

All torch packages are supplied with a speed control board, hard and soft wire liners/driver rolls, soft liner cutter and angle sharpener

Model

Description	Part No.
	8mt
Suregrip 42V Pull-Mig Torch Package 45° Neck x 8mt	SGP3600-42-A45-80ER
Suregrip 42V Pull-Mig Torch Package Straight Neck x 8mt	SGP3600-42-A180-80ER

Torch packages can be fitted with an optional wire speed control Potentiometer

Wear Parts

A Nozzles				
Part No.	Description	Bore	Wall	Material
PB3615	Cylindrical Nozzle	19.0	2.25mm	Cu
*PB3616	Conical Nozzle	16.1	2.25mm	Cu
PB3617	Tapered Nozzle	12.0	2.25mm	Cu

B Contact Tips				
Part No.	Description	Material	Wire Size	
			mm	Inch
PB2504-08	Contact Tip	Cu	0.8	0.030
PB2504-10	Contact Tip	Cu	1.0	0.040
PB2504-12	Contact Tip	Cu	1.2	0.045
PB2504-10A	Contact Tip	Cu	1.0	0.040
PB4014-08	Contact Tip	Cu	0.8	0.030
PB4014-10	Contact Tip	Cu	1.0	0.040
PB4014-12	Contact Tip	Cu	1.2	0.045
*PB4014-12A	Contact Tip	Cu	1.2	0.045

C Tip Adaptors		
Part No.	Description	Material
PB3612	Tip Adaptor	Brass
PB3613	Tip Adaptor	Brass
*PB3614	Tip Adaptor	Brass

D Diffusers			
Part No.	Description	Colour	Material
PB3605B	Diffuser	Black	DMC3
*PB3605C	Diffuser	White	Ceramic
PB3605W	Diffuser	White	DMC3

E Liner			
Part No.	Description	Length	Wire Size
			mm
*PB2564-80	Polyamide Liner x 8mt	8.6mt	1.2-1.6

Cable Parts

Description	Part No.
	8mt
11 Outer Liner Assembly	PGP3608-80
12 Gas Hose Assembly	PGP36413-80
13 Power Cable Assembly	PGP36015-80
14 Switch Lead Assembly	PGP36410-80

*Denotes torch package standard wear part set-up
For more information please refer to the following sections:
• Master Wear Parts Table Page 35-41



SGP 360A Suregrip Pull-Mig/Mag Torch Range

Rating: Long Neck+M8 Tip: 300A CO₂ 270A mixed gas, EN60974-7 @ 60% duty cycle. 0.8 to 1.2mm wires

Short Neck+M8 Tip: 270A CO₂ 250A mixed gas, EN60974-7 @ 60% duty cycle. 0.8 to 1.2mm wires

Air-Cooled Mig Welding Torch



Spare Parts

Part No.	Description
1	SGP3603 Swan Neck Assembly 45°
2	SGP3603A Straight Neck Assembly
3	PGP3602 Jump Liner
4	PGP3602A Jump Liner
5	PGP36006 Jump Liner Nipple
6	PGP36402 Pressure Arm Assembly
7	PGP36402B Tension Knob
8	PGP36402R Pressure Roll
9	PGP36001 Motor Body
10	PB5041 Water Hose Clamp 8.7mm
15	PGP3208 Handle Cable Support
16	PGP36419-80 Canvas Cover Assembly
17	PKA3X20 Handle Screw Pack
18	PGP2515/KJ Push Pull Handle Assembly
19	PGP2514/C Push Pull Handle Cover
20	PGP2515DM0 Push Pull Handle Connector Module
21	PGP0807-1 Potentiometer Kit 1K
	PGP0807-5 Potentiometer Kit 5K
	PGP0807-10 Potentiometer Kit 10K
	PGP0807-25 Potentiometer Kit 25K

Part No.	Description
22	PGP2516 Trigger
23	PGPMS1 Motor Screw Pack
24	SGP8224W-08 Drive Roll For Steel Wire ϕ 0.8
	SGP8224W-09 Drive Roll For Steel Wire ϕ 0.9
	SGP8224W-10 Drive Roll For Steel Wire ϕ 1.0
	SGP8224W-12 Drive Roll For Steel Wire ϕ 1.2
	SGP8224W-16 Drive Roll For Steel Wire ϕ 1.6
	SGP8224W-08U Drive Roll For Aluminium Wire ϕ 0.8
	SGP8224W-09U Drive Roll For Aluminium Wire ϕ 0.9
	SGP8224W-10U Drive Roll For Aluminium Wire ϕ 1.0
	*SGP8224W-12U Drive Roll For Aluminium Wire ϕ 1.2
	SGP8224W-16U Drive Roll For Aluminium Wire ϕ 1.6
25	SGP8224-24 Motor 24V DC
	SGP8224-42 Motor 42V DC
26	9×1.5 O ring
27	7×1.5 O ring

*Note: Rating: 270A CO₂ 250A mixed gas @60% duty cycle when using SG3603A neck

SGP 240W Suregrip Pull-Mig/Mag Torch Range

Rating: 270A CO₂, 240A mixed gas, EN60974-7 @ 100% duty cycle. 0.8 to 1.2mm wires

Liquid-Cooled Mig Welding Torch

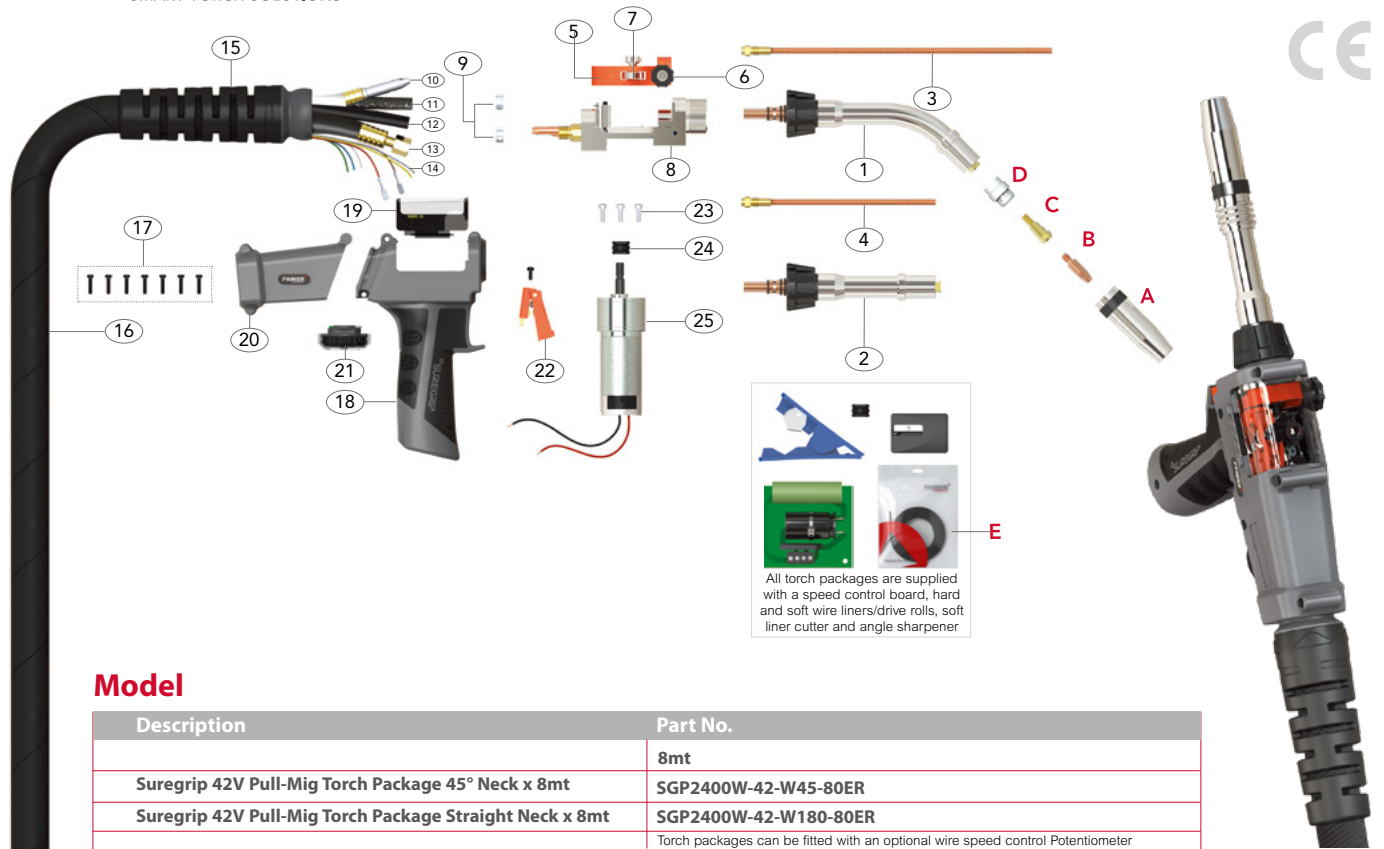

Model

Description	Part No.
	8mt
Suregrip 42V Pull-Mig Torch Package 45° Neck x 8mt	SGP2400W-42-W45-80ER
Suregrip 42V Pull-Mig Torch Package Straight Neck x 8mt	SGP2400W-42-W180-80ER
Torch packages can be fitted with an optional wire speed control Potentiometer	

Wear Parts

A Nozzles

Part No.	Description	Bore	Wall	Material
PB2415	Cylindrical Nozzle	17.2	1.40mm	Cu
*PB2416	Conical Nozzle	12.6	1.40mm	Cu
PB2417	Tapered Nozzle	10.0	1.40mm	Cu

B Contact Tips

Part No.	Description	Material	Wire Size
			mm Inch
PB2504-08	Contact Tip	Cu	0.8 0.030
PB2504-10	Contact Tip	Cu	1.0 0.040
PB2504-12	Contact Tip	Cu	1.2 0.045
*PB2504-12A	Contact Tip	Cu	1.2 0.045

C Tip Adaptors

Part No.	Description	Material
*PB2412	Tip Adaptor	Brass

D Diffusers

Part No.	Description	Colour	Material
PB2405B	Diffuser	Black	DMC3
*PB2405C	Diffuser	White	Ceramic
PB2405W	Diffuser	White	DMC3
PB2405S	Diffuser	Red	Silicon

E Liner

Part No.	Description	Length	Wire Size
			mm
*PB2564-80	Polyamide Liner x 8mt	8.6mt	1.2-1.6

Cable Parts

Description	Part No.
	8mt
10 Outer Liner Assembly	PGP4008-80
11 Gas Hose Assembly	PGP36413-80
12 Water Inlet Hose Assembly	PGP40112-80
13 Power Cable Assembly	PGP40115-80
14 Switch Lead Assembly	PGP36410-80
26 Water Outlet Hose	PS5017

*Denotes torch package standard wear part set-up
For more information please refer to the following sections:
• Master Wear Parts Table Page 35-41

SGP 240W Suregrip Pull-Mig/Mag Torch Range

Rating: 270A CO₂, 240A mixed gas, EN60974-7 @ 100% duty cycle. 0.8 to 1.2mm wires

Liquid-Cooled Mig Welding Torch



Spare Parts

Part No.	Description
1	SGP2409 Swan Neck Assembly 45°
2	SGP2409A Straight Neck Assembly
3	PGP2402 Jump Liner c/w Nipple
4	PGP2402A Jump Liner c/w Nipple
5	PGP36402 Pressure Arm Assembly
6	PGP36402B Tension Knob
7	PGP36402R Pressure Roll
8	PGP40101 Motor Body
9	PB5041 Water Hose Clamp 8.7mm
15	PGP3208 Handle Cable Support
16	PGP36419-80 Canvas Cover Assembly
17	PKA3X20 Handle Screw Pack
18	PGP2515/KJ Push Pull Handle Assembly
19	PGP2514/C Push Pull Handle Cover
20	PGP2515DM0 Push Pull Handle Connector Module
21	PGP0807-1 Potentiometer Kit 1K
	PGP0807-5 Potentiometer Kit 5K
	PGP0807-10 Potentiometer Kit 10K
	PGP0807-25 Potentiometer Kit 25K

Part No.	Description
22	PGP2516 Trigger
23	PGPMS1 Motor Screw Pack
24	SGP8224W-08 Drive Roll For Steel Wire ϕ 0.8
	SGP8224W-09 Drive Roll For Steel Wire ϕ 0.9
	SGP8224W-10 Drive Roll For Steel Wire ϕ 1.0
	SGP8224W-12 Drive Roll For Steel Wire ϕ 1.2
	SGP8224W-16 Drive Roll For Steel Wire ϕ 1.6
	SGP8224W-08U Drive Roll For Aluminium Wire ϕ 0.8
	SGP8224W-09U Drive Roll For Aluminium Wire ϕ 0.9
	SGP8224W-10U Drive Roll For Aluminium Wire ϕ 1.0
	*SGP8224W-12U Drive Roll For Aluminium Wire ϕ 1.2
	SGP8224W-16U Drive Roll For Aluminium Wire ϕ 1.6
25	SGP8224-24 Motor 24V DC
	SGP8224-42 Motor 42V DC

SGP 401W Suregrip Pull-Mig/Mag Torch Range

Rating: 400A CO₂ 350A mixed gas, EN60974-7 @ 100% duty cycle. 1.0 to 1.6mm wires

Liquid-Cooled Mig Welding Torch

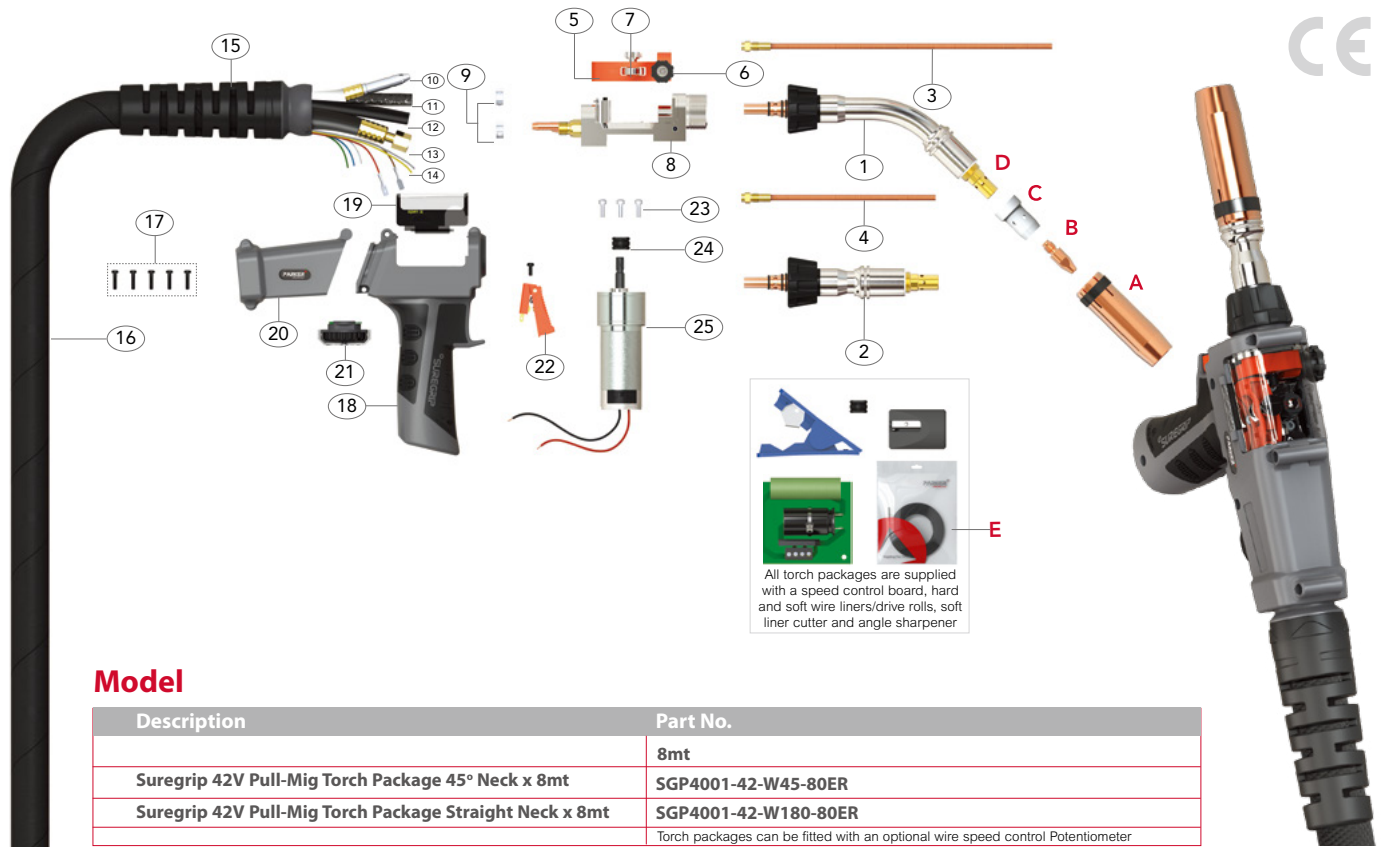

Model

Description	Part No.
	8mt
Suregrip 42V Pull-Mig Torch Package 45° Neck x 8mt	SGP4001-42-W45-80ER
Suregrip 42V Pull-Mig Torch Package Straight Neck x 8mt	SGP4001-42-W180-80ER
Torch packages can be fitted with an optional wire speed control Potentiometer	

Wear Parts

A Nozzles

Part No.	Description	Bore	Wall	Material
PB5027	Cylindrical Nozzle	19.0	2.50mm	Cu
*PB5028	Conical Nozzle	16.0	2.50mm	Cu
PB5028HD	Conical Nozzle	16.0	3.20mm	Cu
PB5029	Tapered Nozzle	14.0	2.50mm	Cu

B Contact Tips

Part No.	Description	Material	Wire Size	
			mm	Inch
PB4014-08	Contact Tip	Cu	0.8	0.030
PB4014-10	Contact Tip	Cu	1.0	0.040
PB4014-12	Contact Tip	Cu	1.2	0.045
*PB4014-12A	Contact Tip	Cu	1.2	0.045

C Diffusers

Part No.	Description	Colour	Material
PB5005B	Diffuser	Black	DMC3
*PB5005C	Diffuser	White	Ceramic
PB5005W	Diffuser	White	DMC3
PB5005H	Diffuser High Performance	Black	HPP

D Tip Adaptors

Part No.	Description	Material
*PB5001	Tip Adaptor	Brass
PB5001C-R	Tip Adaptor	CuCrZr

E Liner

Part No.	Description	Length	Wire Size
			mm
*PB2564-80	Polyamide Liner x 8mt	8.6mt	1.2-1.6

Cable Parts

Description	Part No.
	8mt
10 Outer Liner Assembly	PGP4008-80
11 Gas Hose Assembly	PGP36413-80
12 Water Inlet Hose Assembly	PGP40112-80
13 Power Cable Assembly	PGP40115-80
14 Switch Lead Assembly	PGP36410-80
26 Water Outlet Hose	PS5017

*Denotes torch package standard wear part set-up
For more information please refer to the following sections:
•Master Wear Parts Table Page 35-41

SGP 401W Suregrip Pull-Mig/Mag Torch Range

Rating: 400A CO₂, 350A mixed gas, EN60974-7 @ 100% duty cycle. 1.0 to 1.6mm wires

Liquid-Cooled Mig Welding Torch

Spare Parts

Part No.	Description
1	SGP4011 Swan Neck Assembly 45°
2	SGP4011A Straight Neck Assembly
3	PGP4002 Jump Liner c/w Nipple
4	PGP4002A Jump Liner c/w Nipple
5	PGP36402 Pressure Arm Assembly
6	PGP36402B Tension Knob
7	PGP36402R Pressure Roll
8	PGP40101 Motor Body
9	PB5041 Water Hose Clamp 8.7mm
15	PGP3208 Handle Cable Support
16	PGP36419-80 Canvas Cover Assembly
17	PKA3X20 Handle Screw Pack
18	PGP2515/KJ Push Pull Handle Assembly
19	PGP2514/C Push Pull Handle Cover
20	PGP2515DM0 Push Pull Handle Connector Module
21	PGP0807-1 Potentiometer Kit 1K
	PGP0807-5 Potentiometer Kit 5K
	PGP0807-10 Potentiometer Kit 10K
	PGP0807-25 Potentiometer Kit 25K

Part No.	Description
22	PGP2516 Trigger
23	PGPMS1 Motor Screw Pack
24	SGP8224W-08 Drive Roll For Steel Wire ϕ 0.8
	SGP8224W-09 Drive Roll For Steel Wire ϕ 0.9
	SGP8224W-10 Drive Roll For Steel Wire ϕ 1.0
	SGP8224W-12 Drive Roll For Steel Wire ϕ 1.2
	SGP8224W-16 Drive Roll For Steel Wire ϕ 1.6
	SGP8224W-08U Drive Roll For Aluminium Wire ϕ 0.8
	SGP8224W-09U Drive Roll For Aluminium Wire ϕ 0.9
	SGP8224W-10U Drive Roll For Aluminium Wire ϕ 1.0
	*SGP8224W-12U Drive Roll For Aluminium Wire ϕ 1.2
	SGP8224W-16U Drive Roll For Aluminium Wire ϕ 1.6
25	SGP8224-24 Motor 24V DC
	SGP8224-42 Motor 42V DC

Duragrip Spool-On Nozzles

DSP150A

Part No.	Description	Bore	Wall	Material
PC1530	Conical Nozzle	12.0	0.95mm	Brass
PB1529	Cylindrical Nozzle	16.0	0.9mm	Cu
*PB1530	Conical Nozzle	12.0	0.9mm	Cu
PB1531	Tapered Nozzle	10.5	0.9mm	Cu
PB1532	Bottle Nozzle	12.8	0.9mm	Cu
PB1533	Spot Welding Nozzle	16.0	0.9mm	Cu

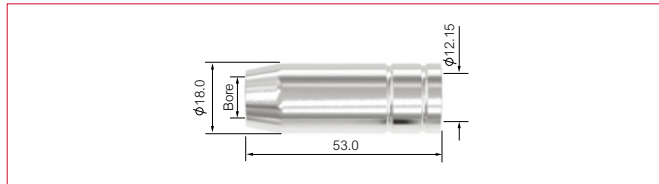

DSP 250A

Part No.	Description	Bore	Wall	Material
PC2507	Cylindrical Nozzle	19.0	1.25mm	Brass
PC2508	Conical Nozzle	15.0	1.25mm	Brass
PC2509	Tapered Nozzle	12.0	1.25mm	Brass
PB2507	Cylindrical Nozzle	18.0	1.5mm	Cu
*PB2508	Conical Nozzle	15.0	1.5mm	Cu
PB2509	Tapered Nozzle	12.0	1.5mm	Cu
PB2510	Bottle Nozzle	14.5	1.5mm	Cu
PB2511	Spot Welding Nozzle	18.0	1.5mm	Cu

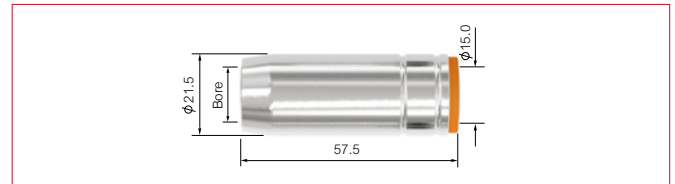

DSP240A

Part No.	Description	Bore	Wall	Material
PB2415	Cylindrical Nozzle	17.2	1.4mm	Cu
*PB2416	Conical Nozzle	12.6	1.4mm	Cu
PB2417	Tapered Nozzle	10.0	1.4mm	Cu

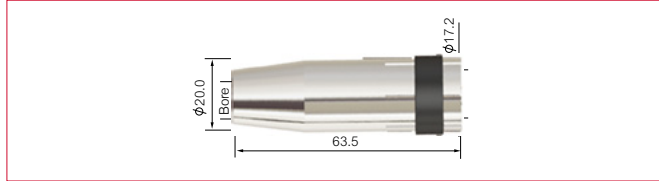

DSP 360A

Part No.	Description	Bore	Wall	Material
PC3615	Cylindrical Nozzle	20.1	1.70mm	Cu
PC3616	Conical Nozzle	16.0	1.70mm	Cu
PC3617	Tapered Nozzle	12.0	1.70mm	Cu
PB3615	Cylindrical Nozzle	19.0	2.25mm	Cu
*PB3616	Conical Nozzle	16.1	2.25mm	Cu
PB3617	Tapered Nozzle	12.0	2.25mm	Cu



* Denotes torch package standard wear part set-up

Suregrip Pull Nozzles

SGP 240A/240W

Part No.	Description	Bore	Wall	Material
PB2415	Cylindrical Nozzle	17.2	1.40mm	Cu
* PB2416	Conical Nozzle	12.6	1.40mm	Cu
PB2417	Tapered Nozzle	10.0	1.40mm	Cu

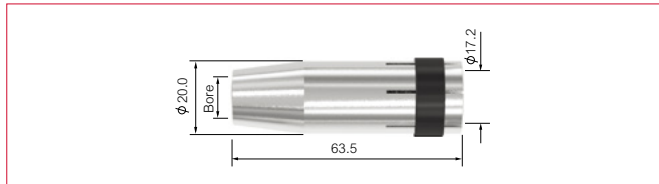

SGP 360A

Part No.	Description	Bore	Wall	Material
PB3615	Cylindrical Nozzle	19.0	2.25mm	Cu
* PB3616	Conical Nozzle	16.1	2.25mm	Cu
PB3617	Tapered Nozzle	12.0	2.25mm	Cu

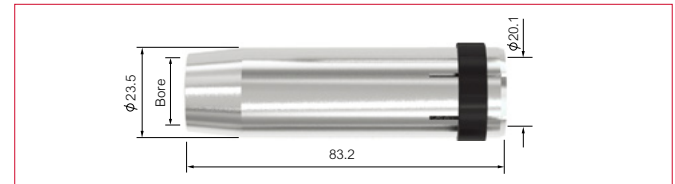

SGP 401W

Part No.	Description	Bore	Wall	Material
PB5027	Cylindrical Nozzle	19.0	2.50mm	Cu
* PB5028	Conical Nozzle	16.0	2.50mm	Cu
PB5028HD	Conical Nozzle	16.0	3.20mm	Cu
PB5029	Tapered Nozzle	14.0	2.50mm	Cu

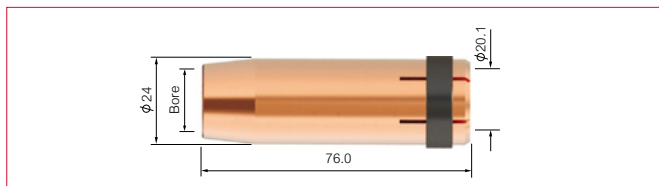

* Denotes torch package standard wear part set-up

Duragrip Spool-On Contact Tips

DSP 150A

Part No.	Description	Material	Wire Size	
			mm	inch
PB1527-06	Contact Tip	Cu	0.6	0.023
*PB1527-08	Contact Tip	Cu	0.8	0.030
PB1527-09	Contact Tip	Cu	0.9	0.035
PB1527-10	Contact Tip	Cu	1.0	0.040
PB1527-08A	Contact Tip	Cu	0.8	0.030
PB1527-09A	Contact Tip	Cu	0.9	0.035
PB1527-10A	Contact Tip	Cu	1.0	0.040

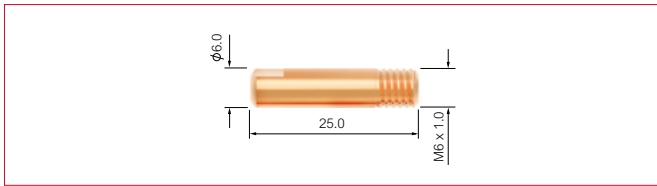

DSP 240A/250A

Part No.	Description	Material	Wire Size	
			mm	inch
PB2504-06	Contact Tip	Cu	0.6	0.023
PB2504-08	Contact Tip	Cu	0.8	0.030
PB2504-09	Contact Tip	Cu	0.9	0.035
PB2504-10	Contact Tip	Cu	1.0	0.040
PB2504-12	Contact Tip	Cu	1.2	0.045
PB2504-14	Contact Tip	Cu	1.4	0.055
PB2504-16	Contact Tip	Cu	1.6	0.063
*PB2504-10A	Contact Tip	Cu	1.0	0.040

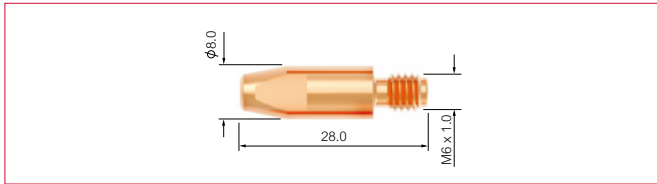

PB2505-08	Contact Tip	CuCrZr	0.8	0.030
PB2505-09	Contact Tip	CuCrZr	0.9	0.035
PB2505-10	Contact Tip	CuCrZr	1.0	0.040
PB2505-10A	Contact Tip	CuCrZr	1.0	0.040
PB2505-12A	Contact Tip	CuCrZr	1.2	0.045

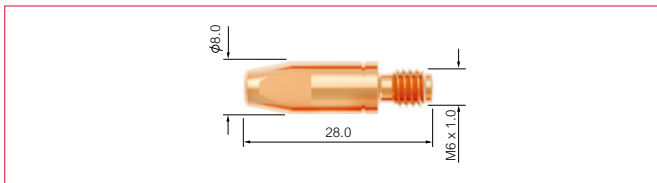

DSP 250A/360A

Part No.	Description	Material	Wire Size	
			mm	inch
PB4014-08	Contact Tip	Cu	0.8	0.030
PB4014-09	Contact Tip	Cu	0.9	0.035
PB4014-10	Contact Tip	Cu	1.0	0.040
*PB4014-10A	Contact Tip	Cu	1.0	0.040
PB4014-12A	Contact Tip	Cu	1.2	0.045

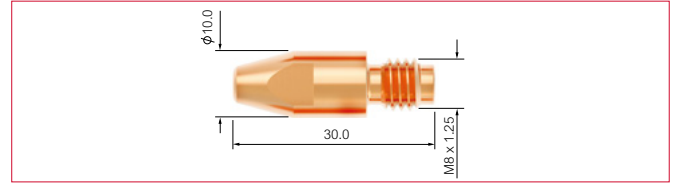

PB4015-08	Contact Tip	CuCrZr	0.8	0.030
PB4015-09	Contact Tip	CuCrZr	0.9	0.035
PB4015-10	Contact Tip	CuCrZr	1.0	0.040
PB4015-10A	Contact Tip	CuCrZr	1.0	0.040
PB4015-12A	Contact Tip	CuCrZr	1.2	0.045

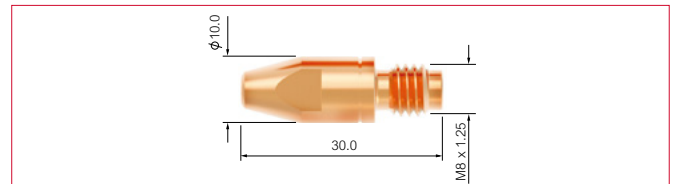

* Denotes torch package standard wear part set-up

Suregrip Pull Contact Tips

SGP 240A/240W

Part No.	Description	Material	Wire Size	
			mm	inch
PB2504-06	Contact Tip	Cu	0.6	0.023
PB2504-08	Contact Tip	Cu	0.8	0.030
PB2504-09	Contact Tip	Cu	0.9	0.035
PB2504-10	Contact Tip	Cu	1.0	0.040
PB2504-12	Contact Tip	Cu	1.2	0.045
PB2504-14	Contact Tip	Cu	1.4	0.055
PB2504-16	Contact Tip	Cu	1.6	0.063
PB2504-10A	Contact Tip	Cu	1.0	0.040
*PB2504-12A	Contact Tip	Cu	1.2	0.045
PB2504-16A	Contact Tip	Cu	1.6	0.063

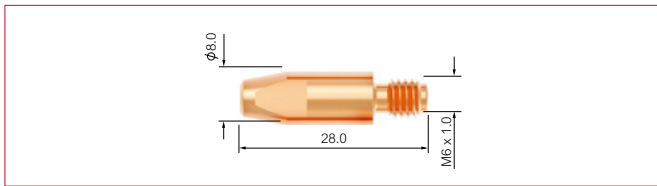

PB2505-08	Contact Tip	CuCrZr	0.8	0.030
PB2505-09	Contact Tip	CuCrZr	0.9	0.035
PB2505-10	Contact Tip	CuCrZr	1.0	0.040
PB2505-12	Contact Tip	CuCrZr	1.2	0.045
PB2505-16	Contact Tip	CuCrZr	1.6	0.063
PB2505-10A	Contact Tip	CuCrZr	1.0	0.040
PB2505-12A	Contact Tip	CuCrZr	1.2	0.045
PB2505-16A	Contact Tip	CuCrZr	1.6	0.063

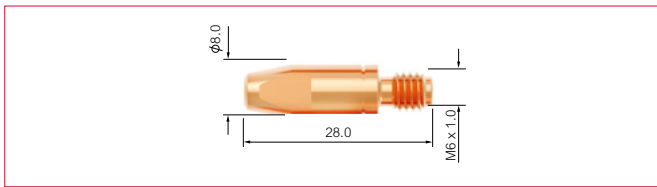

SGP 360A/401W

Part No.	Description	Material	Wire Size	
			mm	inch
PB4014-08	Contact Tip	Cu	0.8	0.030
PB4014-09	Contact Tip	Cu	0.9	0.035
PB4014-10	Contact Tip	Cu	1.0	0.040
PB4014-12	Contact Tip	Cu	1.2	0.045
PB4014-14	Contact Tip	Cu	1.4	0.055
PB4014-16	Contact Tip	Cu	1.6	0.063
PB4014-20	Contact Tip	Cu	2.0	0.080
PB4014-24	Contact Tip	Cu	2.4	0.095
PB4014-10A	Contact Tip	Cu	1.0	0.040
*PB4014-12A	Contact Tip	Cu	1.2	0.045
PB4014-16A	Contact Tip	Cu	1.6	0.063

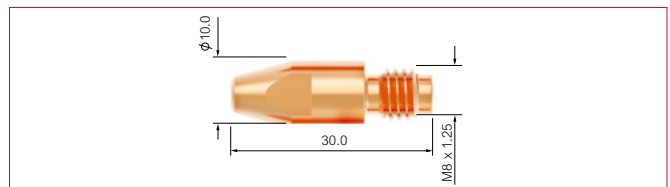

PB4015-08	Contact Tip	CuCrZr	0.8	0.030
PB4015-09	Contact Tip	CuCrZr	0.9	0.035
PB4015-10	Contact Tip	CuCrZr	1.0	0.040
PB4015-12	Contact Tip	CuCrZr	1.2	0.045
PB4015-13	Contact Tip	CuCrZr	1.3	0.052
PB4015-14	Contact Tip	CuCrZr	1.4	0.055
PB4015-16	Contact Tip	CuCrZr	1.6	0.063
PB4015-20	Contact Tip	CuCrZr	2.0	0.080
PB4015-24	Contact Tip	CuCrZr	2.4	0.095
PB4015-10A	Contact Tip	CuCrZr	1.0	0.040
PB4015-12A	Contact Tip	CuCrZr	1.2	0.045
PB4015-16A	Contact Tip	CuCrZr	1.6	0.063

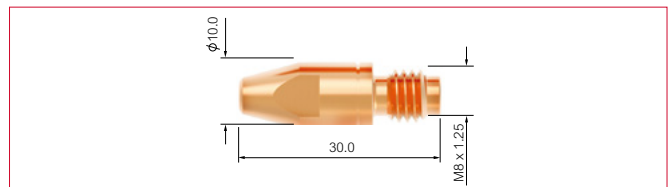

* Denotes torch package standard wear part set-up

Duragrip Spool-On Tip Adaptors

DSP 150A

Part No.	Description	Material
* PB1507L/H	Tip Adaptor Left Hand	Brass

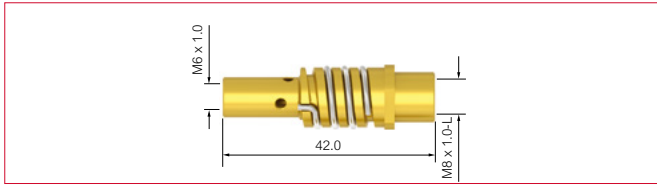

DSP 240A

Part No.	Description	Material
* PB2412	Tip Adaptor	Brass

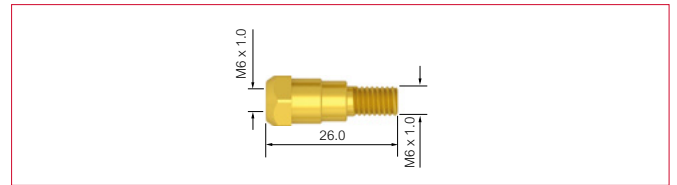

DSP 250A

Part No.	Description	Material
* PB2506	Tip Adaptor	Brass

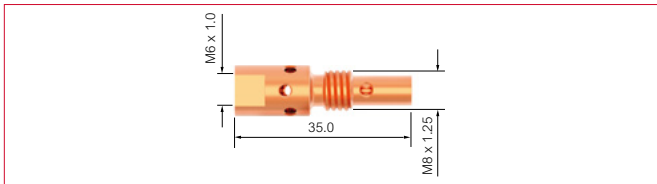

PB2536	Tip Adaptor M8	Brass
--------	----------------	-------

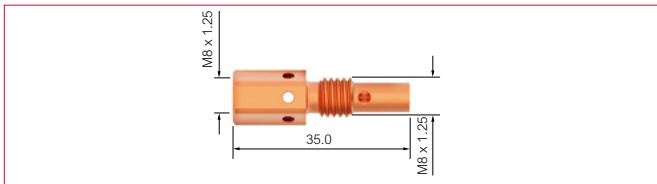

DSP 360A

Part No.	Description	Material
PB3612	Tip Adaptor	Brass
PB3613	Tip Adaptor	Brass
* PB3614	Tip Adaptor	Brass

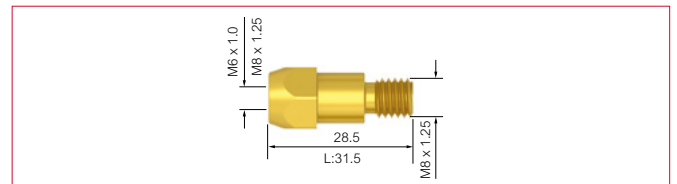

Diffusers

DSP 240A

Part No.	Description	Colour	Material
* PB2405B	Diffuser	Black	DMC3
PB2405C	Diffuser	White	Ceramic
PB2405W	Diffuser	White	DMC3
PB2405S	Diffuser	White	Silicon

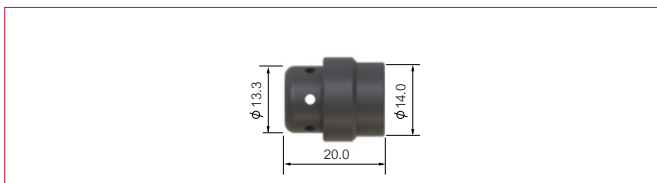

DSP 360A

Part No.	Description	Colour	Material
* PB3605B	Diffuser	Black	DMC3
PB3605C	Diffuser	White	Ceramic
PB3605W	Diffuser	White	DMC3

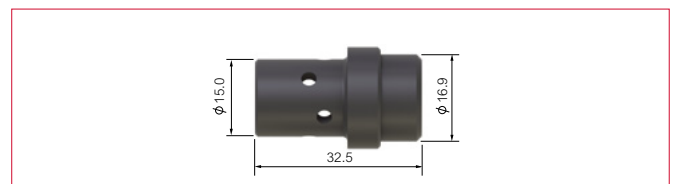

* Denotes torch package standard wear part set-up

Suregrip Pull Tip Adaptors

SGP 240A/240W

Part No.	Description	Material
* PB2412	Tip Adaptor	Brass

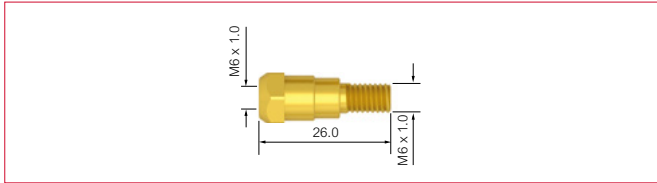

SGP 360A

Part No.	Description	Material
PB3612	Tip Adaptor 28.5mm M6	Brass
PB3613	Tip Adaptor 31.5mm M6	Brass
* PB3614	Tip Adaptor 28.5mm M8	Brass

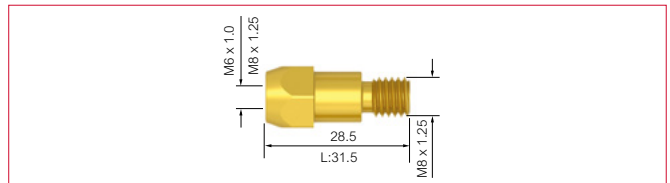

SGP 401W

Part No.	Description	Material
* PB5001	Tip Adaptor	Brass
PB5001C-R	Tip Adaptor	Copper

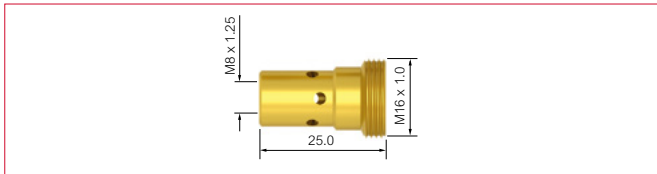

PB5001L	Tip Adaptor	Brass
---------	-------------	-------

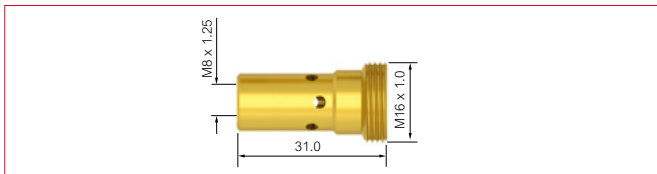

Diffusers

SGP 240A/240W

Part No.	Description	Colour	Material
PB2405B	Diffuser	Black	DMC3
* PB2405C	Diffuser	White	Ceramic
PB2405W	Diffuser	White	DMC3
PB2405S	Diffuser	Red	Silicon

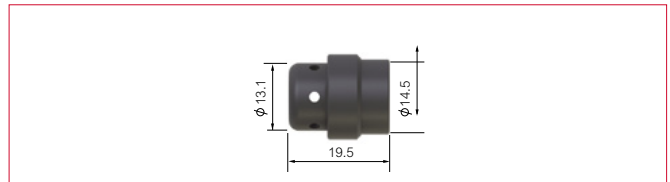

SGP 360A

Part No.	Description	Colour	Material
PB3605B	Diffuser	Black	DMC3
* PB3605C	Diffuser	White	Ceramic
PB3605W	Diffuser	White	DMC3
PB3605H	Diffuser High Performance	Black	HPP

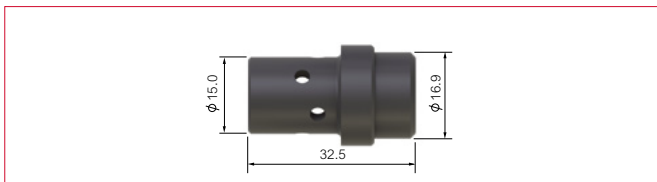

SGP 401W

Part No.	Description	Colour	Material
PB5005B	Diffuser	Black	DMC3
* PB5005C	Diffuser	White	Ceramic
PB5005W	Diffuser	White	DMC3
PB5005H	Diffuser High Performance	Black	HPP

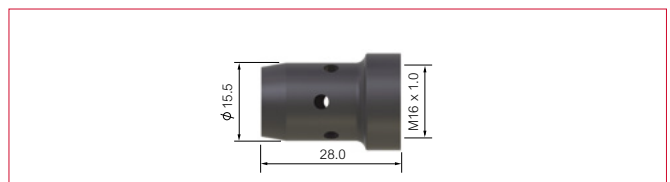

* Denotes torch package standard wear part set-up

Liner Options 1.0-1.6mm

SGP 240A/360A/240W/401W

Part No.	Description	Length	Nipple	Wire Size mm
PB2513-80	Teflon Liner x 8mt	8.6mt	Teflon Brass Nipple	1.0-1.2



*PB2564-80	Polyamide/Brass Liner 4.7mm O/D x 8mt	8.6mt	Brass Nipple	1.2-1.6
------------	---------------------------------------	-------	--------------	---------



PB5033-80B	Steel Liner x 8mt	8.5mt	Brass Nipple	1.0-1.2
------------	-------------------	-------	--------------	---------



* Denotes torch package standard wear part set-up

Liner Options 1.2-2.0mm

SGP 240A/360A/240W/401W

Part No.	Description	Length	Nipple	Wire Size mm
PB3564-80	Polyamide/Brass Liner 4.7mm x 8mt	8.6mt	Brass Nipple	1.6-2.0



PB3626-80	Teflon Liner x 8mt	8.6mt	Brass Nipple	1.2-1.6
-----------	--------------------	-------	--------------	---------



PB5034-80B	Steel Liner x 8mt	8.5mt	Brass Nipple	1.2-1.6
------------	-------------------	-------	--------------	---------





WeldTronic

42-46 Micro Circuit Dandenong South
Victoria, 3175

Telephone: 03 9702 9366

Facsimile: 03 9702 9766