

SUREGRIP
PLASMA CUTTING SERIES



Welding Tools for the Professional

A Smart Approach

Parker Torchology is shaped by people with vision, a passion for improvement and a belief in delivering the very best Welding and Cutting Torch Range in the World.

We expect a great deal from our products, so we ask a lot of ourselves and our engineers.

Our mantra: **Innovation, Technology, Performance.**



DNA

Design and Engineering excellence are at the core of everything we do.

Every torch we build is driven by our relentless pursuit of perfection.

Premium Features

At Parker Torchology we do things differently, we strive to solve your problems with the perfect product to suit your needs. We create smart product features encased in cutting-edge design to ensure you always have the best tools to hand.





Production

A fusion of precision production engineering, our bespoke processing techniques and a fanatical attention to detail ensures every welding torch we produce is worthy of the Parker Torchology name.

Testing, Testing, Testing

It takes patience to develop a new product, it's a lot more than a great idea.

Product development is an iterative process, trying something over and over, changing one small variable at a time.

We build endless prototypes and test pieces that undergo months of rigorous testing. Only once a product has passed up to 88 different test procedures, with every single part tested separately do we consider our latest designs ready for market.

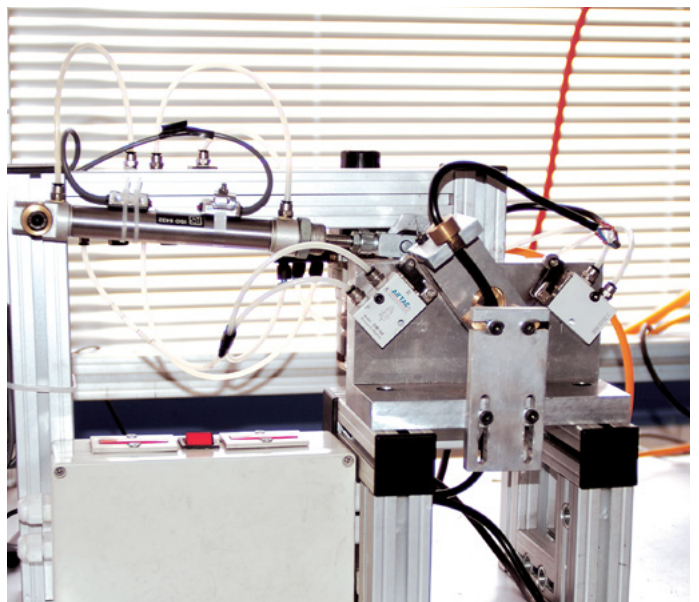

Partners

Our customers and business partners play a vital role in our development. With the core aim to strive together, we work with end-users, distributors and academic institutions alike.

As a result we share fundamental values in order to succeed in our respective market places, supporting economic growth and collaborative opportunities with others.

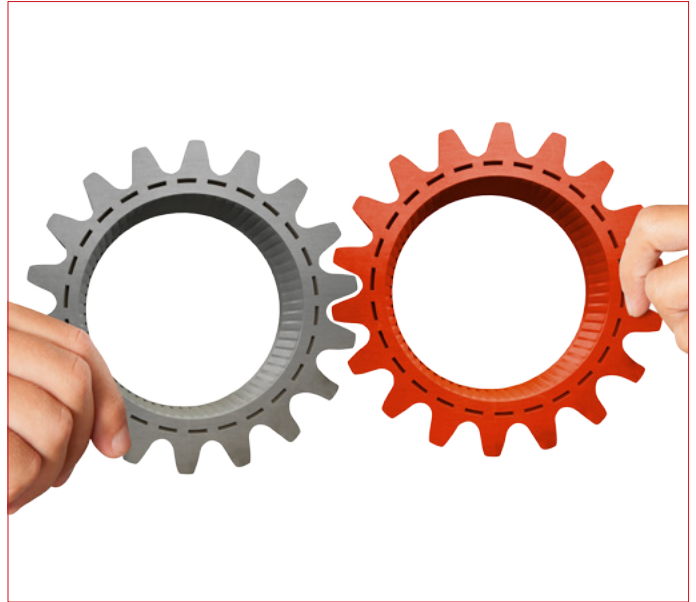

A Bright Future

Technology doesn't stand still, which is why we are constantly innovating to bring you the best products on the market.

Our strong vision and focused innovation strategy, not to mention our passion to revolutionize the industry, ensure that Parker Torchology is a byword for excellence.

We Talk Torches

Ranges

Plasma Cutting Torch Series

Suregrip Surecut Plasma Cutting Torch Range	5
Suregrip TRF Plasma Cutting Torch Range	21
Suregrip CBR Plasma Cutting Torch Range	45

Air-Cooled

Contents

Suregrip Surecut Plasma Cutting Torch Range Features Focus	6
Suregrip Surecut Plasma Cutting Torch Range Overview and Ratings	8

Torch Range

Suregrip Surecut Plasma SCP 25	9
Suregrip Surecut Plasma SCP 40	10
Suregrip Surecut Plasma SCP 60	11
Suregrip Surecut Plasma SCP 80	12
Suregrip Surecut Plasma SCP 120R	13

Wear Parts

Cutting Tips	14
Electrodes	16
Swirl Rings	16
Retaining Caps	17
Shield Cap Bodies	17
Stand off Guides	18
Shield Caps	18
Shield Cap Gouging	18
Cooling Tubes	19
Cutting Buggies	19
Circle / Cutting Attachment Kits	19

Cross Reference Table	20
------------------------------	----

Suregrip Surecut Plasma Cutting Torch Range

Air-Cooled Features Focus

Air-Cooled

A unique system of Arc initiation removes the traditional requirements of potentially dangerous levels of high frequency.

A Safe and Sound Strike Without High Frequency

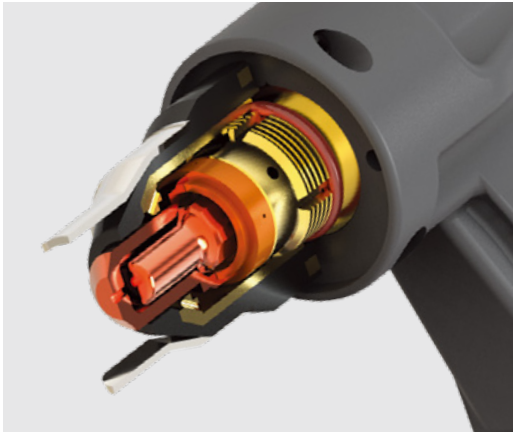

Arc Initiation Systems

Patented Arc strike technology initiates the pilot arc without the use of high frequency

Safety Systems

A twin "fail-safe" system located beneath the shield cap ensures the torch cannot be activated if the cap is removed

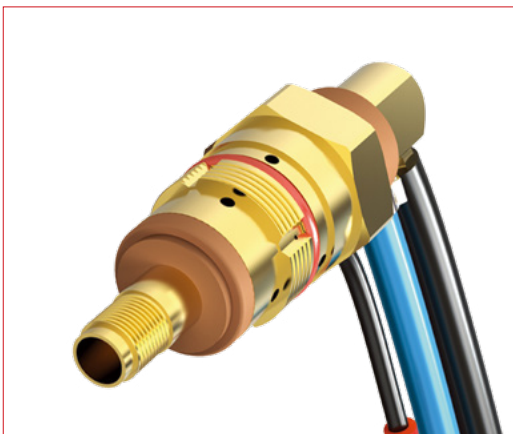

Torch Bodies

Produced from precision tolerance and machined aerospace polymers

Features Focus

Cutting Tools for the Professional



Ergonomics – For Comfort and Handleability

- Large surface area grips improve positionability and operator comfort
- Cable supports are designed to offer the greatest flexibility

Trigger System

A patented slide to operate switch system is easy to operate and prevents accidental torch ignition



Terminations

Terminations available for separate and central connector cable types



The Smart Way To Buy Welding and Cutting Tools



Model	SCP 25	SCP 40	SCP 60	SCP 80	SCP 120R
Technical Data					
Cooling Method	Air-Cooled	Air-Cooled	Air-Cooled	Air-Cooled	Air-Cooled
Rating:	25A	40A	60A	80A	120A
Cutting Thickness	6-8mm	8-12mm	12-20mm	20-25mm	30-35mm
Duty Cycle:	60%	60%	60%	60%	60%
Gas	Air/N ₂	Air/N ₂	Air/N ₂	Air/N ₂	Air/N ₂
Gas Pressure	2.8 bar 40 psi	4.5-5.0 bar 65-75 psi	4.5-5.0 bar 65-75 psi	4.5-5.0 bar 65-75 psi	4.5-5.0 bar 65-75 psi
Gas Flow	40 l/min 85 scfh	100 l/min 210 scfh	110 l/min 230 scfh	110 l/min 230 scfh	200 l/min 420 scfh
Pilot	Electrode to Tip	Electrode to Tip	Electrode to Tip	Electrode to Tip	Electrode to Tip
Ignition	Back Striking Without HF	Back Striking Without HF	Back Striking Without HF	Back Striking Without HF	Back Striking Without HF
Post Flow	90 sec	90 sec	90 sec	90 sec	90 sec

SCP 25 Suregrip Surecut Plasma Cutting Torch Range

Rating: 25A Air/N₂ gas, @ 60% duty cycle.

Air-Cooled Cutting Torch Range

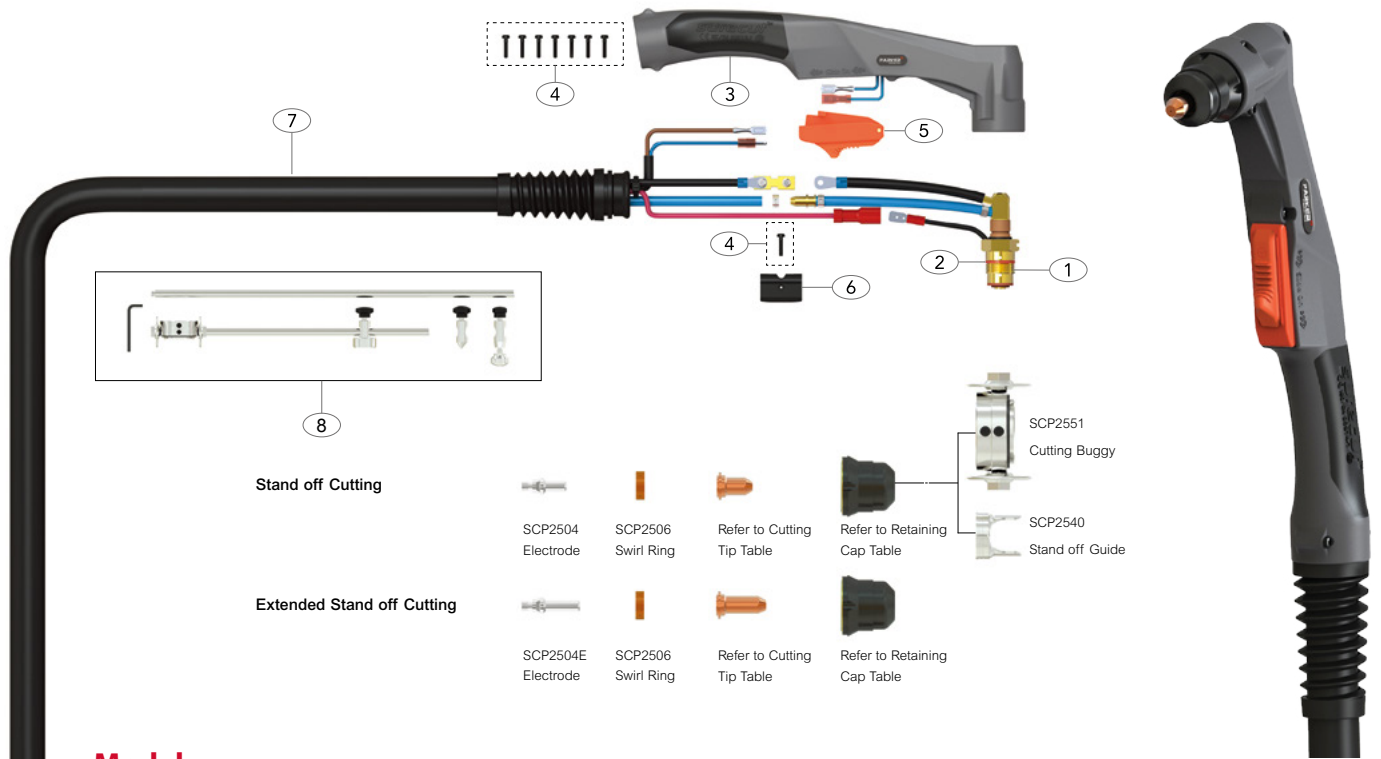

Stand off Cutting

Extended Stand off Cutting

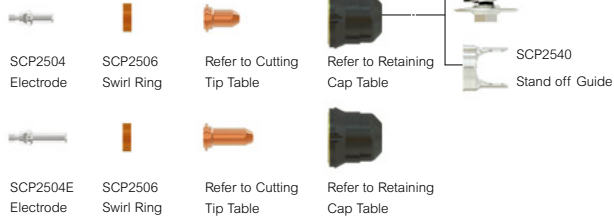

Model

Description	Part No.
Suregrip Plasma Cutting Torch Package	6mt
	SCP25-60-CF1

Wear Parts

Cutting Tips

Part No.	Description	Bore ϕ A	Amps
SCP2520-06	Cutting Tip	0.65mm	10-20A
*SCP2520-08	Cutting Tip	0.8mm	20-30A
SCP2520-06E	Cutting Tip Extended	0.65mm	10-20A
SCP2520-08E	Cutting Tip Extended	0.8mm	20-30A

Retaining Caps

Part No.	Description
SCP2530-1	Retaining Cap, 1 hole
*SCP2530-2	Retaining Cap, 2 holes
SCP2530-4	Retaining Cap, 4 holes

Spare Parts

Part No.	Description
1 SCP2501	SCP25 70° Torch Head Kit
2 SCP2508	O Ring
3 SCP2514	Plasma Handle Kit
4 SCPSP1	Screw Pack
5 SCP2516	Plasma Safety Trigger
6 SCP2515	Location Block
7 *SCP2519-60-CF1	Cable Assembly Complete x 6mt
8 SCP2550	Circle Cutting Attachment Kit

CF1

*Denotes torch package standard wear part set-up
For more information please refer to the following sections:
•Master Wear Parts Table Page 14-19

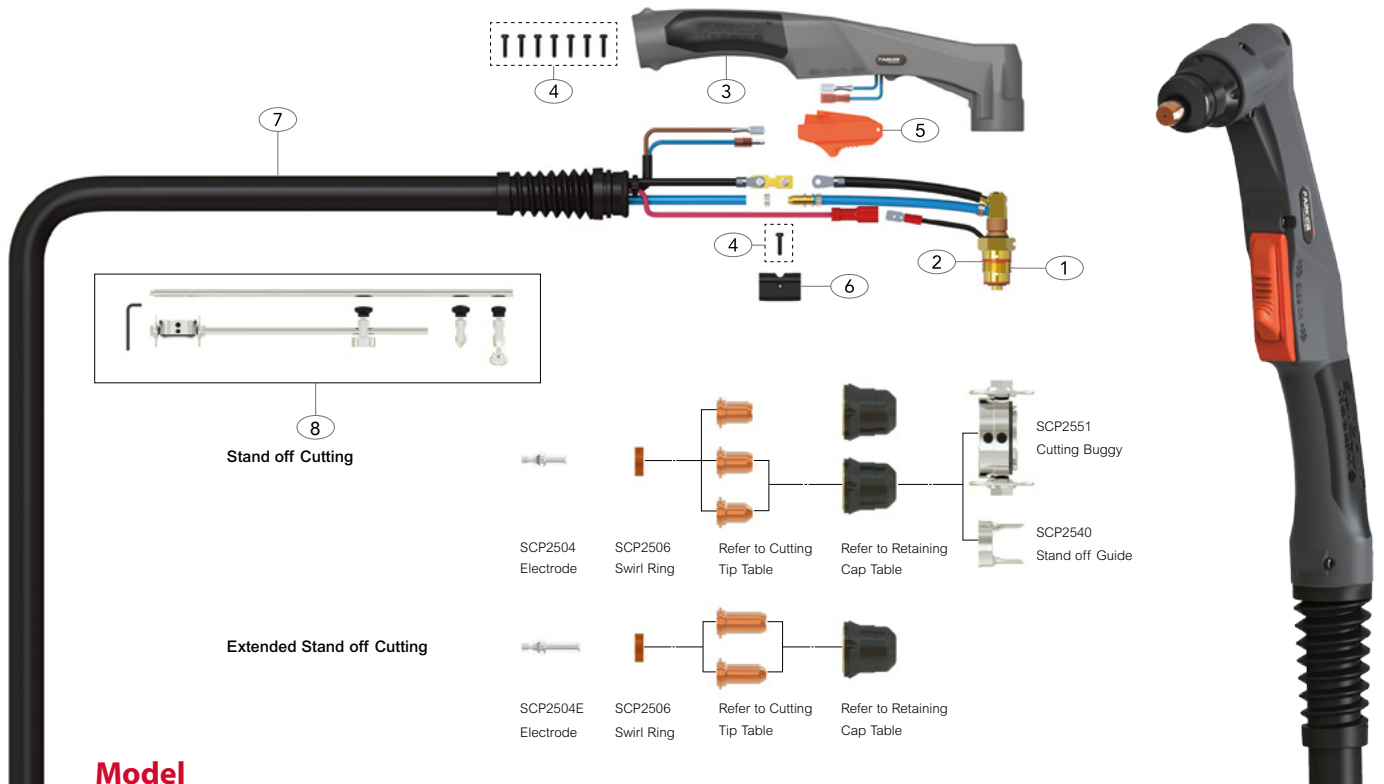

Model

Description	Part No.
Suregrip Plasma Cutting Torch Package	6mt
	SCP40-60-CF2

Wear Parts

Cutting Tips

Part No.	Description	Bore ϕ A	Amps
SCP2520-06	Cutting Tip	0.65mm	10-20A
*SCP2520-08	Cutting Tip	0.8mm	20-30A
SCP2520-06E	Cutting Tip Extended	0.65mm	10-20A
SCP2520-08E	Cutting Tip Extended	0.8mm	20-30A
*SCP2520-09	Cutting Tip	0.9mm	30-40A
SCP2524-09	Cutting Tip Flat	0.9mm	30-40A
SCP2522-09	Cutting Tip Cross Groove	0.9mm	30-40A
SCP2522-09E	Cutting Tip Extended Cross Groove	0.9mm	30-40A

Retaining Caps

Part No.	Description
*SCP2530-6	Retaining Cap, 6 holes
SCP2530-6L	Retaining Cap, 6 holes Maximum Life

Spare Parts

Part No.	Description
1 SCP4001	SCP40 70° Torch Head Kit
2 SCP2508	O Ring
3 SCP2514	Plasma Handle Kit
4 SCPSP1	Screw Pack
5 SCP2516	Plasma Safety Trigger
6 SCP2515	Location Block
7 *SCP4019-60-CF2	Cable Assembly Complete x 6mt
8 SCP2550	Circle Cutting Attachment Kit

CF2

*Denotes torch package standard wear part set-up
For more information please refer to the following sections:
•Master Wear Parts Table Page 14-19

SCP 60 Suregrip Surecut Plasma Cutting Torch Range

Rating: 60A Air/N₂ gas, @ 60% duty cycle.

Air-Cooled Cutting Torch Range

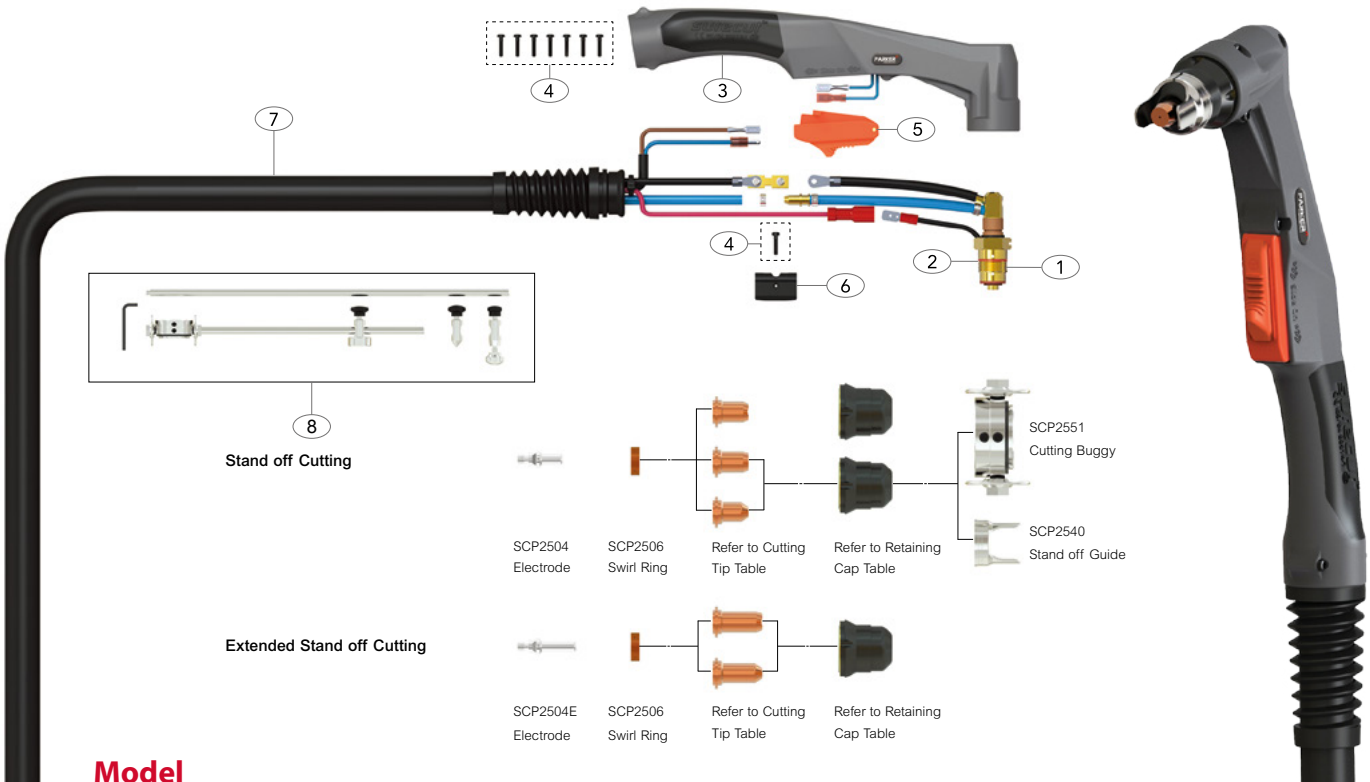

Model

Description	Part No.
Suregrip Plasma Cutting Torch Package	6mt
	SCP60-60-CF2

Wear Parts

Cutting Tips

Part No.	Description	Bore ϕ A	Amps
SCP2520-06	Cutting Tip	0.65mm	10-20A
* SCP2520-08	Cutting Tip	0.8mm	20-30A
SCP2520-06E	Cutting Tip Extended	0.65mm	10-20A
SCP2520-08E	Cutting Tip Extended	0.8mm	20-30A
SCP2522-09	Cutting Tip Cross Groove	0.9mm	30-40A
SCP2522-09E	Cutting Tip Extended	0.9mm	30-40A
SCP2524-10	Cutting Tip Flat	1.0mm	40-50A
SCP2524-11	Cutting Tip	1.1mm	50-60A

Retaining Caps

Part No.	Description
*SCP2530-6	Retaining Cap, 6 holes
SCP2530-6L	Retaining Cap, 6 holes Maximum Life

Spare Parts

Part No.	Description
1	SCP6001 SCP60 70° Torch Head Kit
2	SCP2508 O Ring
3	SCP2514 Plasma Handle Kit
4	SCPSP1 Screw Pack
5	SCP2516 Plasma Safety Trigger
6	SCP2515 Location Block
7	*SCP6019-60-CF2 Cable Assembly Complete x 6mt
8	SCP2550 Circle Cutting Attachment Kit

CF2

*Denotes torch package standard wear part set-up
For more information please refer to the following sections:
•Master Wear Parts Table Page 14-19

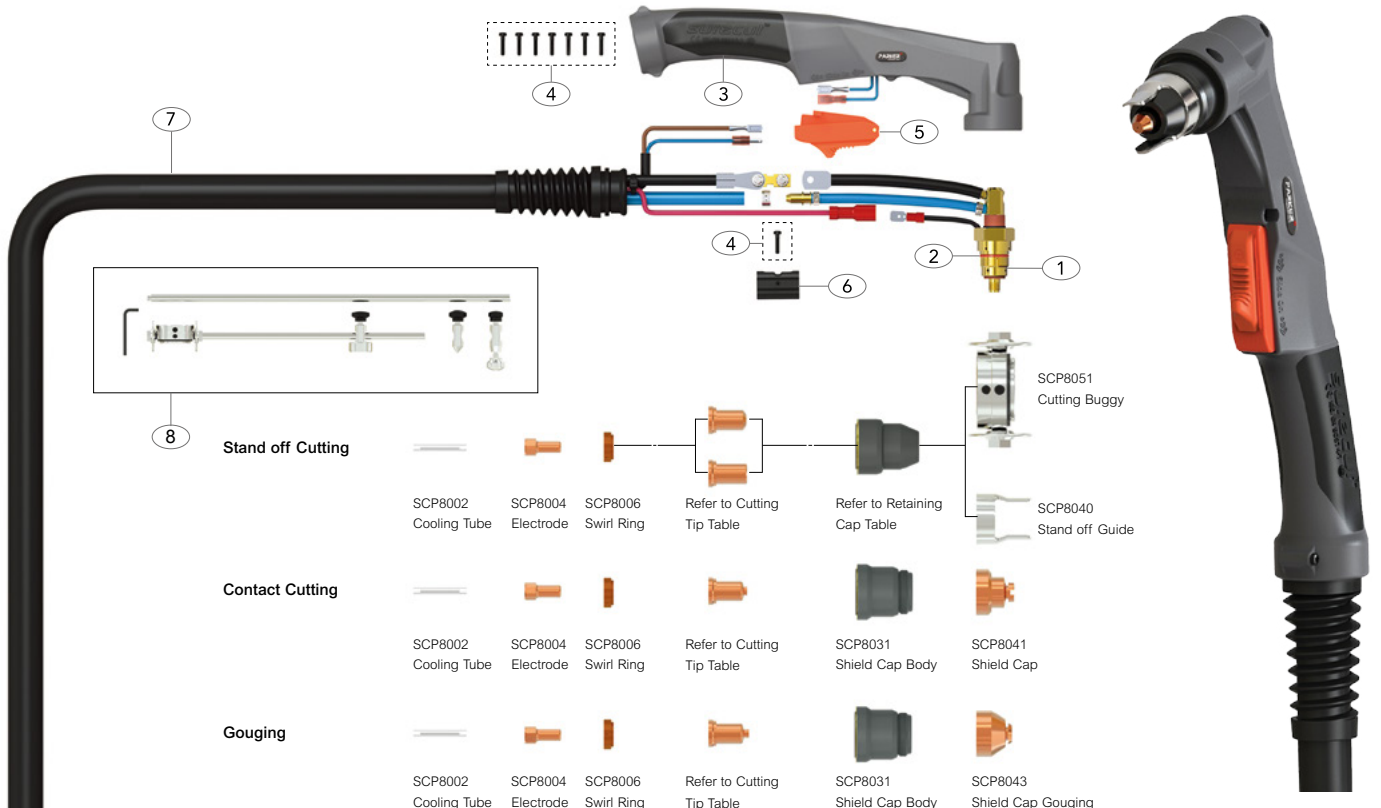

Model

Description	Part No.
Suregrip Plasma Cutting Torch Package	6mt
	SCP80-60-CF4

Wear Parts

Cutting Tips

Part No.	Description	Bore Ø A	Amps
SCP8022-09	Cutting Tip Cross Groove	0.9mm	30-40A
SCP8028-16	Gouging Tip	1.6mm	80A
SCP8020-10	Cutting Tip	1.0mm	40-50A
SCP8020-11	Cutting Tip	1.1mm	50-60A
SCP8020-12	Cutting Tip	1.2mm	60-70A
*SCP8020-13	Cutting Tip	1.3mm	70-80A
SCP8026-10	Cutting Tip Contact	1.0mm	40-50A
SCP8026-11	Cutting Tip Contact	1.1mm	50-60A
SCP8026-12	Cutting Tip Contact	1.2mm	60-70A
SCP8026-13	Cutting Tip Contact	1.3mm	70-80A

Retaining Caps

Part No.	Description
*SCP8030	Retaining Cap

Spare Parts

Part No.	Description
1	SCP8001 SCP80 70° Torch Head Kit
2	SCP2508 O Ring
3	SCP8014 Plasma Handle Kit
4	SCPSP1 Screw Pack
5	SCP2516 Plasma Safety Trigger
6	SCP8015 Location Block
7	*SCP8019-60-CF4 Cable Assembly Complete x 6mt
8	SCP8050 Circle Cutting Attachment Kit

*Denotes torch package standard wear part set-up
For more information please refer to the following sections:
•Master Wear Parts Table Page 14-19

CF4

SCP 120R Suregrip Surecut Plasma Cutting Torch Range

Rating: 120A Air/N₂ gas, @ 60% duty cycle.

Air-Cooled Cutting Torch Range

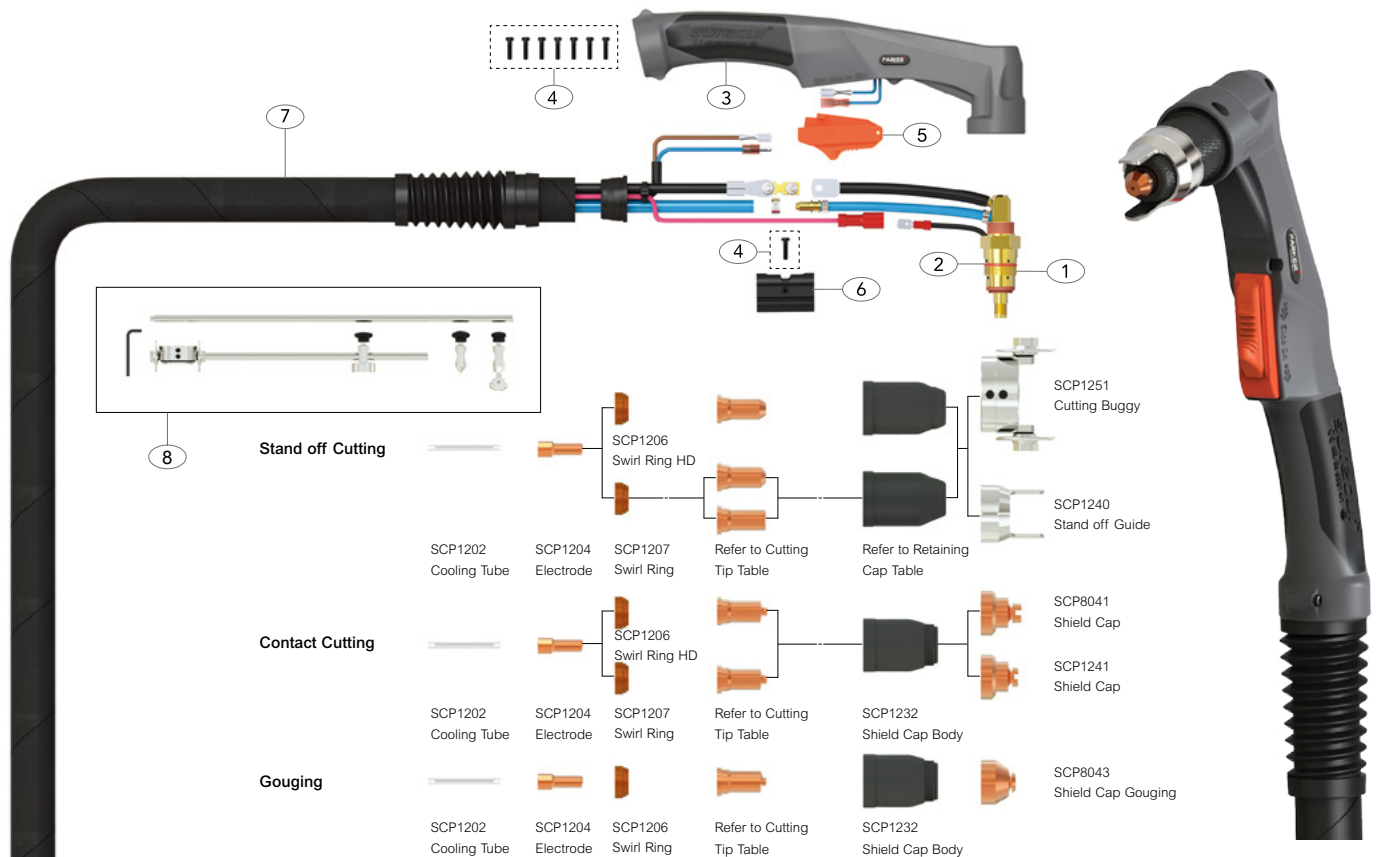

Model

Description	Part No.
Suregrip Plasma Cutting Torch Package	6mt
	SCP120R-60-CF4

Wear Parts

Cutting Tips

Part No.	Description	Bore ϕ A	Amps
SCP1220-10	Cutting Tip	1.0mm	40-50A
SCP1220-11	Cutting Tip	1.1mm	50-60A
SCP1220-12	Cutting Tip	1.2mm	60-70A
SCP1221-14	Cutting Tip	1.4mm	80-90A
SCP1221-15	Cutting Tip	1.5mm	100-110A
*SCP1221-16	Cutting Tip	1.6mm	110-120A
SCP1222-09	Cutting Tip Contact	0.9mm	30-40A
SCP1228-22	Gouging Tip	2.2mm	120A
SCP1226-10	Cutting Tip Contact	1.0mm	40-50A
SCP1226-11	Cutting Tip Contact	1.1mm	50-60A
SCP1226-12	Cutting Tip Contact	1.2mm	60-70A
SCP1227-14	Cutting Tip Contact	1.4mm	80-90A
SCP1227-15	Cutting Tip Contact	1.5mm	100-110A
SCP1227-16	Cutting Tip Contact	1.6mm	110-120A

Retaining Caps

Part No.	Description
*SCP1230	Retaining Cap , 30-70A
SCP1231	Retaining Cap , 80-120A

Spare Parts

Part No.	Description
1	SCP1201 SCP120 70° Torch Head Kit
2	SCP1208 O Ring
3	SCP8014C Plasma Handle Kit
4	SCPSP1 Screw Pack
5	SCP2516 Plasma Safety Trigger
6	SCP8015 Location Block
7	*SCP8019C-60-CF4 Cable Assembly Complete x 6mt
8	SCP1250 Circle Cutting Attachment Kit

*Denotes torch package standard wear part set-up
 For more information please refer to the following sections:
 •Master Wear Parts Table Page 14-19

CF4

SCP 25/40/60

Part No.	Description	Bore ϕA	Amps
SCP2520-06	Cutting Tip	0.65mm	10-20A
* SCP2520-08	Cutting Tip	0.8mm	20-30A

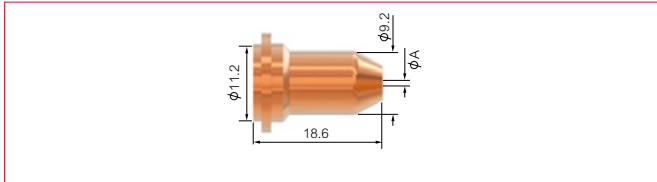

SCP2520-06E	Cutting Tip Extended	0.65mm	10-20A
SCP2520-08E	Cutting Tip Extended	0.8mm	20-30A

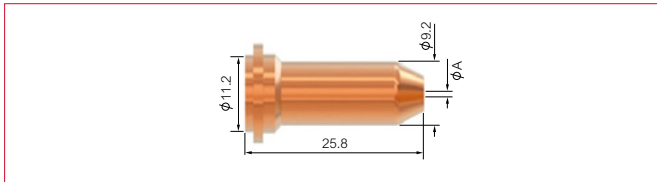

SCP 40/60

Part No.	Description	Bore ϕA	Amps
* SCP2520-09	Cutting Tip	0.9mm	30-40A

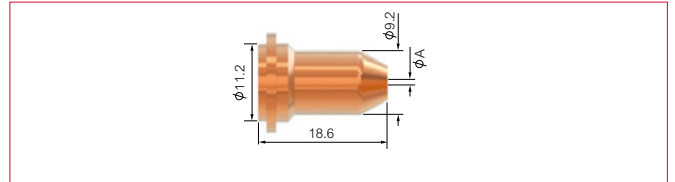

SCP2524-09	Cutting Tip Flat	0.9mm	30-40A
------------	------------------	-------	--------

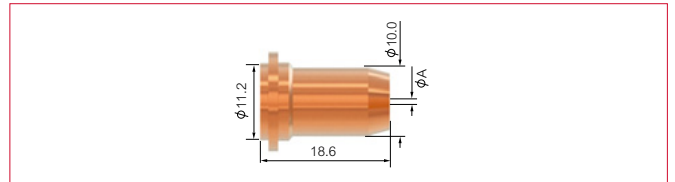

SCP 40/60

Part No.	Description	Bore ϕA	Amps
SCP2522-09	Cutting Tip Cross Groove	0.9mm	30-40A

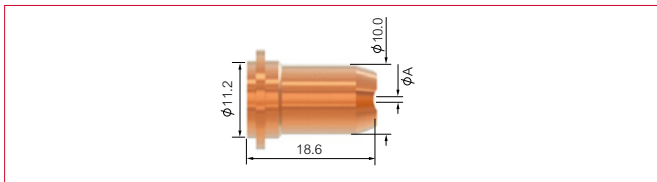

SCP2522-09E	Cutting Tip Extended Cross Groove	0.9mm	30-40A
-------------	-----------------------------------	-------	--------

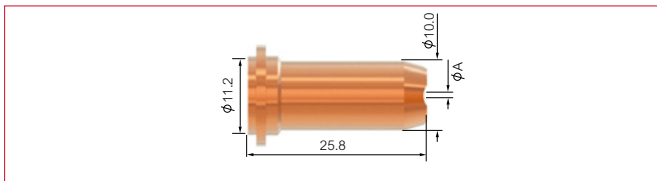

SCP2524-10	Cutting Tip Flat	1.0mm	40-50A
------------	------------------	-------	--------

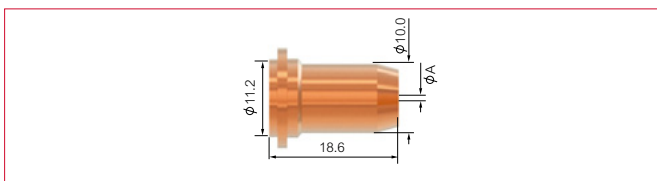

SCP 60

Part No.	Description	Bore ϕA	Amps
* SCP2524-11	Cutting Tip Flat	1.1mm	50-60A

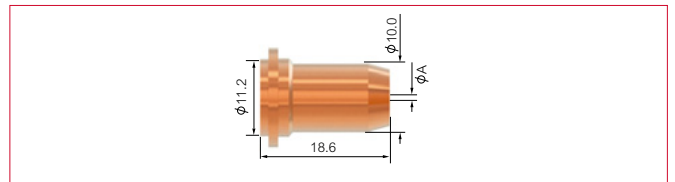

SCP 80

Part No.	Description	Bore ϕA	Amps
SCP8022-09	Cutting Tip Cross Groove	0.9mm	30-40A

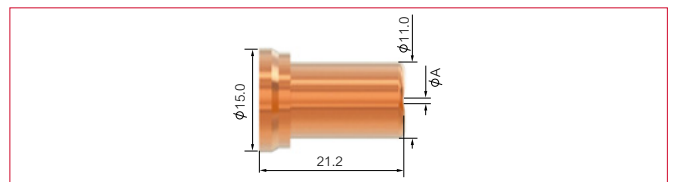

SCP8028-16	Gouging Tip	1.6mm	80A
------------	-------------	-------	-----

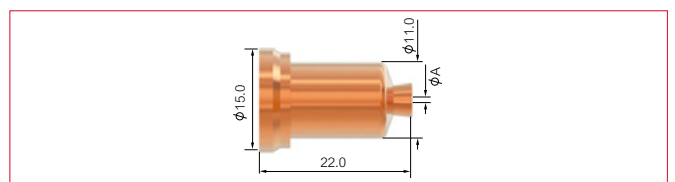

* Denotes torch package standard wear part set-up

Cutting Tips

SCP 80

Part No.	Description	Bore ϕ A	Amps
SCP8020-10	Cutting Tip	1.0mm	40-50A
SCP8020-11	Cutting Tip	1.1mm	50-60A
SCP8020-12	Cutting Tip	1.2mm	60-70A
* SCP8020-13	Cutting Tip	1.3mm	70-80A

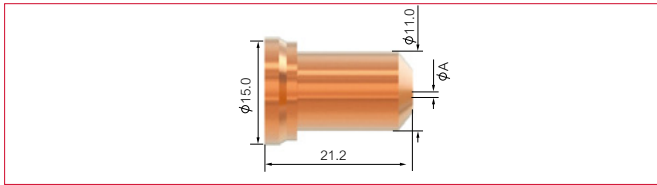

SCP8026-10	Cutting Tip Contact	1.0mm	40-50A
SCP8026-11	Cutting Tip Contact	1.1mm	50-60A
SCP8026-12	Cutting Tip Contact	1.2mm	60-70A
SCP8026-13	Cutting Tip Contact	1.3mm	70-80A

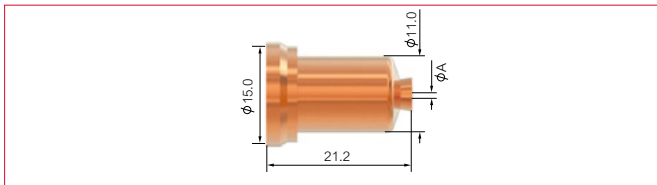

SCP 120R

Part No.	Description	Bore ϕ A	Amps
SCP1222-09	Cutting Tip Contact	0.9mm	30-40A

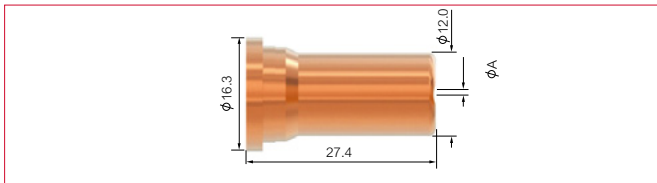

SCP1228-22	Gouging Tip	2.2mm	120A
------------	-------------	-------	------

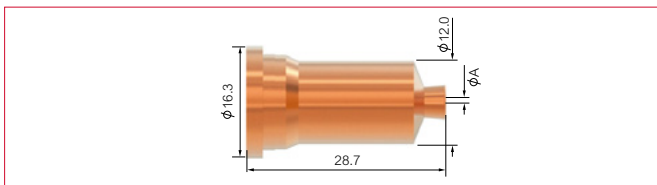

SCP 120R

Part No.	Description	Bore ϕ A	Amps
SCP1220-10	Cutting Tip	1.0mm	40-50A
SCP1220-11	Cutting Tip	1.1mm	50-60A
SCP1220-12	Cutting Tip	1.2mm	60-70A

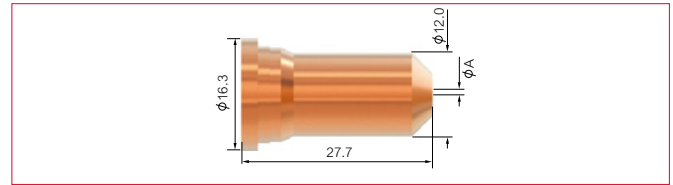

SCP1221-14	Cutting Tip	1.4mm	80-90A
SCP1221-15	Cutting Tip	1.5mm	100-110A
* SCP1221-16	Cutting Tip	1.6mm	110-120A

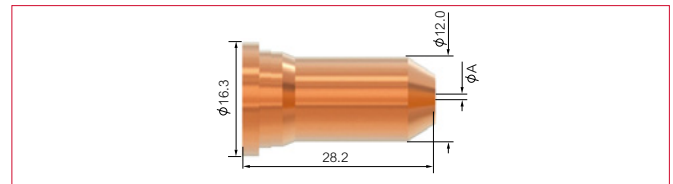

SCP1226-10	Cutting Tip Contact	1.0mm	40-50A
SCP1226-11	Cutting Tip Contact	1.1mm	50-60A
SCP1226-12	Cutting Tip Contact	1.2mm	60-70A

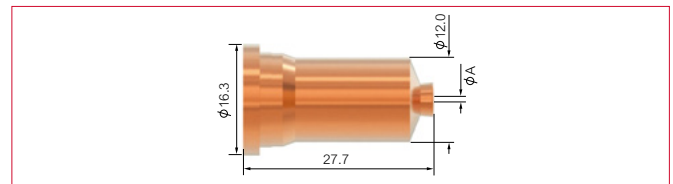

SCP1227-14	Cutting Tip Contact	1.4mm	80-90A
SCP1227-15	Cutting Tip Contact	1.5mm	100-110A
SCP1227-16	Cutting Tip Contact	1.6mm	110-120A

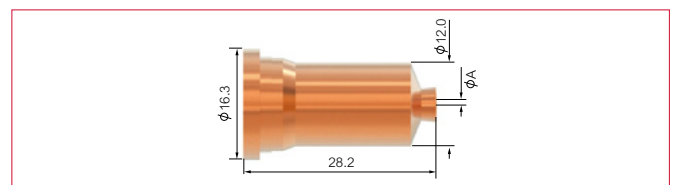

* Denotes torch package standard wear part set-up

SCP 25/40/60

Part No.	Description
* SCP2504	Electrode

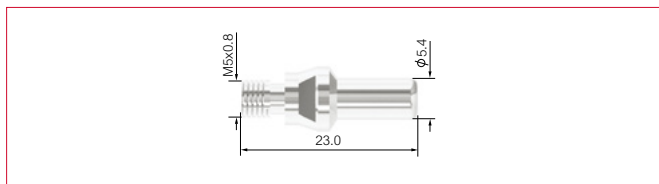

SCP2504E	Electrode Extended
----------	--------------------

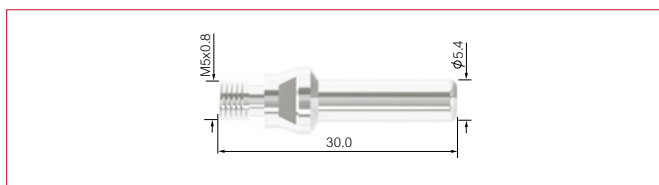

SCP 80

Part No.	Description
* SCP8004	Electrode

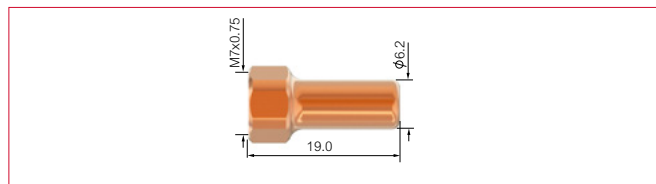

SCP 120R

Part No.	Description
* SCP1204	Electrode

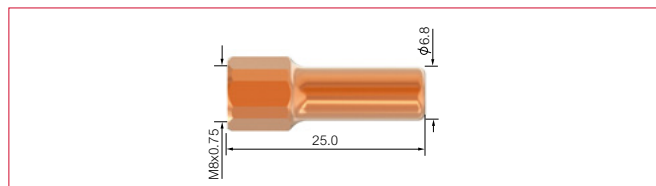

Swirl Rings

SCP 25/40/60

Part No.	Description
* SCP2506	Swirl Ring

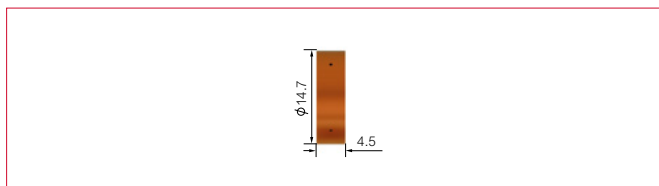

SCP 120R

Part No.	Description
* SCP1206	Swirl Ring, 6 holes-HD

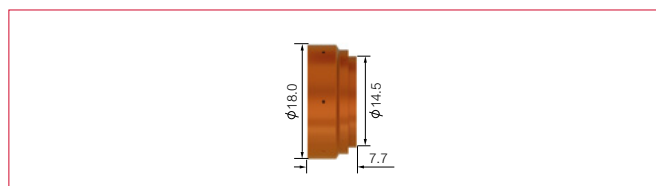

SCP1207	Swirl Ring, 4 holes
---------	---------------------

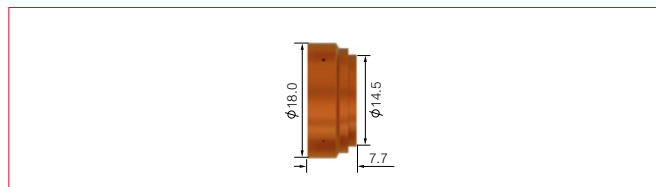

SCP 80

Part No.	Description
* SCP8006	Swirl Ring

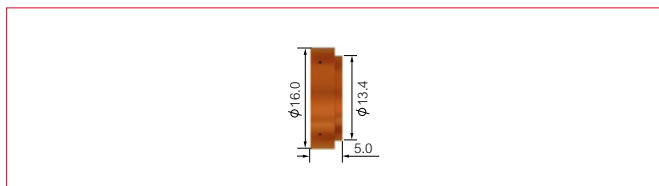

* Denotes torch package standard wear part set-up

Retaining Caps

SCP 25

Part No.	Description
SCP2530-1	Retaining Cap, 1 hole
* SCP2530-2	Retaining Cap, 2 holes
SCP2530-4	Retaining Cap, 4 holes

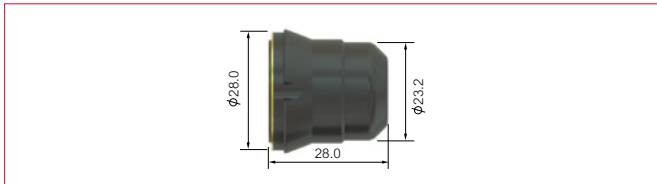

SCP 120R

Part No.	Description
SCP1230	Retaining Cap , 30-70A

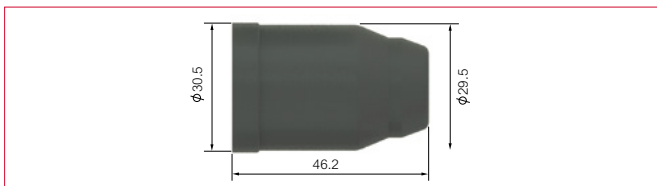

* SCP1231	Retaining Cap , 80-120A
-----------	-------------------------

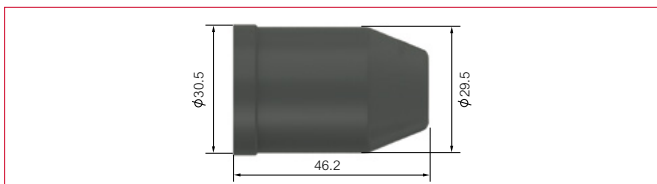

SCP 40/60

Part No.	Description
* SCP2530-6	Retaining Cap, 6 holes

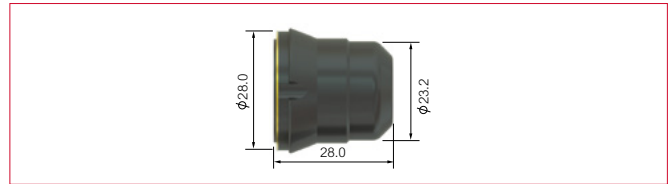

SCP2530-6L	Retaining Cap, 6 holes Maximum Life
------------	-------------------------------------

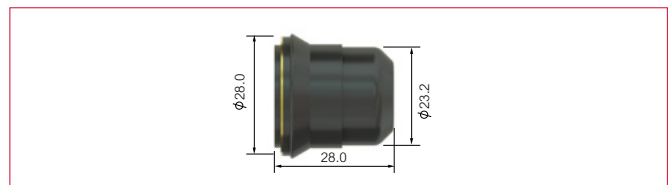

SCP 80

Part No.	Description
* SCP8030	Retaining Cap

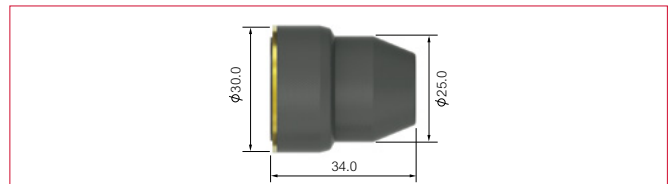

Shield Cap Bodies

SCP 80

Part No.	Description
SCP8031	Shield Cap Body

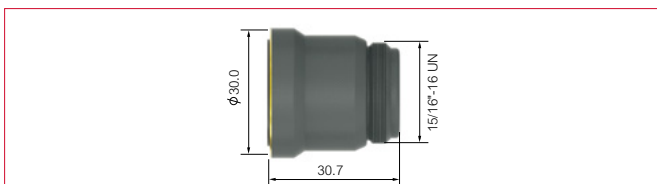

SCP 120R

Part No.	Description
SCP1232	Shield Cap Body



* Denotes torch package standard wear part set-up

Stand off Guides

SCP 25/40/60

Part No.	Description
* SCP2540	Double Pointed Spacer

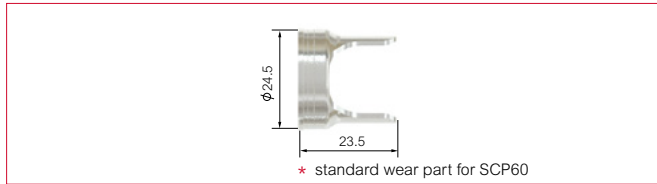

SCP 80

Part No.	Description
* SCP8040	Double Pointed Spacer

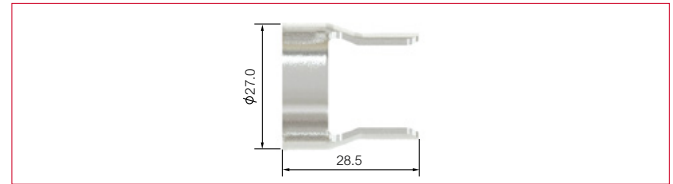

SCP 120R

Part No.	Description
* SCP1240	Double Pointed Spacer

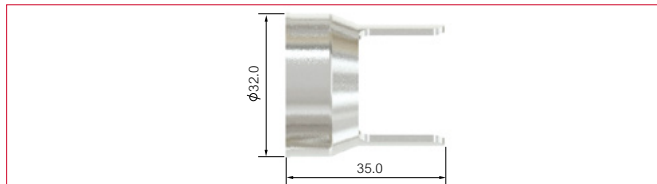

Shield Caps

SCP 80/120R

Part No.	Description
SCP8041	Shield Cap Hand

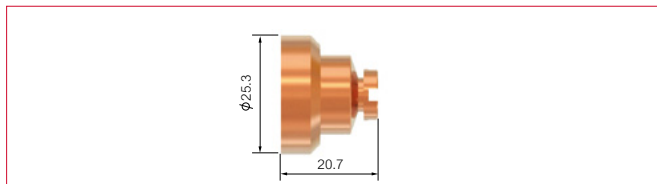

SCP 120R

Part No.	Description
SCP1241	Shield Cap Hand

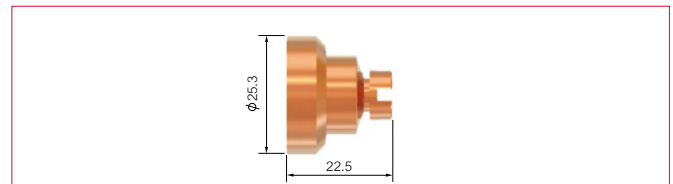

Shield Cap Gouging

SCP 120R

Part No.	Description
SCP8042	Shield Cap Machine

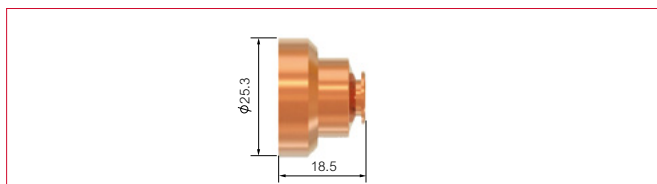

SCP 80/120R

Part No.	Description
SCP8043	Shield Cap Gouging

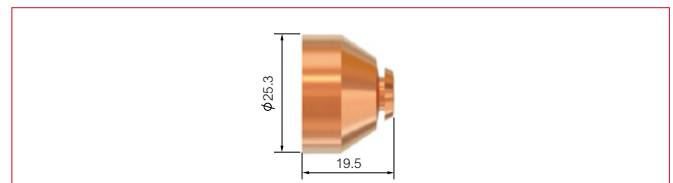

* Denotes torch package standard wear part set-up

Wear Parts

Cooling Tubes

SCP 80

Part No.	Description
* SCP8002	Cooling Tube

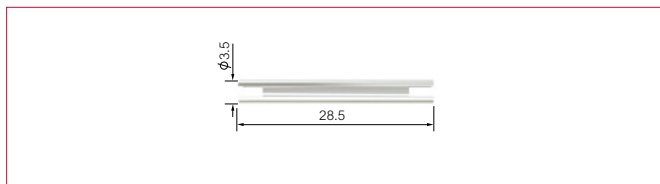

SCP 120R

Part No.	Description
* SCP1202	Cooling Tube

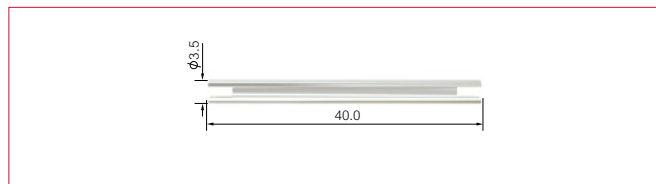

Cutting Buggies

SCP 25/40/60

Part No.	Description
SCP2551	Cutting Buggy

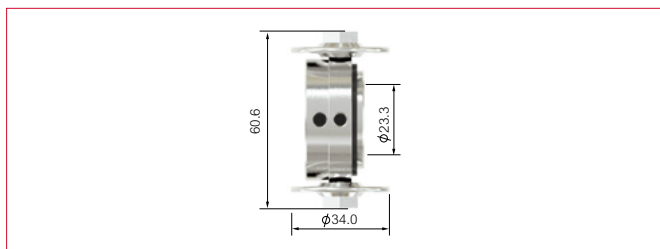

SCP 80

Part No.	Description
SCP8051	Cutting Buggy

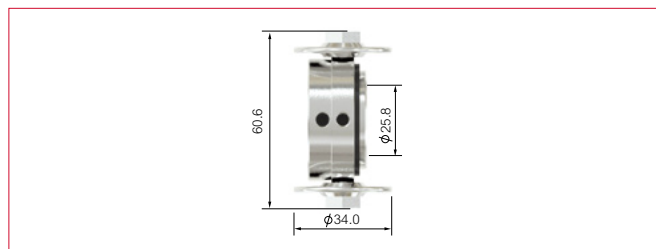

SCP 120R

Part No.	Description
SCP1251	Cutting Buggy

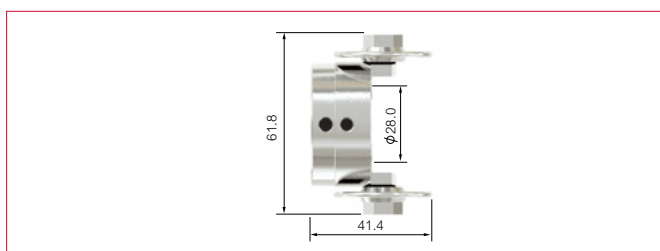

Circle / Cutting Attachment Kits

SCP 25/40/60

Part No.	Description
SCP2550	Circle / Cutting Attachment Kit

SCP 80

Part No.	Description
SCP8050	Circle / Cutting Attachment Kit

SCP 120R

Part No.	Description
SCP1250	Circle / Cutting Attachment Kit



* Denotes torch package standard wear part set-up

Cutting Tips

Part No.	Cross REF	Description
SCP2520-06	51318.06	Cutting Tip
SCP2520-06E	51318L.06	Cutting Tip Extended
SCP2520-08	51318.08	Cutting Tip
SCP2520-08E	51318L.08	Cutting Tip Extended
SCP2520-09	51318.09	Cutting Tip
SCP2522-09	51312P.09	Cutting Tip Cross Groove
SCP2522-09E	51314.09	Cutting Tip Extended Cross Groove
SCP2524-09	51313P.09	Cutting Tip Flat
SCP2524-10	51313P.10	Cutting Tip Flat
SCP2524-11	51313P.11	Cutting Tip Flat
SCP8020-10	51311.10	Cutting Tip
SCP8020-11	51311.11	Cutting Tip
SCP8020-12	51311.12	Cutting Tip
SCP8020-13	51311.13	Cutting Tip
SCP8022-09	51310.09	Cutting Tip Cross Groove
SCP8026-10	51311S.10	Cutting Tip Contact
SCP8026-11	51311S.11	Cutting Tip Contact
SCP8026-12	51311S.12	Cutting Tip Contact
SCP8026-13	51311S.13	Cutting Tip Contact
SCP8028-16	51311G.16	Gouging Tip
SCP1220-10	51246.10	Cutting Tip
SCP1220-11	51246.11	Cutting Tip
SCP1220-12	51246.12	Cutting Tip
SCP1221-14	51248.14	Cutting Tip
SCP1221-15	51248.15	Cutting Tip
SCP1221-16	51248.16	Cutting Tip
SCP1222-09	51245.09	Cutting Tip Contact
SCP1226-10	51276.10	Cutting Tip Contact
SCP1226-11	51276.11	Cutting Tip Contact
SCP1226-12	51276.12	Cutting Tip Contact
SCP1227-14	51278.14	Cutting Tip Contact
SCP1227-15	51278.15	Cutting Tip Contact
SCP1227-16	51278.16	Cutting Tip Contact
SCP1228-22	51278G.22	Gouging Tip

Electrodes

Part No.	Cross REF	Description
SCP2504	52582	Electrode
SCP2504E	52583	Electrode Extended
SCP8004	52558	Electrode
SCP1204	52556	Electrode

Swirl Rings

Part No.	Cross REF	Description
SCP2506	60028	Swirl Ring
SCP8006	60027	Swirl Ring
SCP1206	60026	Swirl Ring
SCP1207	60025	Swirl Ring

Cooling Tubes

Part No.	Cross REF	Description
SCP8002	09800.42	Cooling Tube
SCP1202	09700.48	Cooling Tube

Retaining Caps

Part No.	Cross REF	Description
SCP2530-1	60389K1	Retaining Cap, 1 Hole
SCP2530-2	60389K	Retaining Cap, 2 Holes
SCP2530-4	60389K4	Retaining Cap, 4 Holes
SCP2530-6	60389.00	Retaining Cap, 6 Holes
SCP2530-6L	60389S	Retaining Cap, 6 Holes, Maximum Life
SCP8030	60510	Retaining Cap
SCP1230	60500	Retaining Cap
SCP1231	60501	Retaining Cap

Shield Cap Bodies

Part No.	Cross REF	Description
SCP8031	60511	Shield Cap Body
SCP1232	60502	Shield Cap Body

Shield Caps / Shield Cap Gouging

Part No.	Cross REF	Description
SCP8041	60504	Shield Cap Hand
SCP1241	60505	Shield Cap Hand
SCP8042	60506	Shield Cap Machine
SCP8043	60508	Shield Cap Gouging

Stand Off Guides

Part No.	Cross REF	Description
SCP2540	60432	Double Pointed Spacer
SCP8040	60434	Double Pointed Spacer
SCP1240	60444	Double Pointed Spacer

Cutting Buggies

Part No.	Cross REF	Description
SCP2551	51823	Cutting Buggy
SCP8051	51809	Cutting Buggy
SCP1251	51802	Cutting Buggy

Circle / Cutting Attachment Kits

Part No.	Cross REF	Description
SCP2550	51866	Circle Cutting Attachment Kit
SCP8050	51853	Circle Cutting Attachment Kit
SCP1250	51864	Circle Cutting Attachment Kit

Torch Head Kits

Part No.	Cross REF	Description
SCP2501	09601	SCP25 70° Torch Head Kit
SCP4001	09602	SCP40 70° Torch Head Kit
SCP6001	09603	SCP60 70° Torch Head Kit
SCP8001	09800	SCP80 70° Torch Head Kit
SCP1201	09700	SCP120 70° Torch Head Kit

Contents

Suregrip TRF Plasma Cutting Torch Range Features Focus	22
Suregrip TRF Plasma Cutting Torch Range Overview and Ratings	24

Torch Range

Air-Cooled	Suregrip TRF Plasma STR S25K	26
	Suregrip TRF Plasma STR S45	27
	Suregrip TRF Plasma STR A81	28
	Suregrip TRF Plasma STR A81R	29
	Suregrip TRF Plasma STR A101R	30
	Suregrip TRF Plasma STR A141R	32
	Suregrip TRF Plasma STR A151R	34

Wear Parts

Cutting Tips	36
Electrodes	37
Swirl Rings	38
Retaining Caps	39
Shield Cap Bodies	39
Stand off Guides	40
Shield Caps	40
Spacers for Gouging	41
Spacers for Contact Cutting	41
Locking Nuts	42
Cooling Tubes	42
Cutting Buggies	43
Circle / Cutting Attachment Kits	43

Cross Reference Table	44
------------------------------	-----------

Suregrip TRF Plasma Cutting Torch Range

Air-Cooled Features Focus

Air-Cooled

A comprehensive range of torches that utilize back striking technology with and without the use of high frequency.

Dynamic Engineering and Superior Design Ergonomics



100% Trafimet® Compatibility Guaranteed

Quality Wear Parts

All wear parts are manufactured to the same specification as the original manufacturer ensuring reliability, longevity and superior performance

Safety Systems

A twin “fail-safe” system located beneath the shield cap ensures the torch cannot be activated if the cap is removed

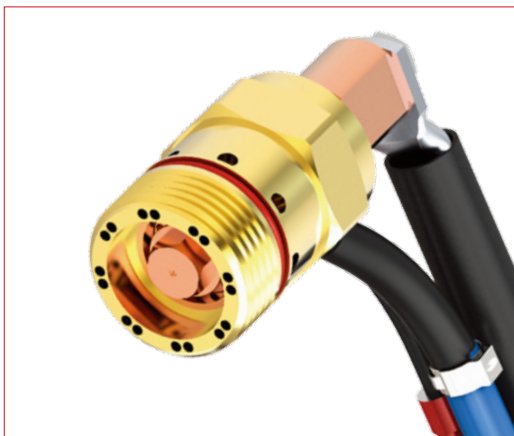
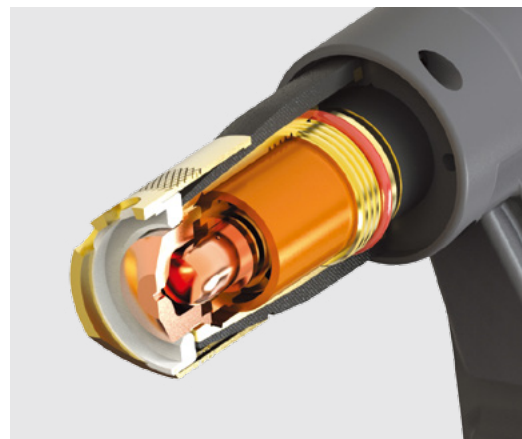

Torch Bodies

Produced from precision tolerance and machined aerospace polymers

Features Focus

Cutting Tools for the Professional



Ergonomics – For Comfort and Handleability

- Large surface area grips improve positionability and operator comfort
- Cable supports are designed to offer the greatest flexibility

Trigger System

A patented slide to operate switch system is easy to operate and prevents accidental torch ignition



Terminations

Terminations available for separate and central connector cable types



The Smart Way To Buy Welding and Cutting Tools

Suregrip TRF Plasma Cutting Torch Range

Ratings: 25 Amp to 150 Amp



Model	STR S25K	STR S45	STR A81	STR A81R
Technical Data				
Cooling Method	Air-Cooled	Air-Cooled	Air-Cooled	Air-Cooled
Rating:	25A	40A	80A	80A
Cutting Thickness	6-8mm	8-12mm	20-25mm	20-25mm
Duty Cycle:	60%	60%	60%	60%
Gas	Air/N ₂	Air/N ₂	Air/N ₂	Air/N ₂
Gas Pressure	2.8 bar 40 psi	4.5-5.0 bar 65-75 psi	4.5-5.0 bar 65-75 psi	4.5-5.0 bar 65-75 psi
Gas Flow	40 l/min 85 scfh	100 l/min 210 scfh	160 l/min 340 scfh	160 l/min 340 scfh
Pilot	Electrode to Tip	Electrode to Tip	Electrode to Tip	Electrode to Tip
Ignition	Without HF	Without HF	HF	HF
Post Flow	90 sec	90 sec	90 sec	90 sec

Suregrip TRF Plasma Cutting Torch Range

Ratings: 25 Amp to 150 Amp



Model	STRA101R	STRA141R	STRA151R
Technical Data			
Cooling Method	Air-Cooled	Air-Cooled	Air-Cooled
Rating:	100A	140A	150A
Cutting Thickness	25-30mm	35-40mm	35-40mm
Duty Cycle:	60%	60%	60%
Gas	Air/N ₂	Air/N ₂	Air/N ₂
Gas Pressure	4.5-5.0 bar 65-75 psi	4.5-5.0 bar 65-75 psi	4.5-5.0 bar 65-75 psi
Gas Flow	180 l/min 380 scfh	220 l/min 470 scfh	220 l/min 470 scfh
Pilot	Electrode to Tip	Electrode to Tip	Electrode to Tip
Ignition	HF	HF	HF
Post Flow	90 sec	90 sec	90 sec

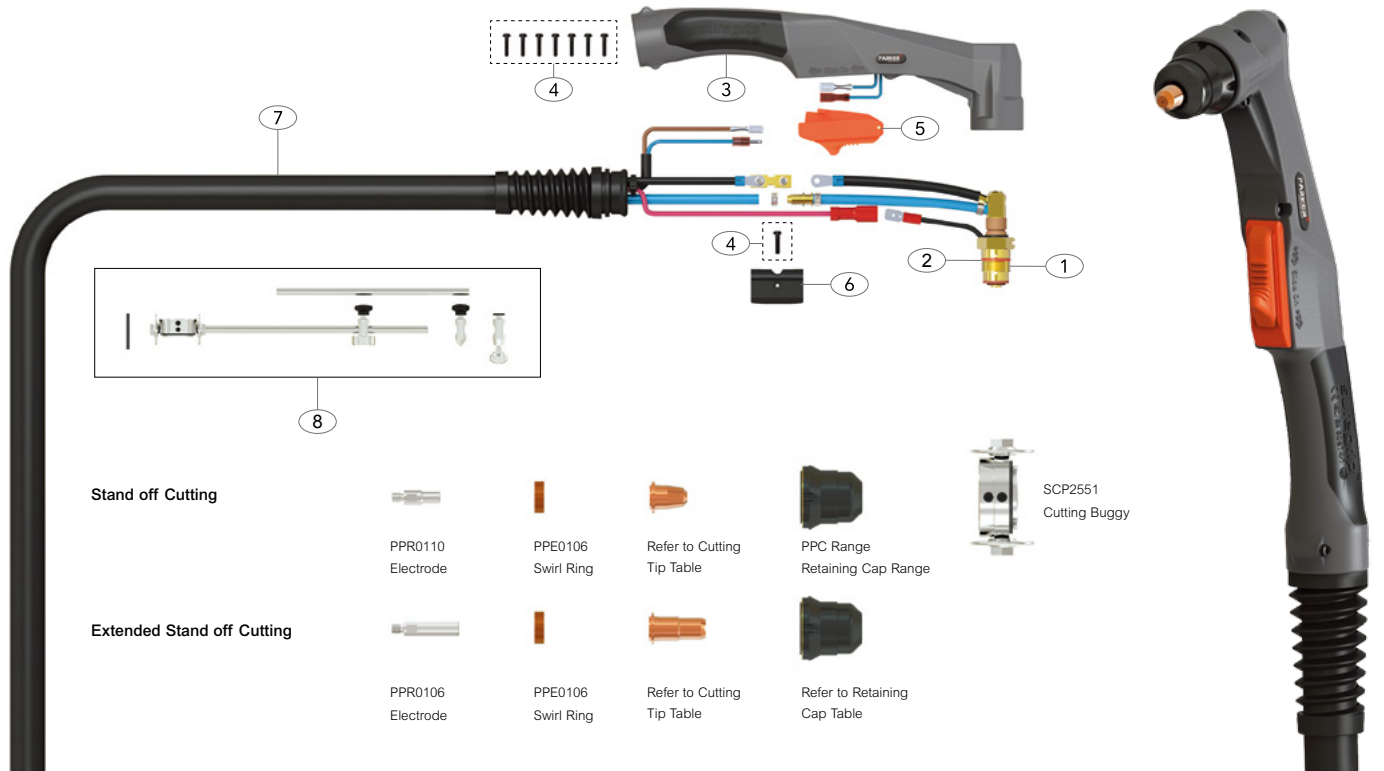

Stand off Cutting

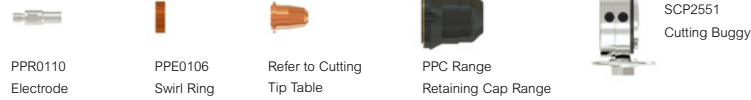

Extended Stand off Cutting



Model

Description	Part No.
Suregrip TRF Plasma Cutting Torch Package	6mt
	STR S25K-60-CF1

Wear Parts

Cutting Tips

Part No.	Description	Bore \varnothing A	Amps
* PPD0116-06	Cutting Tip	0.6mm	25A
PPD0103-65	Cutting Tip	0.65mm	25A

Retaining Caps

Part No.	Description
* PPC0117	Retaining Cap, 2 Holes

Spare Parts

Part No.	Description
1 STR2501	STR25 70° Torch Head Kit
2 SCP2508	O Ring
3 SGP2514	Plasma Handle Kit
4 SCPSP1	Screw Pack
5 SCP2516	Plasma Safety Trigger
6 SCP2515	Location Block
7 * SCP2519-60-CF1	Cable Assembly Complete x 6mt
8 SCP2550	Circle Cutting Attachment Kit

CF1

*Denotes torch package standard wear part set-up
For more information please refer to the following sections:
*Master Wear Parts Table Page 36-43

STR S45 Suregrip TRF Plasma Cutting Torch Range

Rating: 40A Air/N₂ gas, @ 60% duty cycle.

Air-Cooled Cutting Torch Range

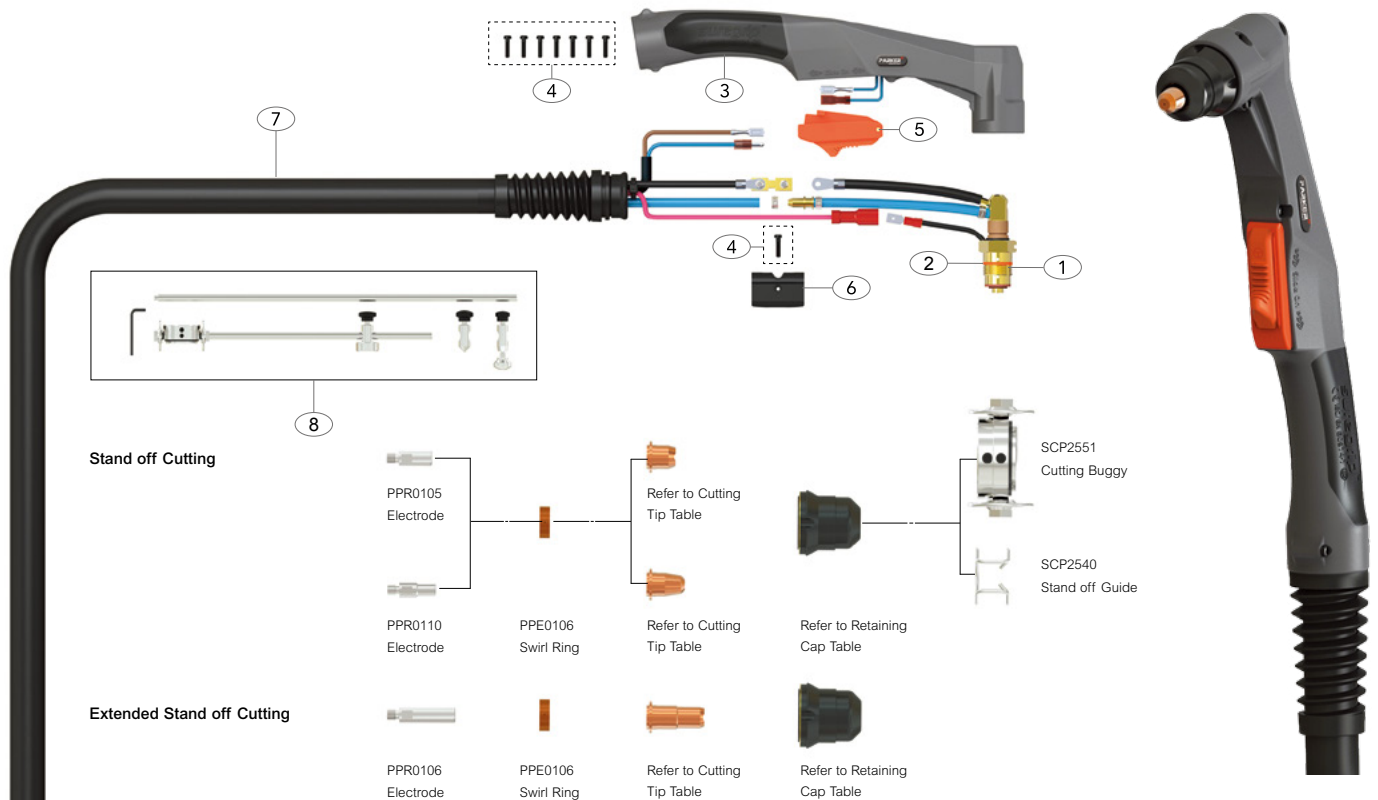

Stand off Cutting



Extended Stand off Cutting



Model

Description	Part No.
Suregrip TRF Plasma Cutting Torch Package	6mt
	STR S45-60-CF2

Wear Parts

Cutting Tips

Part No.	Description	Bore ϕ A	Amps
*PPD0116-08	Cutting Tip	0.8mm	30A
PPD0102-10	Cutting Tip	1.0mm	50A
PPD0103-09	Cutting Tip Extended	0.9mm	40A

Retaining Caps

Part No.	Description
*PPC0116	Retaining Cap, 6 Holes

Spare Parts

Part No.	Description
1 STR4001	STR40 70° Torch Head Kit
2 SCP2508	O Ring
3 SGP2514	Plasma Handle Kit
4 SCPSP1	Screw Pack
5 SCP2516	Plasma Safety Trigger
6 SCP2515	Location Block
7 *SCP4019-60-CF2	Cable Assembly Complete x 6mt
8 SCP2550	Circle Cutting Attachment Kit

CF2

*Denotes torch package standard wear part set-up
For more information please refer to the following sections:
•Master Wear Parts Table Page 36-43

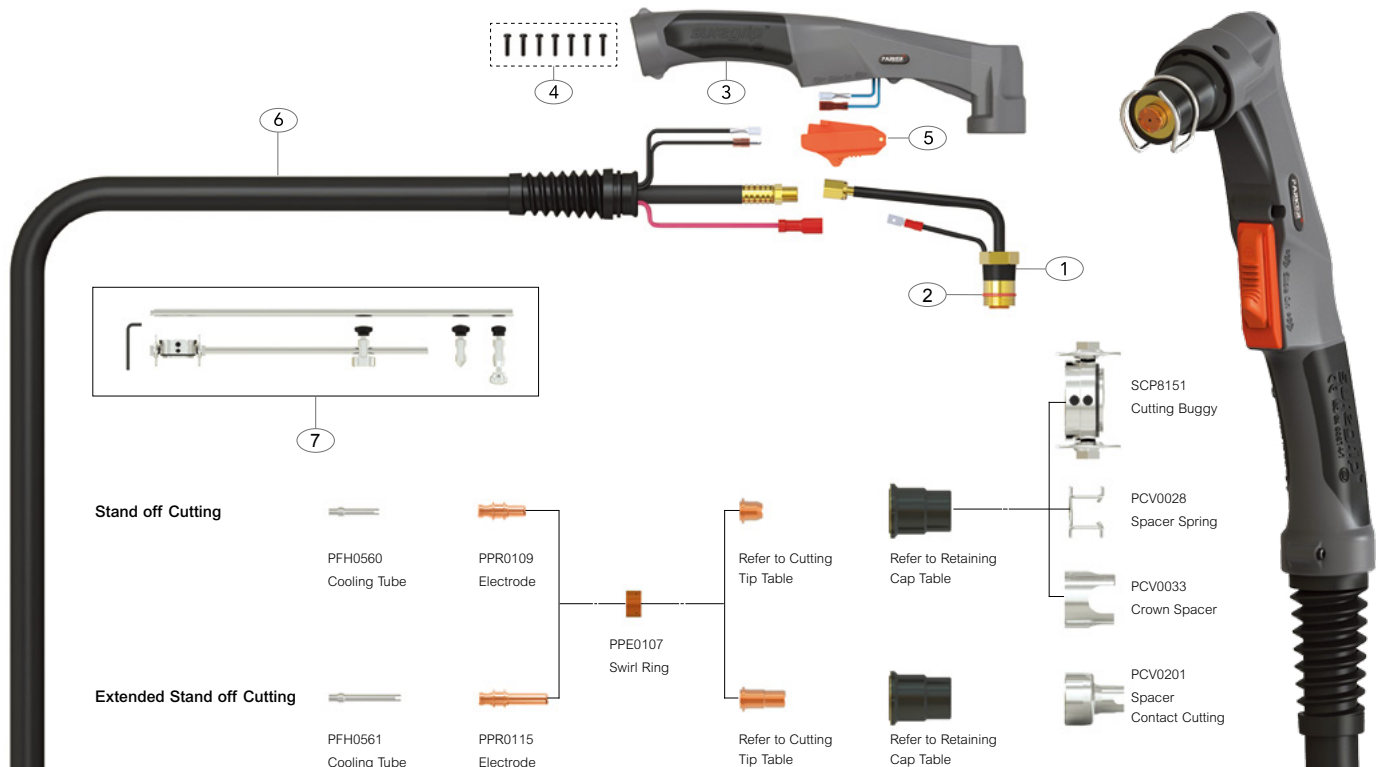

Model

Description	Part No.
Suregrip TRF Plasma Cutting Torch Package	6mt STR A81-60-CF9

Wear Parts

Cutting Tips

Part No.	Description	Bore ϕ A	Amps
*PPD0105-10	Cutting Tip	1.0mm	50A
PPD0105-11	Cutting Tip	1.1mm	60A
PPD0105-12	Cutting Tip	1.2mm	70A
PPD0106-10	Cutting Tip Extended	1.0mm	50A
PPD0106-12	Cutting Tip Extended	1.2mm	70A

Retaining Caps

Part No.	Description
*PPC0115	Retaining Cap

Spare Parts

Part No.	Description
1 STR0140	STR81 70° Torch Head Kit
2 SCP8008	O Ring
3 SCP8014/HF	Plasma Handle Kit
4 SCSP1	Screw Pack
5 SCP2516	Plasma Safety Trigger
6 *SCP8119-60-CF9	Cable Assembly Complete x 6mt
7 PCV0052	Circle Cutting Attachment Kit

CF9

*Denotes torch package standard wear part set-up
For more information please refer to the following sections:
*Master Wear Parts Table Page 36-43

STR A81R Suregrip TRF Plasma Cutting Torch Range

Rating: 80A Air/N₂ gas, @ 60% duty cycle.

Air-Cooled Cutting Torch Range

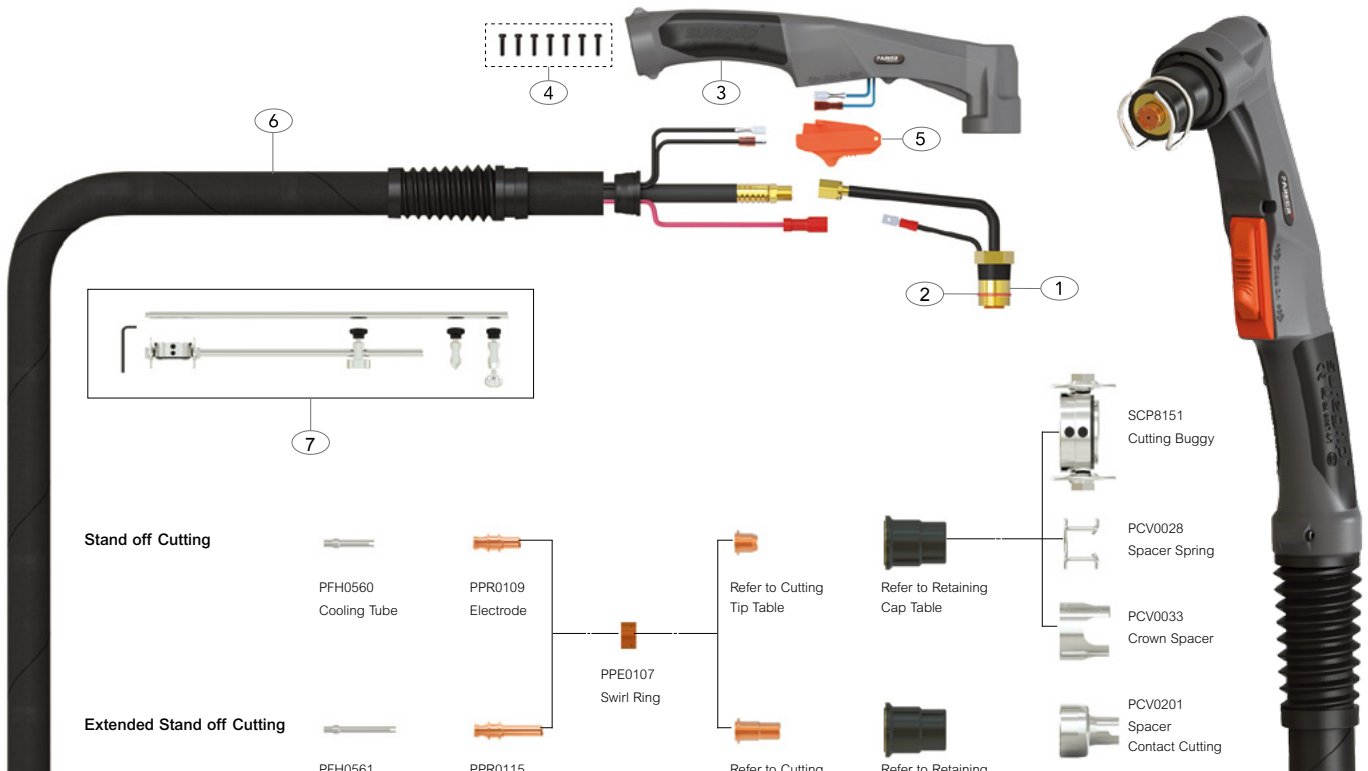

Stand off Cutting

PFH0560
Cooling Tube

PPR0109
Electrode

PPE0107
Swirl Ring

Refer to Cutting
Tip Table

Refer to Retaining
Cap Table

SCP8151
Cutting Buggy

PCV0028
Spacer Spring

PCV0033
Crown Spacer

Extended Stand off Cutting

PFH0561
Cooling Tube

PPR0115
Electrode

Refer to Cutting
Tip Table

Refer to Retaining
Cap Table

PCV0201
Spacer
Contact Cutting

Model

Description	Part No.
Suregrip TRF Plasma Cutting Torch Package	6mt
	STR A81R-60-CF9

Wear Parts

Cutting Tips

Part No.	Description	Bore ϕ A	Amps
*PPD0105-10	Cutting Tip	1.0mm	50A
PPD0105-11	Cutting Tip	1.1mm	60A
PPD0105-12	Cutting Tip	1.2mm	70A
PPD0106-10	Cutting Tip Extended	1.0mm	50A
PPD0106-12	Cutting Tip Extended	1.2mm	70A

Retaining Caps

Part No.	Description
*PPC0115	Retaining Cap

Spare Parts

Part No.	Description
1 STR0140	STR81 70° Torch Head Kit
2 SCP8008	O Ring
3 SCP8014/HF	Plasma Handle Kit
4 SCSP1	Screw Pack
5 SCP2516	Plasma Safety Trigger
6 *SCP8119-60-CF9	Cable Assembly Complete x 6mt
7 PCV0052	Circle Cutting Attachment Kit

*Denotes torch package standard wear part set-up
For more information please refer to the following sections:
•Master Wear Parts Table Page 36-43

CF9

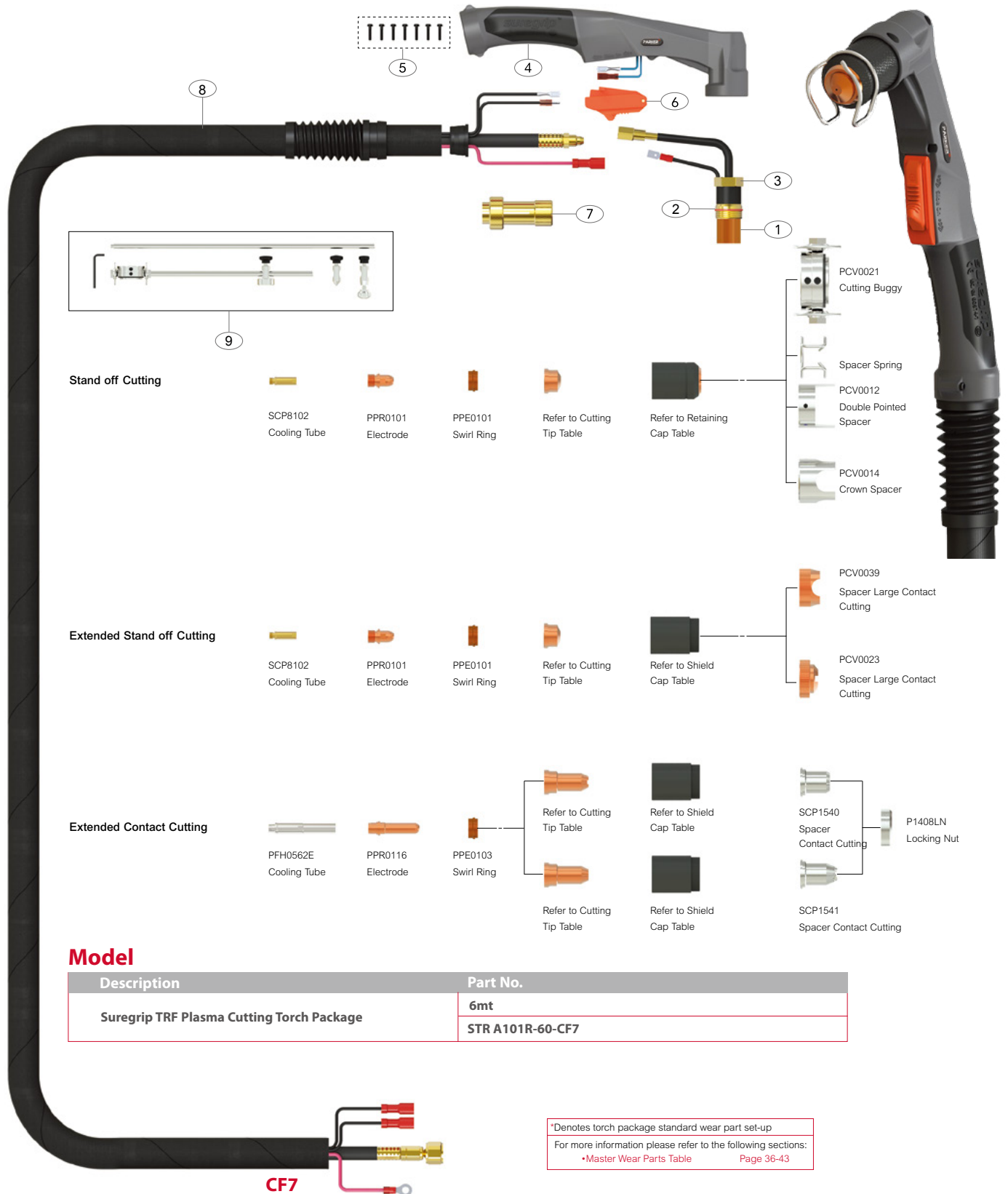

STR A101R Suregrip TRF Plasma Cutting Torch Range

Rating: 100A Air/N₂ gas, @ 60% duty cycle.

Air-Cooled Cutting Torch Range



Wear Parts

Cutting Tips

Part No.	Description	Bore Ø A	Amps
PPD0101-11	Cutting Tip	1.1mm	60A
PPD0101-14	Cutting Tip	1.4mm	90A
PPD0101-17	Cutting Tip	1.7mm	140A
* PPD0111-12	Cutting Tip Extended	1.2mm	70A
PPD0117-14	Cutting Tip Extended	1.4mm	90A
PPD0117-17	Cutting Tip Extended	1.7mm	140A
PPD0117-19	Cutting Tip Extended	1.9mm	150A

Retaining / Shield Caps

Part No.	Description
* PPC0111	Retaining Cap, Long Life
PPC0130	Shield Cap Body Max.Life

Spare Parts

Part No.	Description
1	SCP1003 Front Insulation
2	SCP1008 O Ring
3	STR0145 STR101 70° Torch Head Kit
4	SCP8014/HF Plasma Handle Kit
5	SCPSP1 Screw Pack
6	SCP2516 Plasma Safety Trigger
7	PGR60 Extractor For Swirl Ring
8	*SCP10119-60-CF7 Cable Assembly Complete x 6mt
9	PCV0022 Circle Cutting Attachment Kit



Stand off Cutting

SCP1412 Cooling Tube	PPR0101 Electrode	PPE0101 Swirl Ring	Refer to Cutting Tip Table	Refer to Retaining Cap Table	PCV0021 Cutting Buggy
					PCV0011 Spacer Spring
					PCV0012 Double Pointed Spacer
					PCV0014 Crown Spacer

Contact Cutting

SCP1412 Cooling Tube	PPR0101 Electrode	PPE0101 Swirl Ring	Refer to Cutting Tip Table	Refer to Retaining Cap Table	PCV0039 Spacer Large Contact Cutting
					PCV0023 Spacer Large Contact Cutting

Extended Contact Cutting

PFH0563E Cooling Tube	PPR0116 Electrode	PPE0103 Swirl Ring	Refer to Cutting Tip Table	Refer to Retaining Cap Table	SCP1540 Spacer Contact Cutting
			Refer to Cutting Tip Table	Refer to Retaining Cap Table	P1408LN Locking Nut
					SCP1541 Spacer Contact Cutting

Gouging

SCP1412 Cooling Tube	PPR0101 Electrode	PPE0101 Swirl Ring	Refer to Cutting Tip Table	Refer to Retaining Cap Table	PCV0013 Spacer Gouging
-------------------------	----------------------	-----------------------	-------------------------------	---------------------------------	---------------------------

Model

Description	Part No.
Suregrip TRF Plasma Cutting Torch Package	6mt
	STR A141R-60-CF7

CF7

*Denotes torch package standard wear part set-up
For more information please refer to the following sections:
•Master Wear Parts Table Page 36-43

STR A141R Suregrip TRF Plasma Cutting Torch Range

Rating: 140A Air/N₂ gas, @ 60% duty cycle.

Air-Cooled Cutting Torch Range



Wear Parts

Cutting Tips

Part No.	Description	Bore Ø A	Amps
PPD0101-11	Cutting Tip	1.1mm	60A
PPD0101-14	Cutting Tip	1.4mm	90A
* PPD0101-17	Cutting Tip	1.7mm	140A
PPD0111-12	Cutting Tip Extended	1.2mm	70A
PPD0117-14	Cutting Tip Extended	1.4mm	90A
PPD0117-17	Cutting Tip Extended	1.7mm	140A
PPD0117-19	Cutting Tip Extended	1.9mm	150A
PPD0101-19	Cutting Tip	1.9mm	150A
PPD0101-30	Gouging Tip	3.0mm	150A

Retaining / Shield Caps

Part No.	Description
* PPC0102	Retaining Cap, Long Life
PPC0131	Shield Cap Body Max.Life

Spare Parts

Part No.	Description
1 SCP1503	Front Insulation
2 SCP1008	O Ring
3 STR0155	STR141 70° Torch Head Kit
4 SCP8014C/HF	Plasma Handle Kit
5 SCPSP1	Screw Pack
6 SCP2516	Plasma Safety Trigger
7 PGR60	Extractor For Swirl Ring
8 *SCP10119C-60-CF7	Cable Assembly Complete x 6mt
9 PCV0022	Circle Cutting Attachment Kit

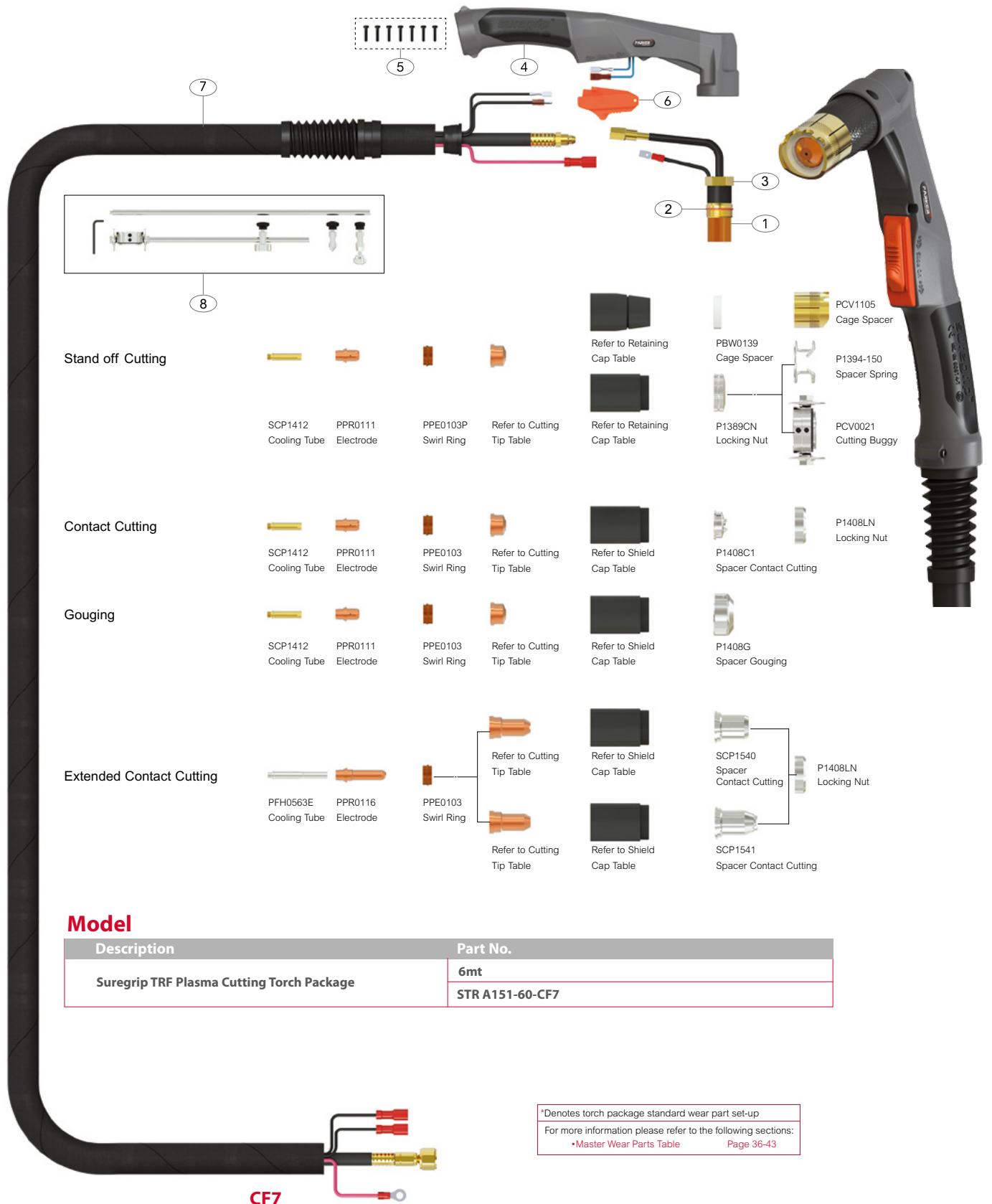

Model

Description	Part No.
Suregrip TRF Plasma Cutting Torch Package	6mt
	STRA151-60-CF7

*Denotes torch package standard wear part set-up
For more information please refer to the following sections:
•Master Wear Parts Table Page 36-43

CF7

STR A151R Suregrip TRF Plasma Cutting Torch Range

Rating: 150A Air/N₂ gas, @ 60% duty cycle.

Air-Cooled Cutting Torch Range



Wear Parts

Cutting Tips

Part No.	Description	Bore Ø A	Amps
PPD0109-14	Cutting Tip	1.4mm	90A
PPD0109-16	Cutting Tip	1.6mm	120A
* PPD0109-18	Cutting Tip	1.8mm	150A
PPD0109-30	Gouging Tip	3.0mm	150A
PPD0111-12	Cutting Tip Extended	1.2mm	70A
PPD0117-14	Cutting Tip Extended	1.4mm	90A
PPD0117-17	Cutting Tip Extended	1.7mm	140A
PPD0117-19	Cutting Tip Extended	1.9mm	150A

Retaining / Shield Caps

Part No.	Description
* PPC0120	Retaining Cap
PPC0131	Shield Cap Body Max.Life

Spare Parts

Part No.	Description
1 SCP1503	Front Insulation
2 SCP1008	O Ring
3 STR0160	STR151 70° Torch Head Kit
4 SCP8014/HF	Plasma Handle Kit
5 SCPSP1	Screw Pack
6 SCP2516	Plasma Safety Trigger
7 *SCP10119-60-CF7	Cable Assembly Complete x 6mt
8 PCV0022	Circle Cutting Attachment Kit

STR S25K

Part No.	Description	Bore ϕ A	Amps
* PPD0116-06	Cutting Tip	0.6mm	25A

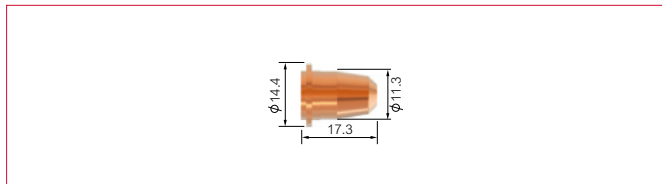

PPD0103-65	Cutting Tip	0.65mm	25A
------------	-------------	--------	-----

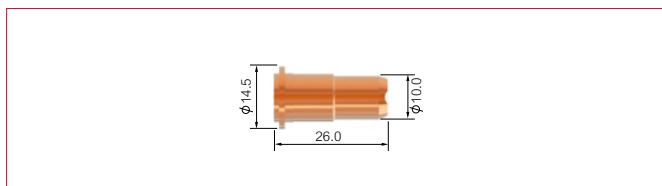

STR A81

Part No.	Description	Bore ϕ A	Amps
PPD0105-10	Cutting Tip	1.0mm	50A
PPD0105-11	Cutting Tip	1.1mm	60A
* PPD0105-12	Cutting Tip	1.2mm	70A

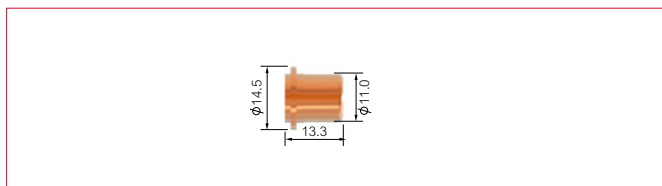

PPD0106-10	Cutting Tip Extended	1.0mm	50A
PPD0106-12	Cutting Tip Extended	1.2mm	70A

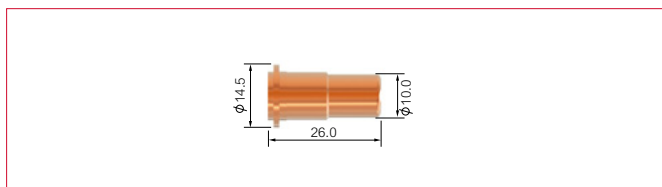

STR S45

Part No.	Description	Bore ϕ A	Amps
* PPD0116-08	Cutting Tip	0.8mm	30A

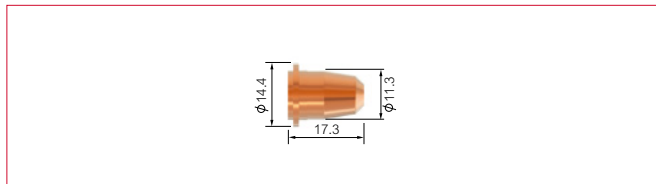

PPD0102-10	Cutting Tip	1.0mm	50A
------------	-------------	-------	-----

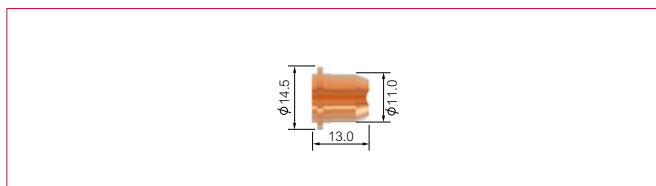

PPD0103-09	Cutting Tip Extended	0.9mm	40A
------------	----------------------	-------	-----

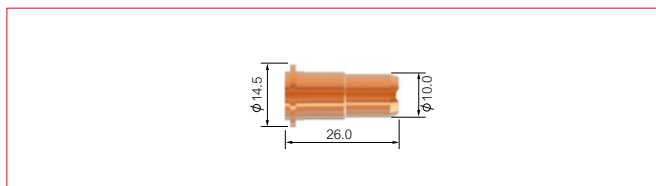

STR A141R

Part No.	Description	Bore ϕ A	Amps
* PPD0101-19	Cutting Tip	1.9mm	150A

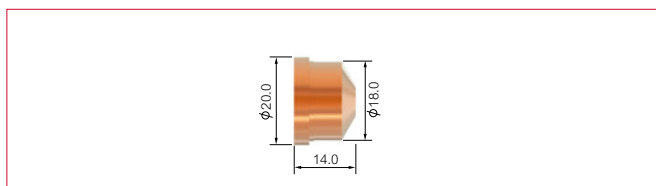

* PPD0101-30	Gouging Tip	3.0mm	150A
--------------	-------------	-------	------

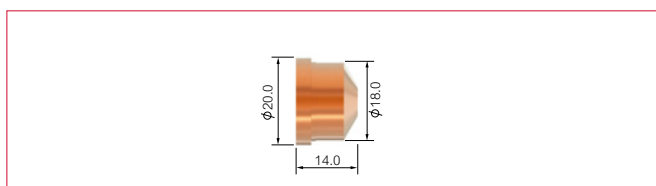

* Denotes torch package standard wear part set-up

Cutting Tips

STR A101R/A141R

Part No.	Description	Bore ϕ A	Amps
PPD0101-11	Cutting Tip	1.1mm	60A
PPD0101-14	Cutting Tip	1.4mm	90A
* PPD0101-17	Cutting Tip	1.7mm	140A

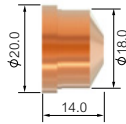

STR A151R

Part No.	Description	Bore ϕ A	Amps
PPD0109-30	Gouging Tip	3.0mm	150A

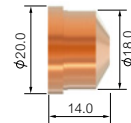

STR A151R

Part No.	Description	Bore ϕ A	Amps
PPD0109-14	Cutting Tip	1.4mm	90A
PPD0109-16	Cutting Tip	1.6mm	120A
* PPD0109-18	Cutting Tip	1.8mm	150A

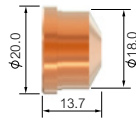

STR A101R/A141R/A151R

Part No.	Description	Bore ϕ A	Amps
PPD0111-12	Cutting Tip Extended	1.2mm	70A

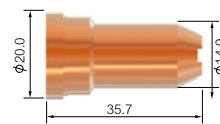

PPD0117-14	Cutting Tip Extended	1.4mm	90A
PPD0117-17	Cutting Tip Extended	1.7mm	140A
PPD0117-19	Cutting Tip Extended	1.9mm	150A

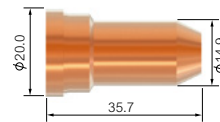

Electrodes

STR S25K/S45

Part No.	Description
* PPR0110	Electrode

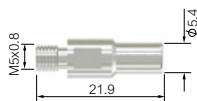

PPR0106	Electrode
---------	-----------

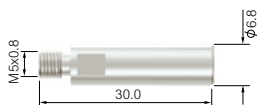

STR A81

Part No.	Description
* PPR0109	Electrode

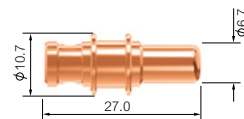

PPR0115	Electrode Extended
---------	--------------------

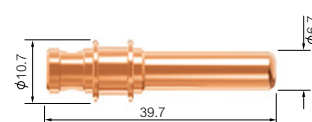

* Denotes torch package standard wear part set-up

STR S45

Part No.	Description
PPR0105	Electrode

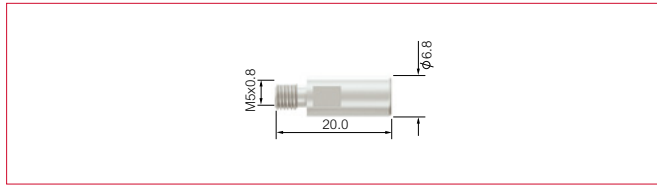

STR A101R/A141R

Part No.	Description
* PPR0101	Electrode

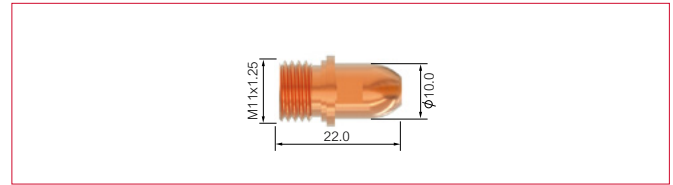

STR A151R

Part No.	Description
* PPR0111	Electrode

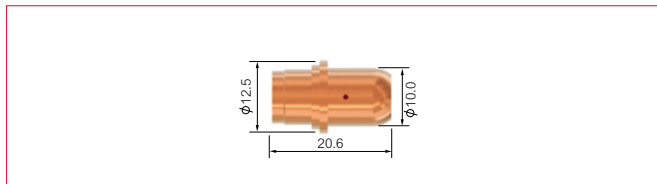

STR A101R/A141R/A151R

Part No.	Description
PPR0116	Electrode Extended

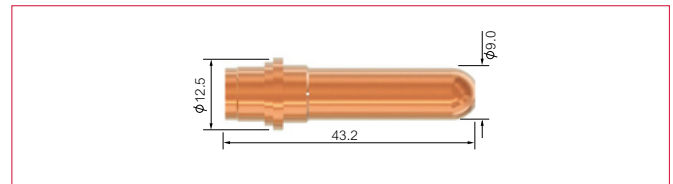

Swirl Rings

STR S25K/S45

Part No.	Description
* PPE0106	Swirl Ring

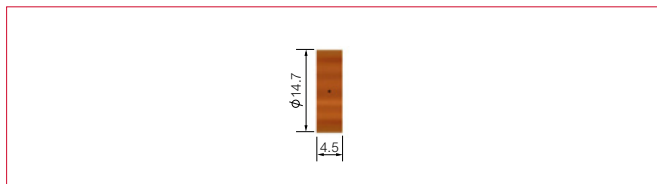

STR A81

Part No.	Description
* PPE0107	Swirl Ring

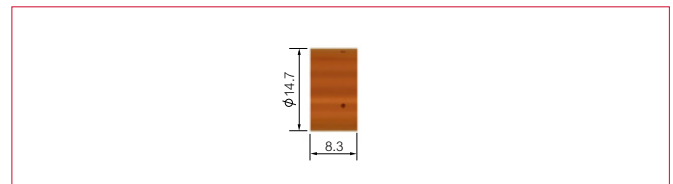

STR A101R/A141R

Part No.	Description
* PPE0101	Swirl Ring

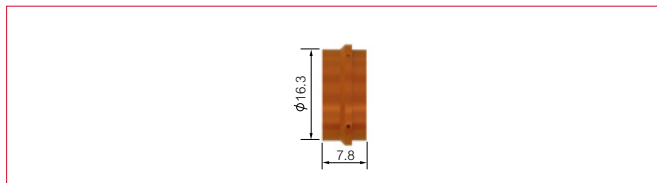

STR A101R/A141R/A151R

Part No.	Description
* PPE0103	Swirl Ring

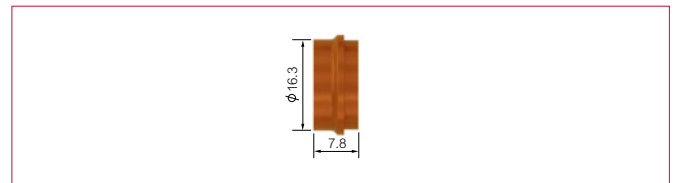

* Denotes torch package standard wear part set-up

Retaining Caps

STR S25K

Part No.	Description
* PPC0117	Retaining Cap, 2 Holes



STR S45

Part No.	Description
* PPC0116	Retaining Cap, 6 Holes

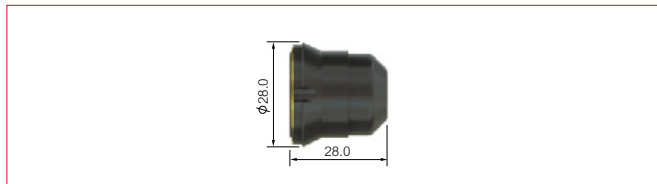

STR A81

Part No.	Description
* PPC0115	Retaining Cap

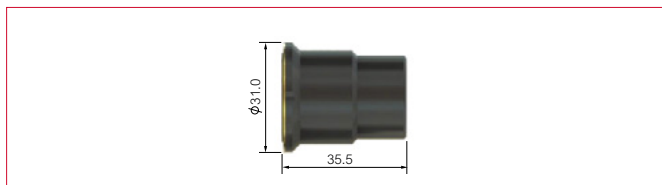

STR A101R

Part No.	Description
* PPC0111	Retaining Cap, Long Life

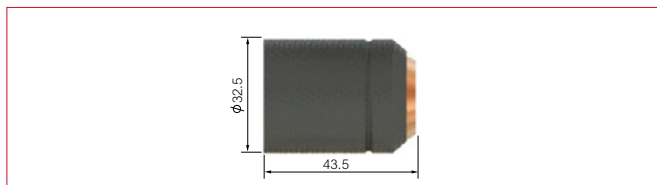

STR A141R

Part No.	Description
* PPC0102	Retaining Cap, Long Life

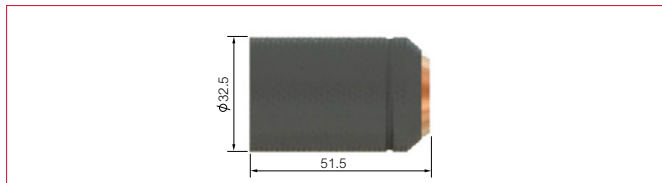

STR A151R

Part No.	Description
* PPC0120	Retaining Cap

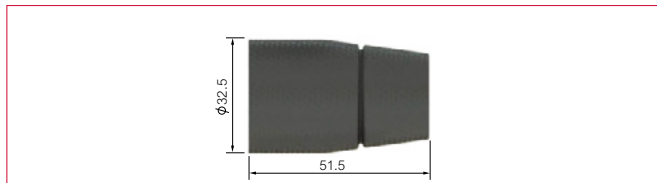

Shield Cap Bodies

STR A101R

Part No.	Description
PPC0130	Shield Cap Body Max.Life

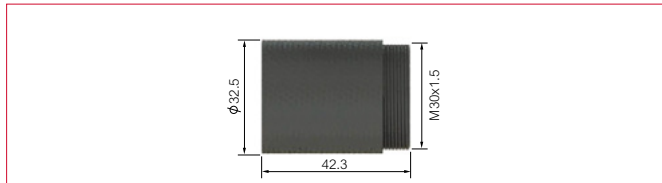

STR A141R/A151R

Part No.	Description
PPC0131	Shield Cap Body Max.Life

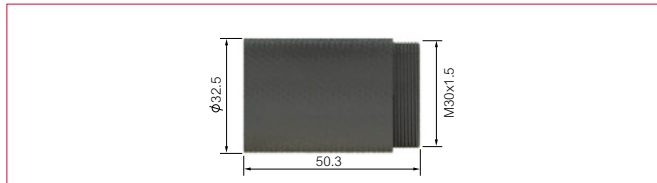

* Denotes torch package standard wear part set-up

Stand off Guides

STR S45

Part No.	Description
* SCP2540	Double Pointed Spacer

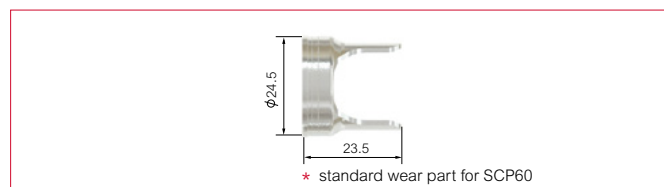

STR A81

Part No.	Description
PCV0033	Spacer Crown

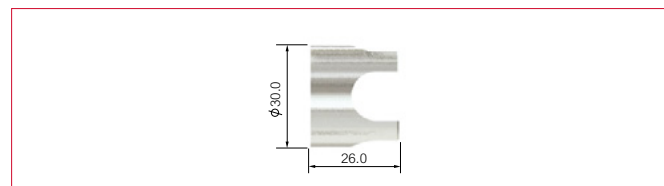

* PCV0028	Spacer Spring
-----------	---------------

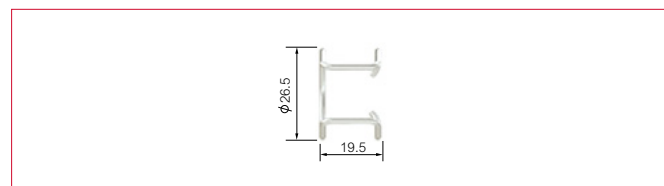

STR A151R

Part No.	Description
P1394-150	Spacer Spring

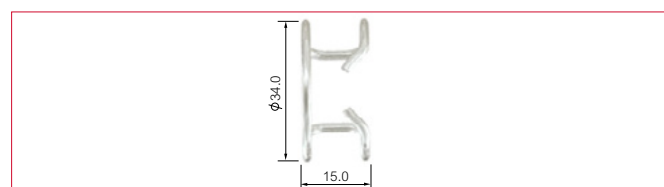

* PCV1105	Spacer Cage
-----------	-------------

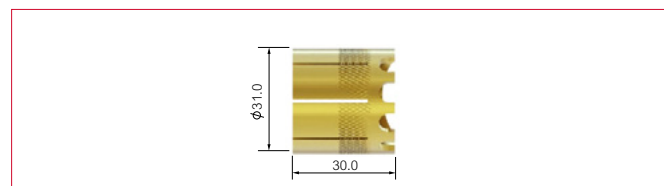

* Denotes torch package standard wear part set-up

STR A101R/A141R

Part No.	Description
* PCV0011	Spacer Spring

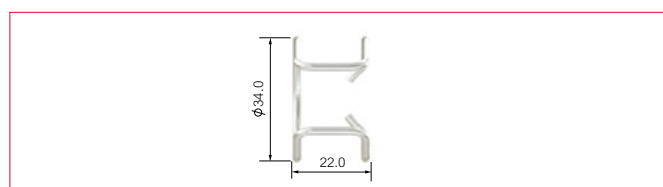

PCV0012	Spacer Double Pointed
---------	-----------------------

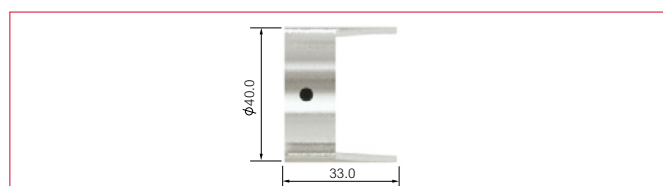

PCV0014	Spacer Crown
---------	--------------

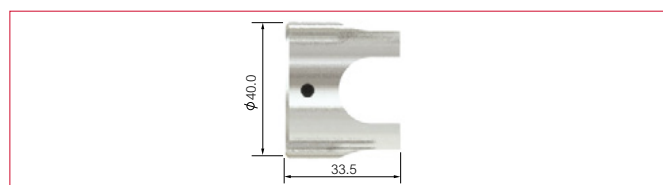

STR S45

Part No.	Description
* SCP2540	Double Pointed Spacer

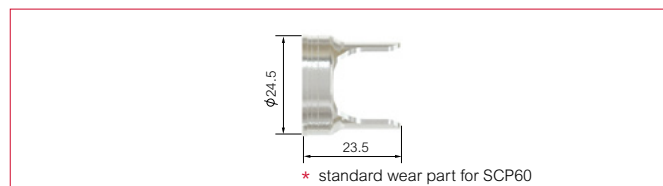

Shield Caps

STR A151R

Part No.	Description
* PBW0139	Nozzles Shield

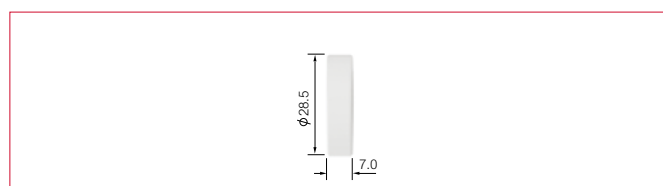

Spacer for Gouging

STR A141R/A151R

Part No.	Description
PCV0013	Spacer Gouging

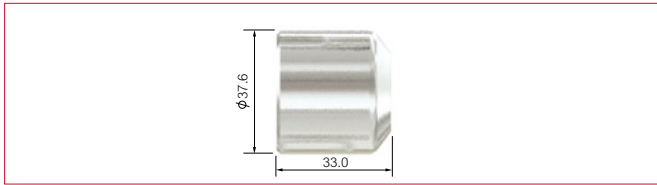

STR A151R

Part No.	Description
P1408G	Spacer Gouging

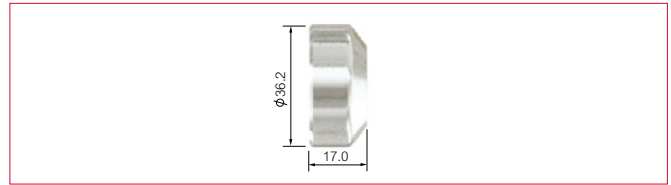

Spacer for Contact Cutting

STR A81

Part No.	Description
PCV0201	Spacer Contact Cutting

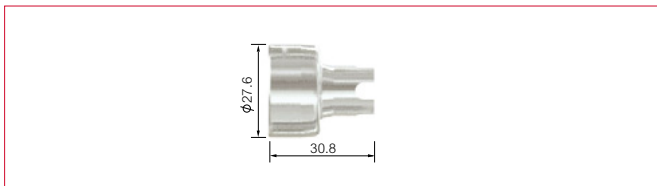

STR A101R/A141R

Part No.	Description
PCV0023	Spacer Contact Cutting

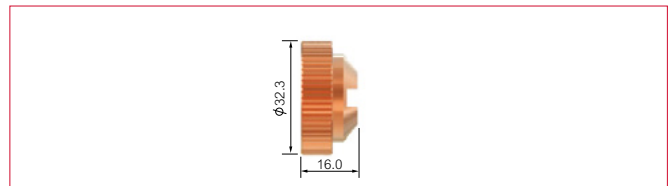

STR A101R/A141R/A151R

Part No.	Description
PCV0008	Spacer Contact Cutting

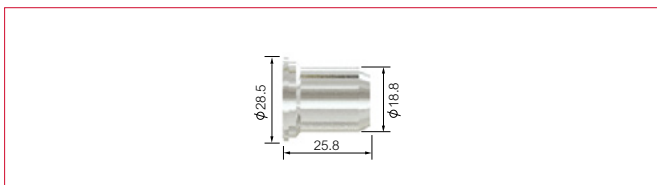

PCV0009	Spacer Contact Cutting
---------	------------------------

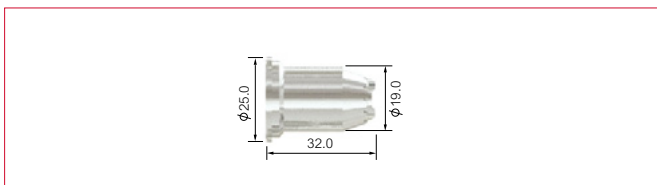

PCV0039	Spacer Contact Cutting Large
---------	------------------------------

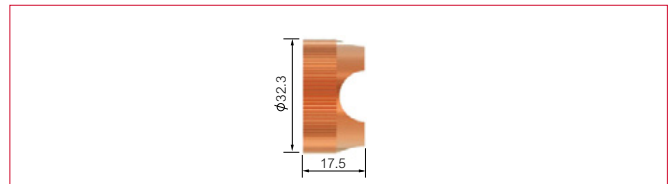

STR A151R

Part No.	Description
P1408C1	Spacer Contact Cutting

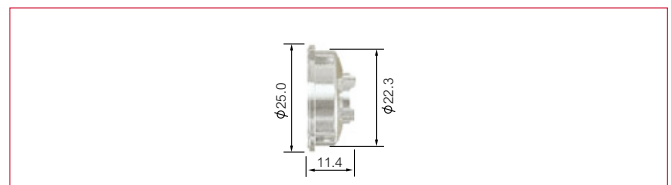

* Denotes torch package standard wear part set-up

STR A151R

Part No.	Description
P1389CN	Locking Nut

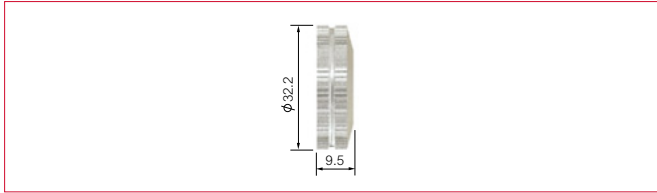

STR A101R/A141R/A151R

Part No.	Description
P1408LN	Locking Nut

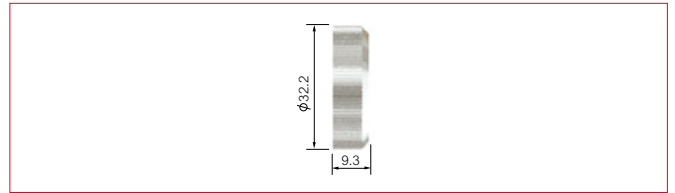

Cooling Tubes

STR A81

Part No.	Description
* PFH0560	Cooling Tube

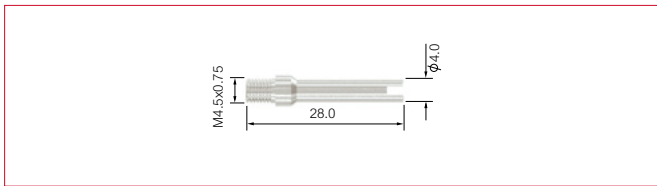

PFH0561	Cooling Tube Extended
---------	-----------------------

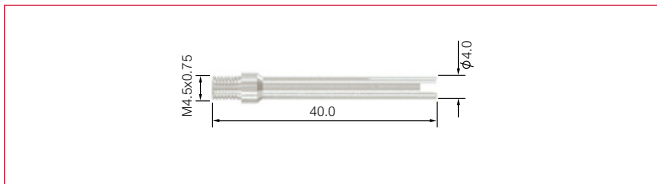

STR A101R

Part No.	Description
* SCP8102	Cooling Tube

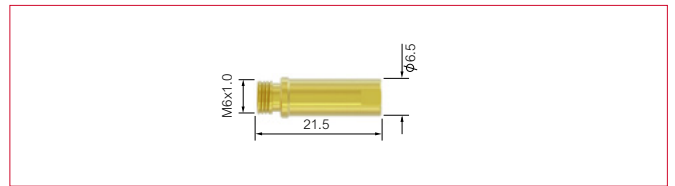

PFH0562E	Cooling Tube Extended
----------	-----------------------

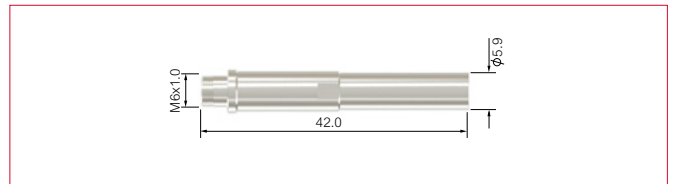

STR A141R/A151R

Part No.	Description
* SCP1412	Cooling Tube

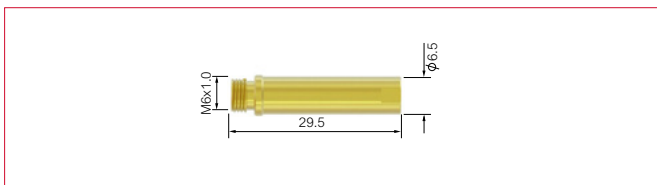

STR A141R/A151R

Part No.	Description
PFH0563E	Cooling Tube Extended



* Denotes torch package standard wear part set-up

Cutting Buggies

STR S25K/S45

Part No.	Description
SCP2551	Cutting Buggy

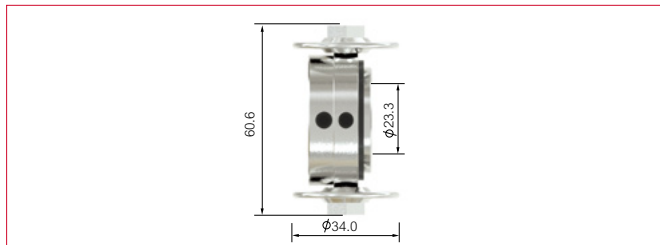

STR A101R/A141R/A151R

Part No.	Description
PCV0021	Cutting Buggy

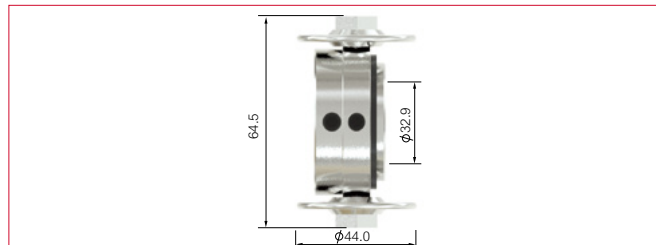

STR A81

Part No.	Description
SCP8151	Cutting Buggy

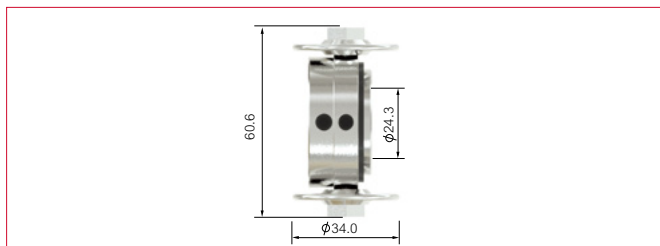

Circle / Cutting Attachment Kits

STR S25K/S45

STR A81

STR A101R/A141R/A151R

Part No.	Description	Part No.	Description	Part No.	Description
SCP2550	Circle / Cutting Attachment Kit	SCP8150	Circle / Cutting Attachment Kit	PCV0022	Circle / Cutting Attachment Kit

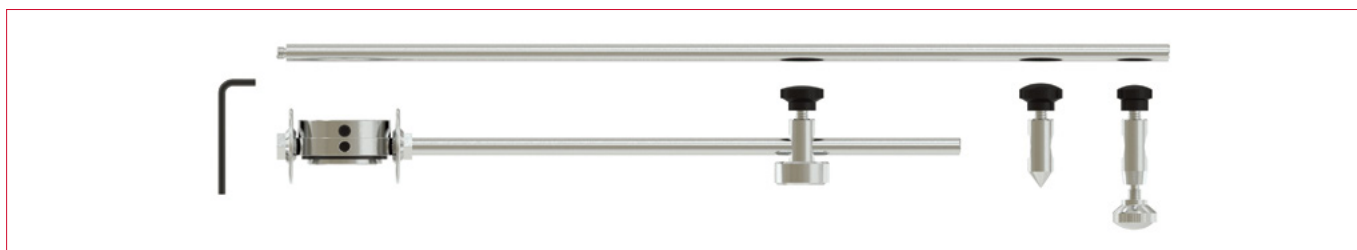

* Denotes torch package standard wear part set-up

Cutting Tips

Part No.	Cross REF	Description
PPD0101-11	51154	Cutting Tip
PPD0101-14	51155	Cutting Tip
PPD0101-17	51156	Cutting Tip
PPD0101-19	51157	Cutting Tip
PPD0101-30	51158	Gouging Tip
PPD0102-10	51315	Cutting Tip
PPD0103-65	51317.06	Cutting Tip
PPD0103-09	51317.09	Cutting Tip Extended
PPD0105-10	51170	Cutting Tip
PPD0105-11	51172	Cutting Tip
PPD0105-12	51172.12	Cutting Tip
PPD0106-10	51171.10	Cutting Tip Extended
PPD0106-12	51173	Cutting Tip Extended
PPD0109-14	51241	Cutting Tip
PPD0109-16	51242	Cutting Tip
PPD0109-18	51243	Cutting Tip
PPD0109-30	51244	Cutting Tip
PPD0111-12	51149	Cutting Tip Extended
PPD0116-06	51316.06	Cutting Tip
PPD0116-08	51316.08	Cutting Tip
PPD0117-14	51149.14	Cutting Tip Extended
PPD0117-17	51149.17	Cutting Tip Extended
PPD0117-19	51149.19	Cutting Tip Extended

Electrodes

Part No.	Cross REF	Description
PPR0101	52535	Electrode
PPR0105	52536	Electrode
PPR0106	52532	Electrode
PPR0109	52580/S	Electrode
PPR0110	52531	Electrode
PPR0111	52534	Electrode
PPR0115	52581/S	Electrode Extended
PPR0116	52530	Electrode Extended

Swirl Rings

Part No.	Cross REF	Description
PPE0101	60030	Swirl Ring
PPE0103	60031	Swirl Ring
PPE0106	60028	Swirl Ring
PPE0107	60029	Swirl Ring
PGR60	60369	Extractor For Swirl Ring

Cooling Tubes

Part No.	Cross REF	Description
PFH0560	06801.42	Cooling Tube
PFH0561	06801.43	Cooling Tube Extended
PFH0562E	06005	Cooling Tube Extended
PFH0563E	05005	Cooling Tube Extended

Retaining Caps

Part No.	Cross REF	Description
PPC0102	60375	Retaining Cap Long Life
PPC0111	60376	Retaining Cap Long Life
PPC0115	60384	Retaining Cap
PPC0120	60387	Retaining Cap

Shield Cap Bodies

Part No.	Cross REF	Description
PPC0130	60386/V	Shield Cap Body Max. Life
PPC0131	60385/V	Shield Cap Body Max. Life
PBW0139	60388	Nozzles Shield

Stand Off Guides

Part No.	Cross REF	Description
PCV0011	51910	Spacer Spring
PCV0012	60370	Spacer Double Pointed
PCV0014	60371	Spacer Crown
PCV0028	51902	Spacer Spring
PCV0033	60378	Spacer Crown
PCV1105	60379	Spacer Cage
P1394-150	51911	Spacer Spring

Spacers For Contact Cutting

Part No.	Cross REF	Description
PCV0023	51940	Spacer Contact Cutting
PCV0039	51945	Spacer Contact Cutting Large
PCV0201	51976	Spacer Contact Cutting
P1408C1	51950	Spacer Contact Cutting
PCV0013	60373	Spacer Gouging
P1408G	51953	Spacer Gouging

Locking Nuts

Part No.	Cross REF	Description
P1389CN	51952	Locking Nut
P1408LN	51959	Locking Nut

Cutting Buggies

Part No.	Cross REF	Description
SCP2551	51823	Cutting Buggy
PCV0021	51851	Cutting Buggy

Circle Cutting Attachment Kits

Part No.	Cross REF	Description
SCP2550	51866	Circle Cutting Attachment Kit
PCV0022	51807	Circle Cutting Attachment Kit

Torch Head Kits

Part No.	Cross REF	Description
STR2501	09601	STR25 70° Torch Head Kit
STR4001	09602	STR45 70° Torch Head Kit
STR0140	06802	STR81 70° Torch Head Kit
STR0145	06001	STR101R 70° Torch Head Kit
STR0155	06201	STR141 70° Torch Head Kit
STR0160	06901	STR151 70° Torch Head Kit

Contents

Suregrip CBR Plasma Cutting Torch Range Features Focus	46
Suregrip CBR Plasma Cutting Torch Range Overview and Ratings	48

Torch Range

Air-Cooled	Suregrip CBR Plasma SCB 50	49
	Suregrip CBR Plasma SCB 70	50
	Suregrip CBR Plasma SCB 150R	52

Wear Parts

Cutting Tips	54
Electrodes	56
Swirl Rings	56
Retaining Caps	57
Shield Cap Bodies	57
Stand off Guides	58
Shield Caps	59
Spacers for Gouging	59
Spacers for Contact Cutting	60
Locking Nuts	60
Cooling Tubes	61
Cutting Buggies	61
Circle / Cutting Attachment Kits	62

Cross Reference Table	63
------------------------------	----

Suregrip CBR Plasma Cutting Torch Range

Air-Cooled Features Focus

Air-Cooled

The Suregrip CBR series utilizes electrode to tip Arc striking with high frequency.

Dynamic Engineering and Superior Design Ergonomics



100% Cebora® Compatibility Guaranteed

Quality Wear Parts

All wear parts are manufactured to the same specification as the original manufacturer ensuring reliability, longevity and superior performance

Safety Systems

A twin “fail-safe” system located beneath the shield cap ensures the torch cannot be activated if the cap is removed



Torch Bodies

Produced from precision tolerance and machined aerospace polymers

Features Focus

Cutting Tools for the Professional



Ergonomics – For Comfort and Handleability

- Large surface area grips improve positionability and operator comfort
- Cable supports are designed to offer the greatest flexibility

Trigger System

A patented slide to operate switch system is easy to operate and prevents accidental torch ignition



Terminations

Terminations available for separate and central connector cable types

The Smart Way To Buy Welding and Cutting Tools



Suregrip CBR Plasma Cutting Torch Range

Ratings: 50 Amp to 150 Amp



Model	SCB 50	SCB 70	SCB 150R
Technical Data			
Cooling Method	Air-Cooled	Air-Cooled	Air-Cooled
Rating:	50A	70A	150A
Cutting Thickness	10-15mm	15-20mm	35-40mm
Duty Cycle:	60%	60%	60%
Gas	Air/N ₂	Air/N ₂	Air/N ₂
Gas Pressure	4.5-5.0 bar 65-75 psi	4.5-5.0 bar 65-75 psi	4.5-5.0 bar 65-75 psi
Gas Flow	120 l/min 250 scfh	130 l/min 275 scfh	220 l/min 470 scfh
Pilot	Electrode to Tip	Electrode to Tip	Electrode to Tip
Ignition	HF	HF	HF
Post Flow	90 sec	90 sec	90 sec

SCB 50 Suregrip CBR Plasma Cutting Torch Range

Rating: 50A Air/N₂ gas, @ 60% duty cycle.

Air-Cooled Cutting Torch Range

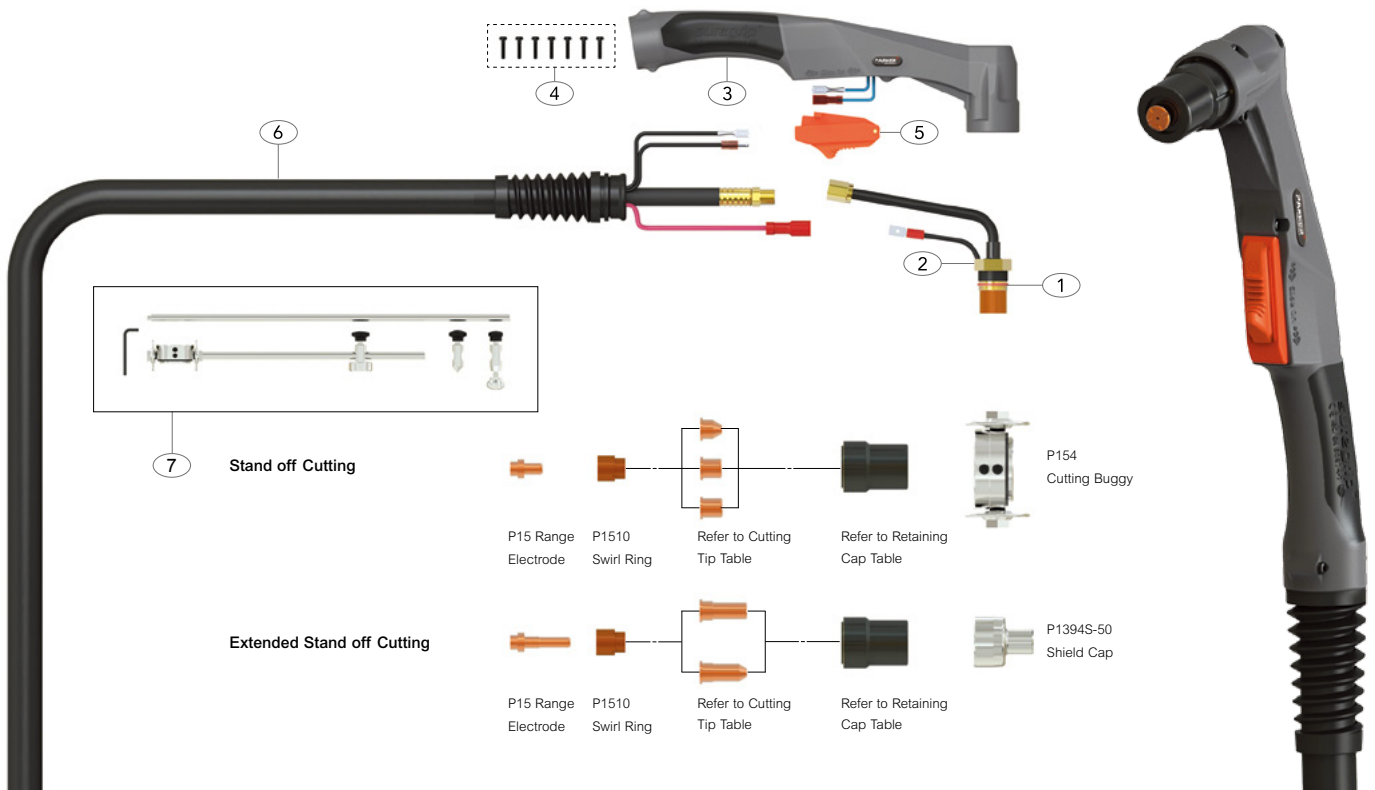

Model

Description	Part No.
Suregrip CBR Plasma Cutting Torch Package	6mt
	SCB50-60-CF6

Wear Parts

Cutting Tips

Part No.	Description	Bore Ø A	Amps
P1304	Cutting Tip	1.0mm	50A
P1306	Cutting Tip Extended Contact	1.0mm	50A
P1304F-10	Cutting Tip Flat	1.0mm	50A
*P1305	Cutting Tip Conical	1.0mm	50A
P1370	Cutting Tip Extended	1.0mm	50A
P1395	Cutting Tip Extended Long Life	1.0mm	50A
P1395-11	Cutting Tip Extended Long Life	1.1mm	60A
P1396	Cutting Tip Long Life	1.0mm	50A
P1396-11	Cutting Tip Long Life	1.1mm	60A

Retaining Caps

Part No.	Description
*P5.710.121	Retaining Cap

Spare Parts

Part No.	Description
1	SCP5008 O Ring
2	SCB1352 SCB50 70° Torch Head Kit
3	SCP5014/HF Plasma Handle Kit
4	SCPSP1 Screw Pack
5	SCP2516 Plasma Safety Trigger
6	*SCP5019-60-CF6 Cable Assembly Complete x 6mt
7	P166 Circle Cutting Attachment Kit

CF6

*Denotes torch package standard wear part set-up
For more information please refer to the following sections:
•Master Wear Parts Table Page 54-62

SCB 70 Suregrip CBR Plasma Cutting Torch Range

Rating: 70A Air/N₂ gas, @ 60% duty cycle.

Air-Cooled Cutting Torch Range

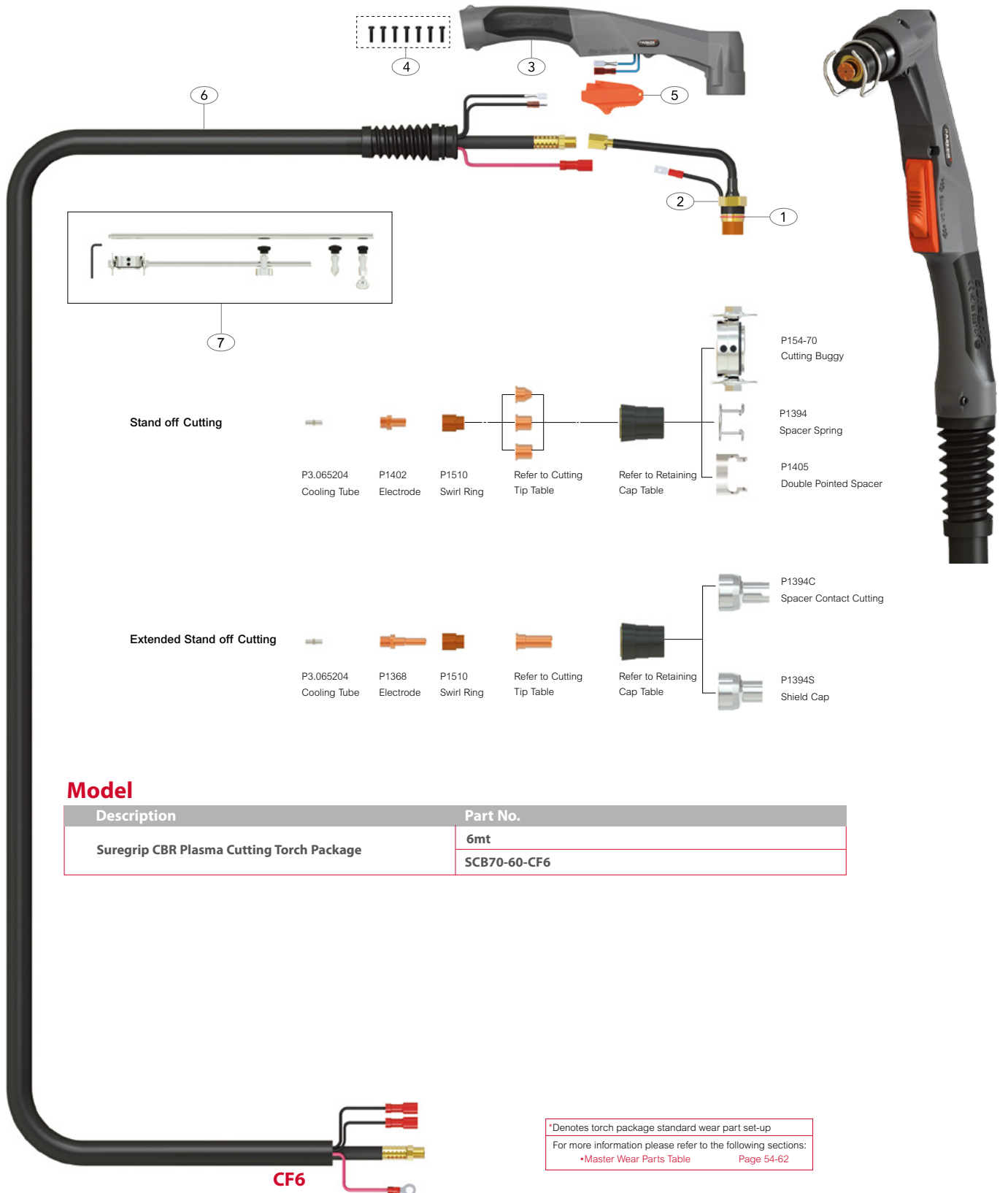

Model

Description	Part No.
Suregrip CBR Plasma Cutting Torch Package	6mt
	SCB70-60-CF6

*Denotes torch package standard wear part set-up
For more information please refer to the following sections:
•Master Wear Parts Table Page 54-62

SCB 70 Suregrip CBR Plasma Cutting Torch Range

Rating: 70A Air/N₂ gas, @ 60% duty cycle.

Air-Cooled Cutting Torch Range

Wear Parts

Cutting Tips

Part No.	Description	Bore ϕ A	Amps
P1309	Cutting Tip	0.9mm	35A
P1308	Cutting Tip	1.2mm	70A
P1396-12	Cutting Tip Long Life	1.2mm	70A
*P1304F-12	Cutting Tip Flat	1.2mm	70A
P1305-12	Cutting Tip Conical	1.2mm	70A
P1395-12	Cutting Tip Extended Long Life	1.2mm	70A
P1366	Cutting Tip Extended	0.9mm	35A
P1396	Cutting Tip Long Life	1.0mm	50A
1396-11	Cutting Tip Long Life	1.1mm	60A
P1304F-10	Cutting Tip Flat	1.0mm	50A
P1305	Cutting Tip Conical	1.0mm	50A
P1395	Cutting Tip Extended Long Life	1.0mm	50A
P1395-11	Cutting Tip Extended Long Life	1.0mm	60A

Retaining Caps

Part No.	Description
*P5.710.171	Retaining Cap

Spare Parts

Part No.	Description
1	SCP5008 O Ring
2	SCB1351 SCB70 70° Torch Head Kit
3	SCP5014/HF Plasma Handle Kit
4	SCPSP1 Screw Pack
5	SCP2516 Plasma Safety Trigger
6	*SCP5019-60-CF6 Cable Assembly Complete x 6mt
7	P166-70 Circle Cutting Attachment Kit

SCB 150R Suregrip CBR Plasma Cutting Torch Range

Rating: 150A Air/N₂ gas, @ 60% duty cycle.

Air-Cooled Cutting Torch Range

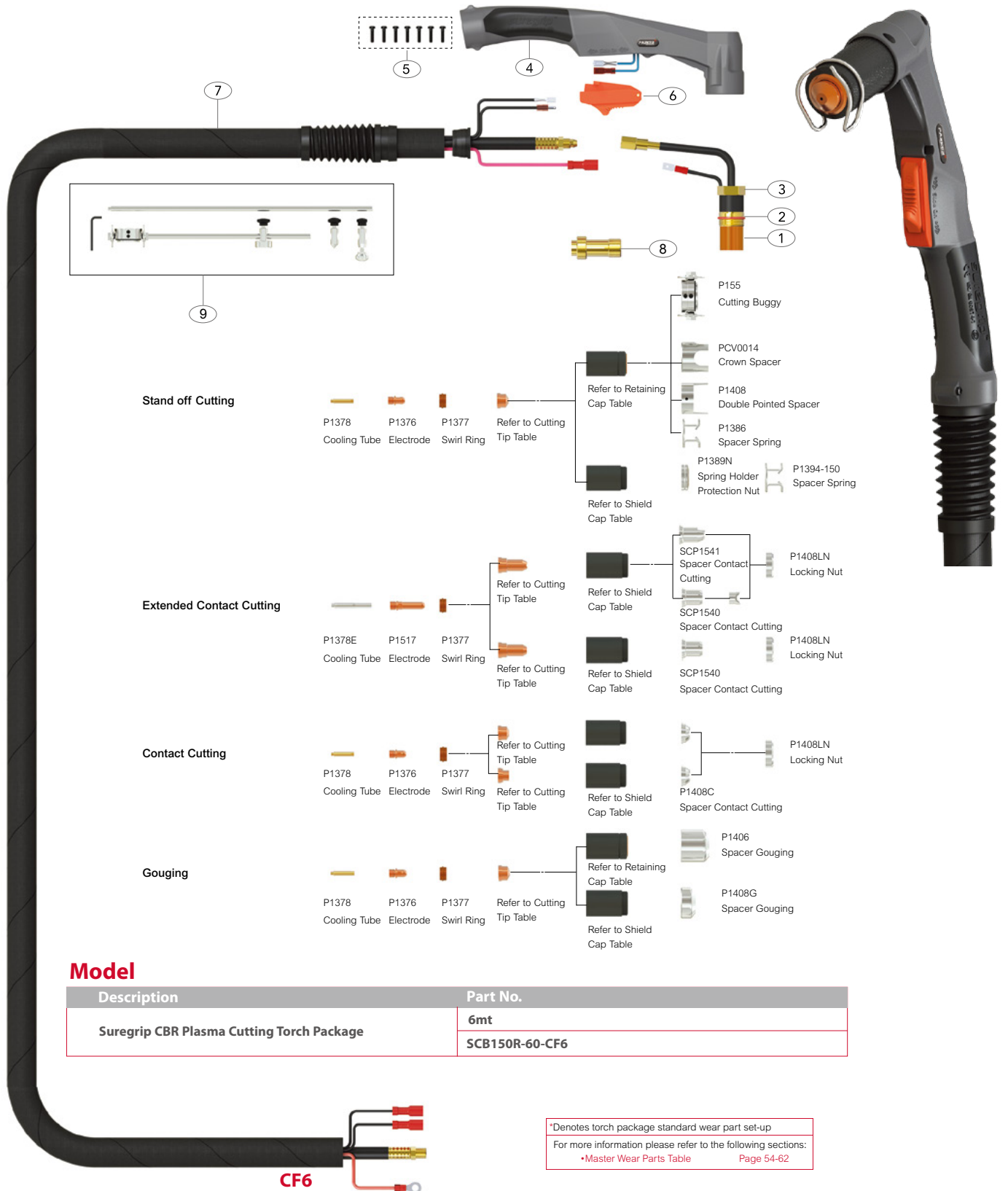

SCB 150R Suregrip CBR Plasma Cutting Torch Range

Rating: 150A Air/N₂ gas, @ 60% duty cycle.

Air-Cooled Cutting Torch Range

Wear Parts

Cutting Tips

Part No.	Description	Bore Ø A	Amps
P1371	Cutting Tip Long Life	1.1mm	60A
P1372	Cutting Tip Long Life	1.35mm	90A
P1373	Cutting Tip Long Life	1.6mm	120A
* P1374	Cutting Tip Long Life	1.8mm	150A
P1375	Gouging Tip	3.0mm	150A
P1371C-13	Cutting Tip Contact	1.35mm	90A
P1371C-16	Cutting Tip Contact	1.6mm	120A
P1371C-18	Cutting Tip Contact	1.8mm	150A
P1369	Cutting Tip Extended	1.1mm	60A
P1369-13	Cutting Tip Extended	1.35mm	90A
P1369-16	Cutting Tip Extended	1.6mm	120A
P1369-18	Cutting Tip Extended	1.8mm	150A

Retaining / Shield Caps

Part No.	Description
* P1389	Retaining Cap
P1389-C	Shield Cap Body
P1389-L	Shield Cap Body Max.Life

Spare Parts

Part No.	Description	
1	SCP1503	Front insulation
2	SCP1508	O Ring
3	SCB1353	SCB150 70° Torch Head Kit
4	SCP8014/HF	Plasma Handle Kit
5	SCPSP1	Screw Pack
6	SCP2516	Plasma Safety Trigger
7	*SCP15019-60-CF6	Cable Assembly Complete x 6mt
8	P1509	Extractor For Swirl Ring
9	P169	Circle Cutting Attachment Kit

SCB 50

Part No.	Description	Bore ϕ A	Amps
* P1304	Cutting Tip	1.0mm	50A

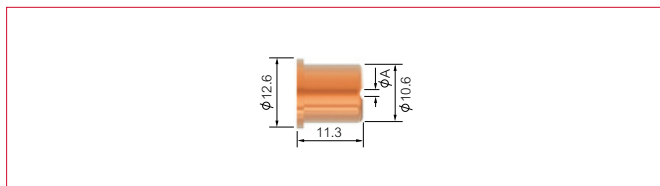

P1306	Cutting Tip Extended Contact	1.0mm	50A
-------	------------------------------	-------	-----

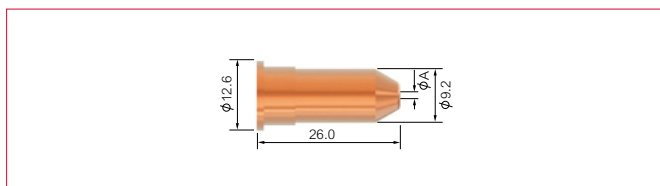

SCB 50/70

Part No.	Description	Bore ϕ A	Amps
P1396	Cutting Tip Long Life	1.0mm	50A
P1396-11	Cutting Tip Long Life	1.1mm	60A

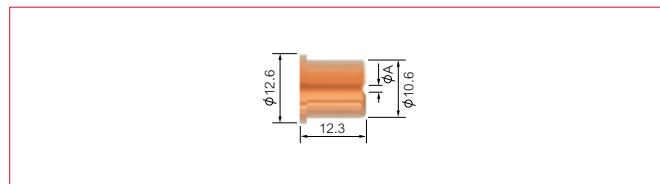

P1366	Cutting Tip Extended	0.9mm	35A
-------	----------------------	-------	-----

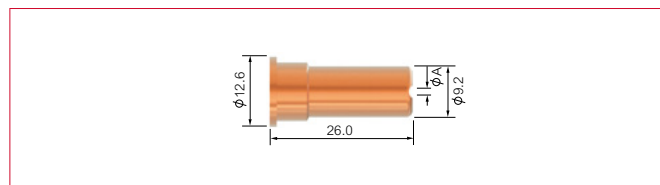

P1370	Cutting Tip Extended	1.0mm	50A
-------	----------------------	-------	-----

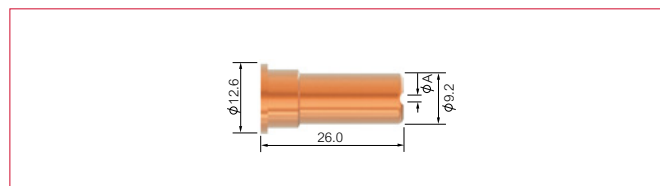

SCB 70

Part No.	Description	Bore ϕ A	Amps
P1304F-12	Cutting Tip Flat	1.2mm	70A

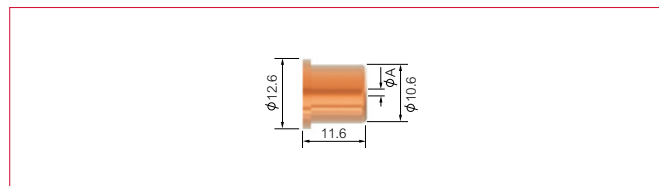

P1305-12	Cutting Tip Conical	1.2mm	70A
----------	---------------------	-------	-----

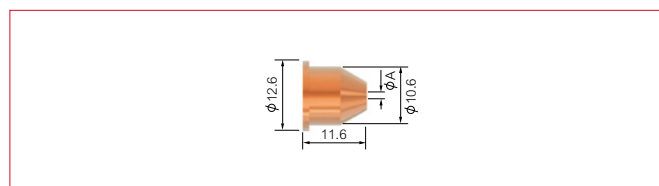

P1395-12	Cutting Tip Extended Long Life	1.2mm	70A
----------	--------------------------------	-------	-----

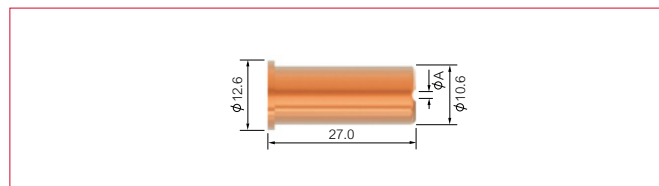

SCB 70

Part No.	Description	Bore ϕ A	Amps
P1309	Cutting Tip	0.9mm	35A
P1308	Cutting Tip	1.2mm	70A

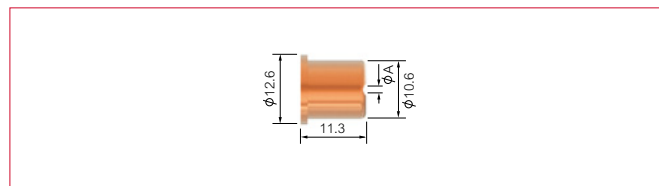

* P1396-12	Cutting Tip Long Life	1.2mm	70A
------------	-----------------------	-------	-----

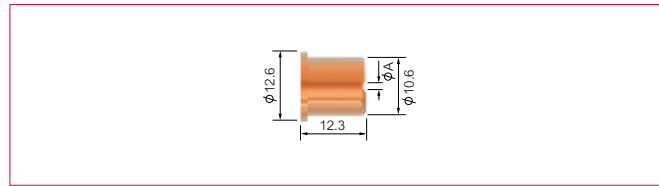

* Denotes torch package standard wear part set-up

Cutting Tips

SCB 50/70

Part No.	Description	Bore ϕ A	Amps
P1304F-10	Cutting Tip Flat	1.0mm	50A

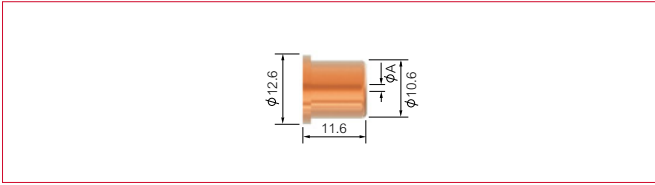

P1305	Cutting Tip Conical	1.0mm	50A
-------	---------------------	-------	-----

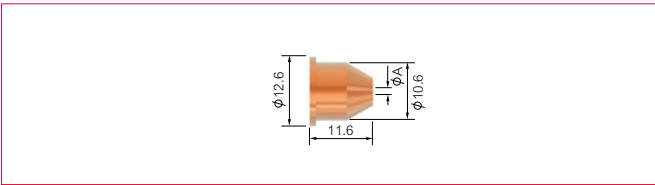

P1395	Cutting Tip Extended Long Life	1.0mm	50A
P1395-11	Cutting Tip Extended Long Life	1.1mm	60A

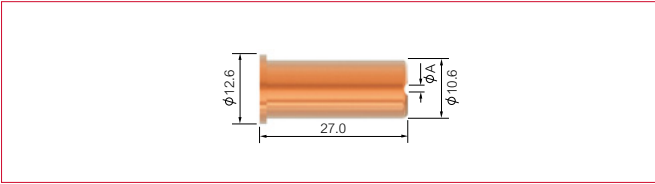

SCB 150R

Part No.	Description	Bore ϕ A	Amps
P1371	Cutting Tip Long Life	1.1mm	60A
P1372	Cutting Tip Long Life	1.35mm	90A
P1373	Cutting Tip Long Life	1.6mm	120A
* P1374	Cutting Tip Long Life	1.8mm	150A

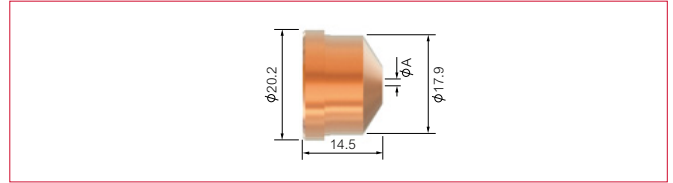

P1375	Gouging Tip	3.0mm	150A
-------	-------------	-------	------

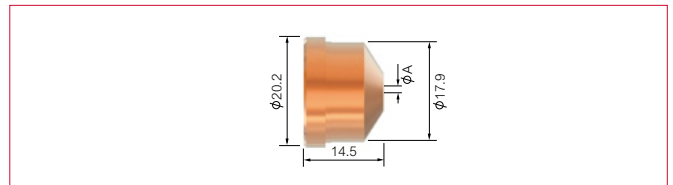

P1371C-13	Cutting Tip Contact	1.35mm	90A
P1371C-16	Cutting Tip Contact	1.6mm	120A
P1371C-18	Cutting Tip Contact	1.8mm	150A

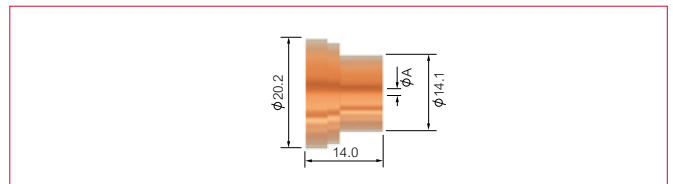

P1369	Cutting Tip Extended	1.1mm	60A
-------	----------------------	-------	-----

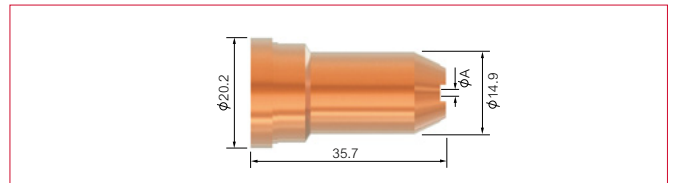

P1369-13	Cutting Tip Extended	1.35mm	90A
P1369-16	Cutting Tip Extended	1.6mm	120A
P1369-18	Cutting Tip Extended	1.8mm	150A

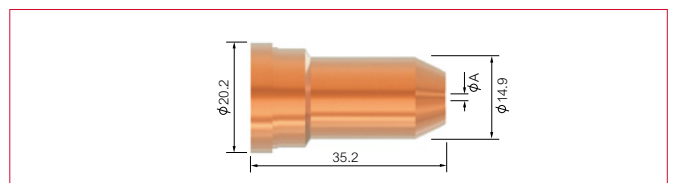

* Denotes torch package standard wear part set-up

SCB 50

Part No.	Description
* P1521-Hf	Electrode Hafnium

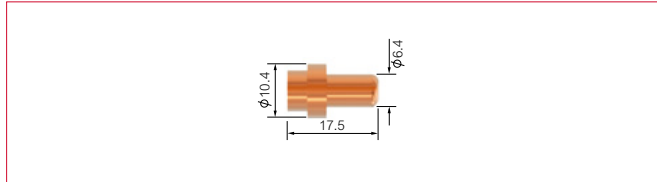

P1518-Hf	Electrode Hafnium Extended
----------	----------------------------

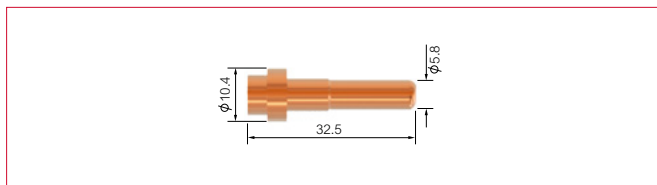

SCB 150R

Part No.	Description
* P1376	Electrode

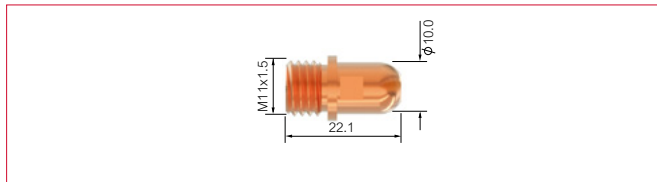

P1517	Electrode Extended
-------	--------------------

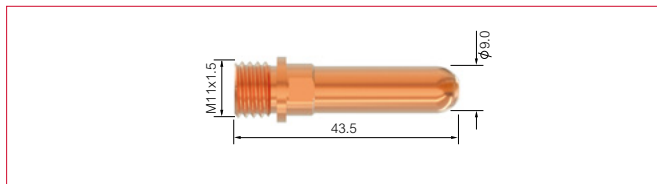

SCB 70

Part No.	Description
* P1402	Electrode

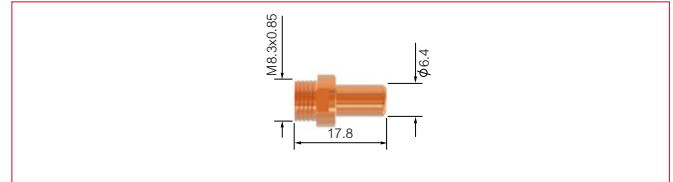

SCB 70

Part No.	Description
* P1368	Electrode Extended

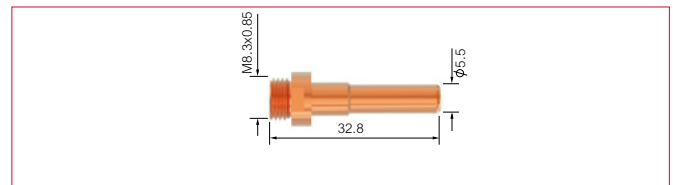

Swirl Rings

SCB 50/70

Part No.	Description
* P1510	Swirl Ring

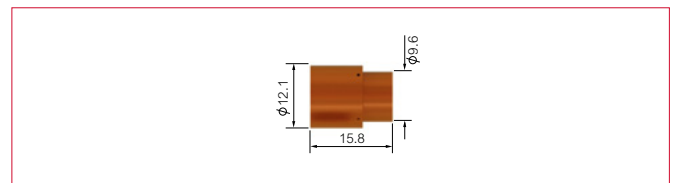

SCB 150R

Part No.	Description
* P1377	Swirl Ring

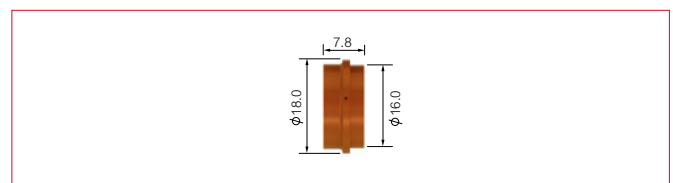

* Denotes torch package standard wear part set-up

Retaining Caps

SCB 50

Part No.	Description
* P5.710.121	Retaining Cap

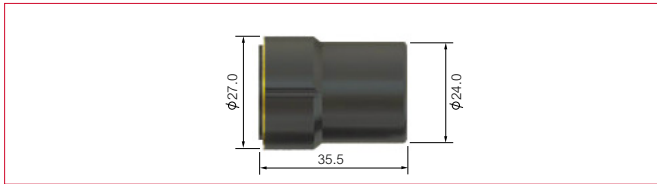

SCB 70

Part No.	Description
* P5.710.171	Retaining Cap

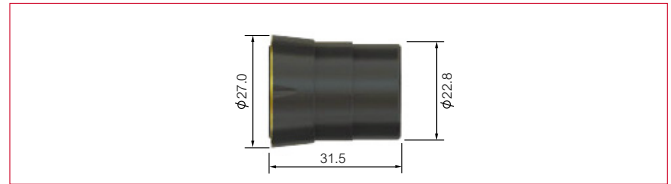

SCB 150R

Part No.	Description
* P1389	Retaining Cap

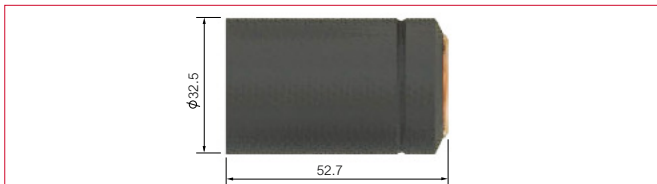

Shield Cap Bodies

SCB 150R

Part No.	Description
P1389-C	Shield Cap Body
P1389-L	Shield Cap Body Max.Life

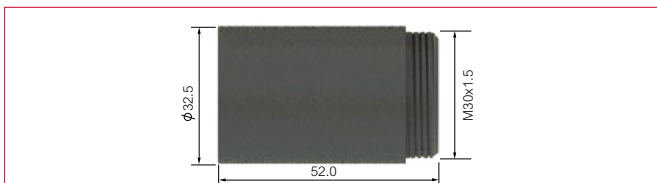

* Denotes torch package standard wear part set-up

Stand off Guides

SCB 70

Part No.	Description
* P1394	Spacer Spring

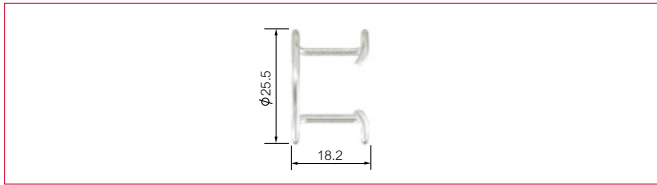

P1405	Spacer Double Pointed
-------	-----------------------

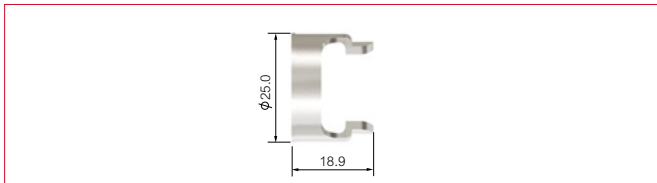

SCB 150R

Part No.	Description
P1394-150	Spacer Spring

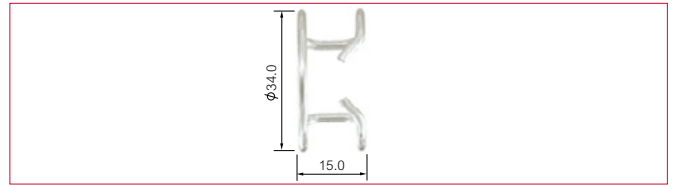

P1408	Spacer Double Pointed
-------	-----------------------

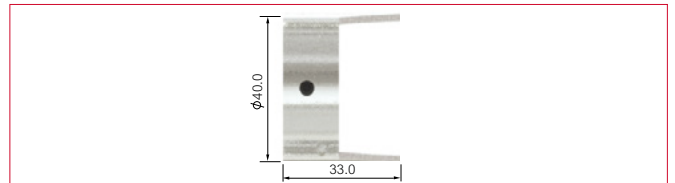

P1408CE	Spacer Extended Tips High Amp
---------	-------------------------------

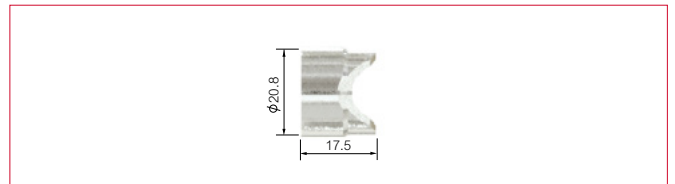

* P1386	Spacer Spring
---------	---------------

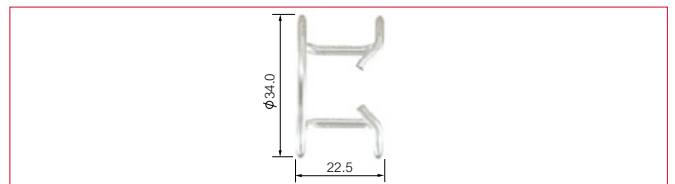

PCV0014	Spacer Crown
---------	--------------

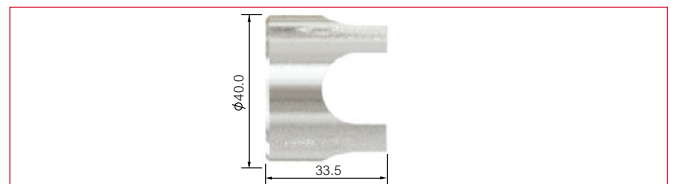

* Denotes torch package standard wear part set-up

Wear Parts

Shield Caps

SCB 50

Part No.	Description
P1394S-50	Shield Cap Hand

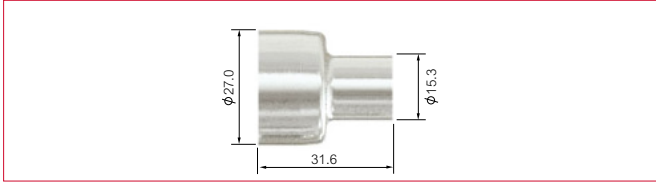

SCB 70

Part No.	Description
P1394S	Shield Cap Hand

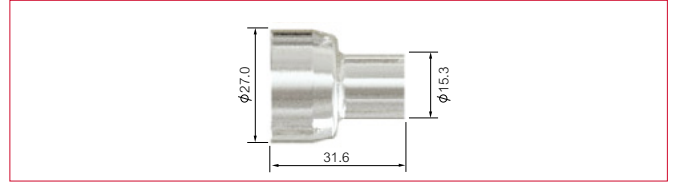

Spacers for Gouging

SCB 150R

Part No.	Description
P1406	Spacer Gouging

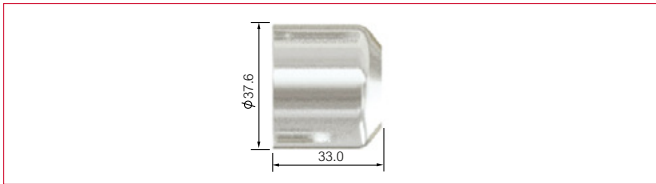

P1408G	Spacer Gouging
--------	----------------

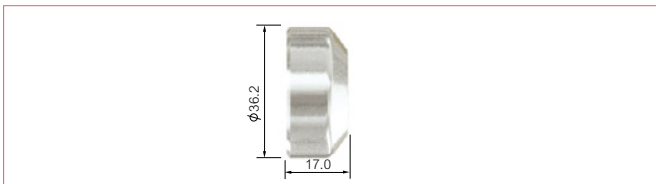

* Denotes torch package standard wear part set-up

Spacers for Contact Cutting

SCB 70

Part No.	Description
P1394C	Spacer Contact Cutting, Hand

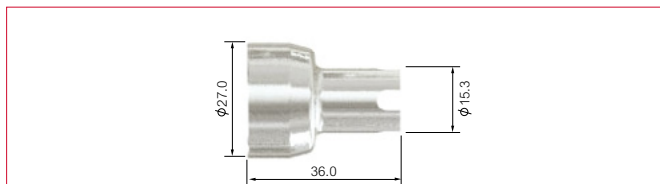

SCB 150R

Part No.	Description
P1408C	Spacer Contact Cutting

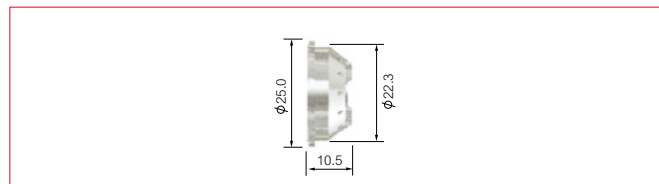

P1408C1	Spacer Contact Cutting
---------	------------------------

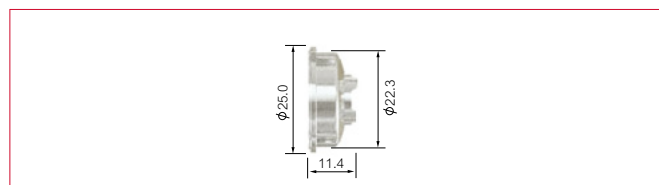

SCP1540	Spacer Contact Cutting
---------	------------------------

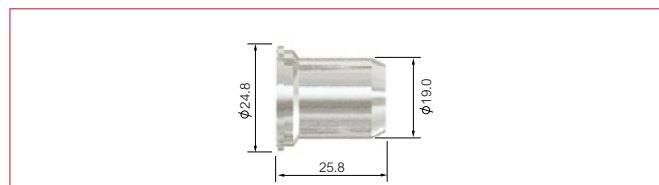

SCP1541	Spacer Contact Cutting
---------	------------------------

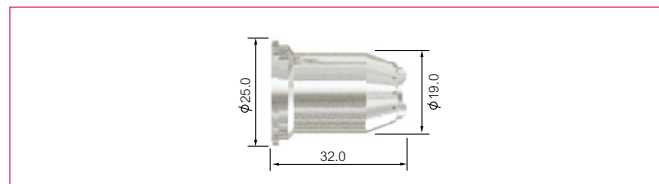

Locking Nuts

SCB 150R

Part No.	Description
P1389CN	Spring Holder Protection Nut

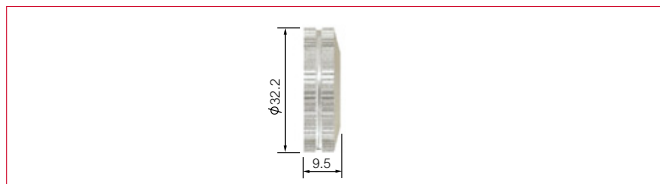

P1408LN	Locking Nut
---------	-------------

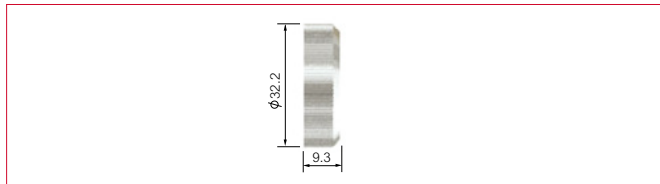

* Denotes torch package standard wear part set-up

Wear Parts

Cooling Tubes

SCB 70

Part No.	Description
* P3.065204	Cooling Tube

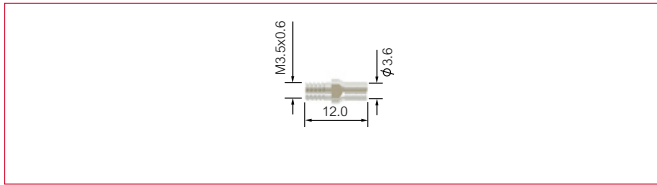

SCB 150R

Part No.	Description
* P1378	Cooling Tube

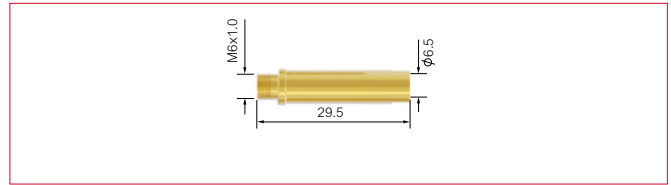

P1378E	Cooling Tube Extended
--------	-----------------------

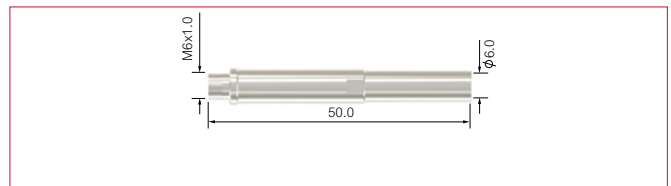

Cutting Buggies

SCB 50

Part No.	Description
P154	Cutting Buggy

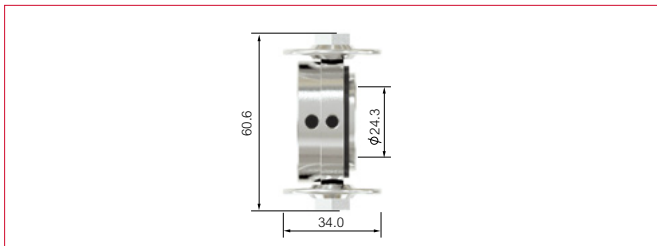

SCB 70

Part No.	Description
P154-70	Cutting Buggy

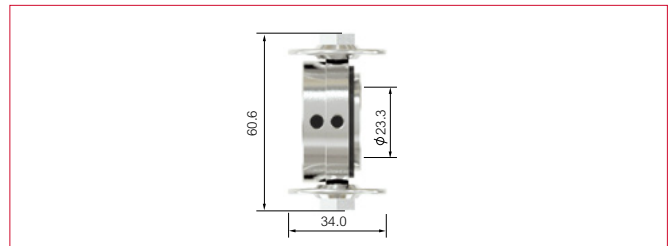

SCB 150R

Part No.	Description
P155	Cutting Buggy

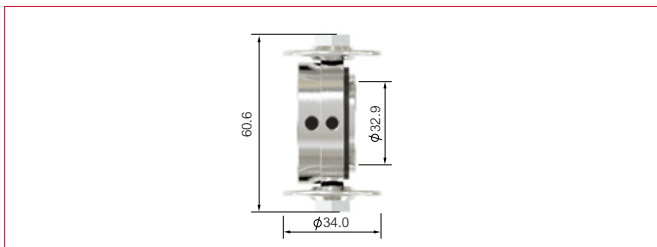

* Denotes torch package standard wear part set-up

Circle / Cutting Attachment Kits

SCB 50

Part No.	Description
P166	Circle / Cutting Attachment Kit

SCB 70

Part No.	Description
P166-70	Circle / Cutting Attachment Kit



SCB 150R

Part No.	Description
P169	Circle / Cutting Attachment Kit



* Denotes torch package standard wear part set-up

Cutting Tips

Part No.	Cross REF	Description
P1304	51100	Cutting Tip
P1304F-10	51099	Cutting Tip Flat
P1304F-12	51099.12	Cutting Tip Flat
P1305	51098	Cutting Tip Conical
P1305-12	51098.12	Cutting Tip Conical
P1306	51101	Cutting Tip Extended Contact
P1308	51100.12	Cutting Tip
P1309	51100.09	Cutting Tip
P1366	51102.09	Cutting Tip Extended
P1369	51148	Cutting Tip Extended
P1369-13	51148.13	Cutting Tip Extended
P1369-16	51148.16	Cutting Tip Extended
P1369-18	51148.18	Cutting Tip Extended
P1370	51102	Cutting Tip Extended
P1371	51140/S	Cutting Tip Long Life
P1371C-13	51410	Cutting Tip Contact
P1371C-16	51411	Cutting Tip Contact
P1371C-18	51412	Cutting Tip Contact
P1372	51141/S	Cutting Tip Long Life
P1373	51142/S	Cutting Tip Long Life
P1374	51143/S	Cutting Tip Long Life
P1375	51144	Gouging Tip
P1395	51095/L	Cutting Tip Extended Long Life
P1395-11	51102/S	Cutting Tip Extended Long Life
P1395-12	51096/L	Cutting Tip Extended Long Life
P1396	51095	Cutting Tip Long Life
P1396-11	51100/S	Cutting Tip Long Life
P1396-12	51096	Cutting Tip Long Life

Electrodes

Part No.	Cross REF	Description
P1368	52553	Electrode Extended
P1376	52540	Electrode
P1402	52551	Electrode
P1517	52549	Electrode Extended
P1518-Hf	52513/L	Electrode Hafnium Extended
P1521-Hf	52512	Electrode Hafnium

Swirl Rings

Part No.	Cross REF	Description
P1510	60001	Swirl Ring
P1377	60020	Swirl Ring
P1509	60369	Extractor For Swirl Ring

Cooling Tubes

Part No.	Cross REF	Description
P3.065204	01070.42	Cooling Tube
P3.065204-90	01090.42	Cooling Tube
P1378	05004	Cooling Tube
P1378E	05005	Cooling Tube Extended

Retaining Caps

Part No.	Cross REF	Description
P5.710.121	60320	Retaining Cap
P5.710.171	60321	Retaining Cap
P5.710.171-90	60322	Retaining Cap
P1389	60330	Retaining Cap

Shield Cap Bodies

Part No.	Cross REF	Description
P1389-C	60350	Shield Cap Body
P1389-L	60350/V	Shield Cap Body Maximum Life

Shield Caps

Part No.	Cross REF	Description
P1394S	51970	Shield Cap Hand
P1394S-50	51965	Shield Cap Hand
P5.710.171-90S	51972	Shield Cap Hand

Gouging Spacers

Part No.	Cross REF	Description
P1406	60373	Spacer Gouging
P1408G	51953	Spacer Gouging

Stand Off Guides

Part No.	Cross REF	Description
P1394	51901	Spacer Spring
P1394-150	51911	Spacer Spring
P1405	60367	Spacer Double Pointed
P1408	60370	Spacer Double Pointed
P1408CE	51974	Spacer Extended Tips High Amp
P1386	51910	Spacer Spring
PCV0014	60371	Spacer Crown

Spacer For Contact Cuttings

Part No.	Cross REF	Description
P1394C	51971	Spacer Contact Cutting Hand
PU1404	51973	Spacer Contact Cutting Hand
P1408C	51930	Spacer Contact Cutting
P1408C1	51950	Spacer Contact Cutting

Locking Nuts

Part No.	Cross REF	Description
P1389CN	51952	Spring Holder Protection Nut
P1408LN	51959	Locking Nut

Cutting Buggies

Part No.	Cross REF	Description
P154	51806	Cutting Buggy
P154-70	51801	Cutting Buggy
P153	51818	Cutting Buggy
P155	51807	Cutting Buggy

Circle Cutting Attachment Kits

Part No.	Cross REF	Description
P166	51850	Circle Cutting Attachment Kit
P166-70	51849	Circle Cutting Attachment Kit
P163	51848	Circle Cutting Attachment Kit
P169	51851	Circle Cutting Attachment Kit

Torch Head Kits

Part No.	Cross REF	Description
SCB1352	01001	SCB50 70° Torch Head Kit
SCB1351	01071	SCB70 70° Torch Head Kit
SCB1358	01091	SCB90 70° Torch Head Kit
SCB1353	02001	SCB150 70° Torch Head Kit



WeldTronic

42-46 Micro Circuit Dandenong South
Victoria, 3175

Telephone: 03 9702 9366

Facsimile: 03 9702 9766