

COLDWIRE AF TIG
TIG SERIES



Welding Tools for the Professional



AF Tig Cold-Wire Pulse Feed Unit

Rating: 250A @ 60% duty cycle, 200A @ 100% duty cycle (t=40°C 10 min)

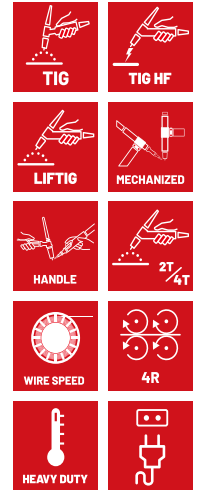

Model

Description	Part No.
AF Tig Cold-Wire Pulse Feed Unit	SGTCW-UNIT

Suitable for: Stainless Steel, Aluminium alloys and Titanium.
0.8-1.2mm Wires 5kg / 15kg or large wire packs

AF TIG COLD-WIRE PULSE FEED UNIT

The AF Tig Cold-Wire feeder is a lightweight and easily portable feeder unit, perfect for welding stainless steel and aluminium. The Cold-Wire feeder provides intermittent or continuous feeding of the filler metal into the Tig welding seam, providing a high quality, spatter free weld.

- Universal Model, suitable for all AC/DC Tig Welding Power sources
- Suitable for Manual, Automatic or Orbital Tig welding applications on thin or thick metal sheets, pipes and refill
- A 4 Roll Drive motor allows precise feed of the welding wire at continuous or pulsed mode
- Rod losses and welder fatigue are eliminated

Wire Feeding Options

Cold-Wire Tig Torch



AF Tig Cold-Wire Pulse Feed Unit

Rating: 250A @ 60% duty cycle, 200A @ 100% duty cycle (t=40°C 10 min)

Technical Data

Model	Coldwire
Input Voltage	230(+/-10%) V
Frequency	50/60 Hz
Max. Current	1A
Motor	50W
Feeding Rolls	4
Wire Spool	5/15/150Kg
Wire Speed	0,5-10m/min
Wire Diameter: Steel, Stainless Steel	0.6-1.2mm
Wire Diameter: Light Alloys	0.8-1.2mm
Wire Diameter: Fluxed Core Wire	0.9-1.2mm
Duty Cycle	250A @ 60% 200A @ 100%
Weight	19Kg
Dimensions	540x290x720mm

Pulse System



Controller

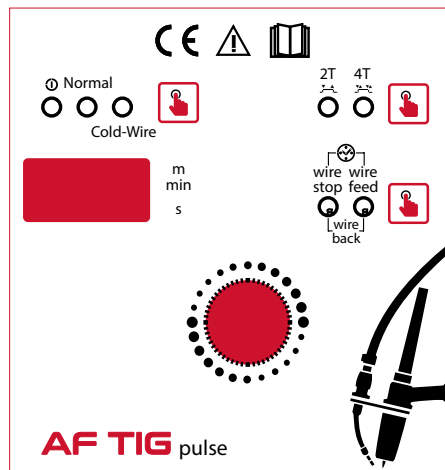

Remote Control



Productivity

Improved Quality and Productivity:

AF Tig Cold-Wire reproduces the movement of the welder's hand by adding quick and consistent filler metal allowing high quality of TIG welding seams. The operator welds with greater precision and comfort, permanently focused on the welding operation.

Productivity

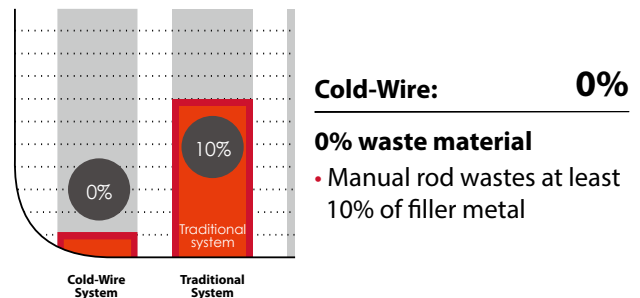
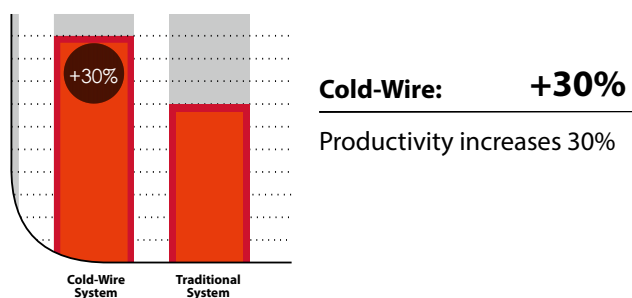

SGTETCW 17 Cold-Wire Suregrip One Tig Torch Range

Rating: 150A DC, 105A AC @ 35% duty cycle. Electrode Size: 1.0-3.2mm / 0.040"-1/8"
Air-Cooled Tig Welding Torch

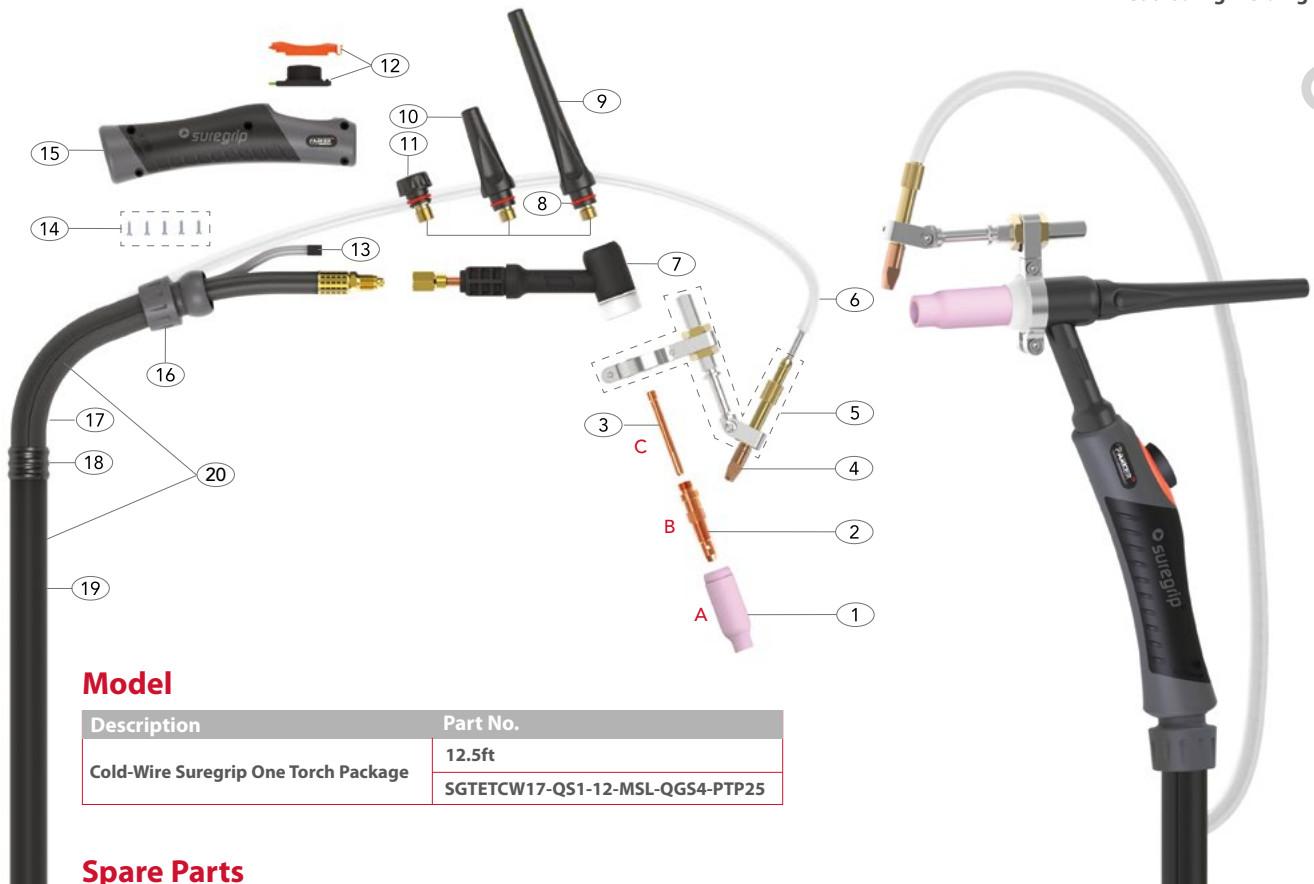

Model

Description	Part No.
Cold-Wire Suregrip One Torch Package	12.5ft SGTETCW17-QS1-12-MSL-QGS4-PTP25

Spare Parts

Part No.	Description
1	P10N47 Standard Ceramic Cup
2	P10N31M Standard Collet Body
3	P10N23M Standard Collet
4	PB2505-10 Contact Tip 1.0mm
5	PCWT172618SC-SPK CW Torch Body Clamp Assembly
6	SRS-70-ID6MM-40 Insulation Tube 400mm
7	PCW17 Torch Body CWT
8	P98W18 Back Cap 'O' Ring
9	P57Y02 Back Cap Long
10	P300M Back Cap Medium
11	P57Y04 Back Cap Short
12	PER1MS Momentary Kit
13	PERSWLQ4 Trigger Lead 12.5ft

Part No.	Description
14	PERSP1 Screw Pack
15	PERH100 Suregrip Small Ergo Tig Handle
16	PERKJ100 Small Knuckle Joint and Lock Nut
17	PHWERLC100-08 Leather Cover x 0.8mt
18	PCWJK100 Jointing Repair Kit
19	PHWERNCS-32 Neoprene Cover x 3.2mt
20	PHWERC0100-40 Sheath x 12.5ft Inc Leather Cover

For information on Rear-End / Cable Parts please refer to Page 10



SGTETCW 17

Cold-Wire Suregrip One Tig Torch Range

Rating: 150A DC, 105A AC @ 35% duty cycle. Electrode Size: 1.0-3.2mm / 0.040"-1/8"

Air-Cooled Tig Welding Torch

Wear Parts

A Standard Ceramic Cups

Part No.	Description	Size	Bore A	
			mm	inch
P10N44	Standard Ceramic Cup	12	19	3/4
P10N45	Standard Ceramic Cup	10	16	5/8
P10N46	Standard Ceramic Cup	8	12.5	1/2
P10N47	Standard Ceramic Cup	7	11	7/16
P10N48	Standard Ceramic Cup	6	10	3/8
P10N49	Standard Ceramic Cup	5	8	5/16
P10N50	Standard Ceramic Cup	4	6	1/4

C Standard Collets

Part No.	Description	Electrode Size	
		mm	inch
P10N22	Standard Collet	1.0	0.040
P10N23	Standard Collet	1.6	1/16
P10N23M	Standard Collet	2.0	5/64
P10N24	Standard Collet	2.4	3/32
P10N25	Standard Collet	3.2	1/8

B Standard Collet Bodies

Part No.	Description	Electrode Size	
		mm	inch
P10N30	Standard Collet Body	1.0	0.040
P10N31	Standard Collet Body	1.6	1/16
P10N31M	Standard Collet Body	2.0	5/64
P10N32	Standard Collet Body	2.4	3/32
P10N28	Standard Collet Body	3.2	1/8

Interconnection Cables

Part No.	Description
PCC2	Interconnection Cable x 2mt
PCC5	Interconnection Cable x 5mt



SGTETCW 26 Cold-Wire Suregrip One Tig Torch Range

Rating: 180A DC, 125A AC @ 35% duty cycle. Electrode Size: 1.0-4.0mm / 0.040"-5/32"
Air-Cooled Tig Welding Torch

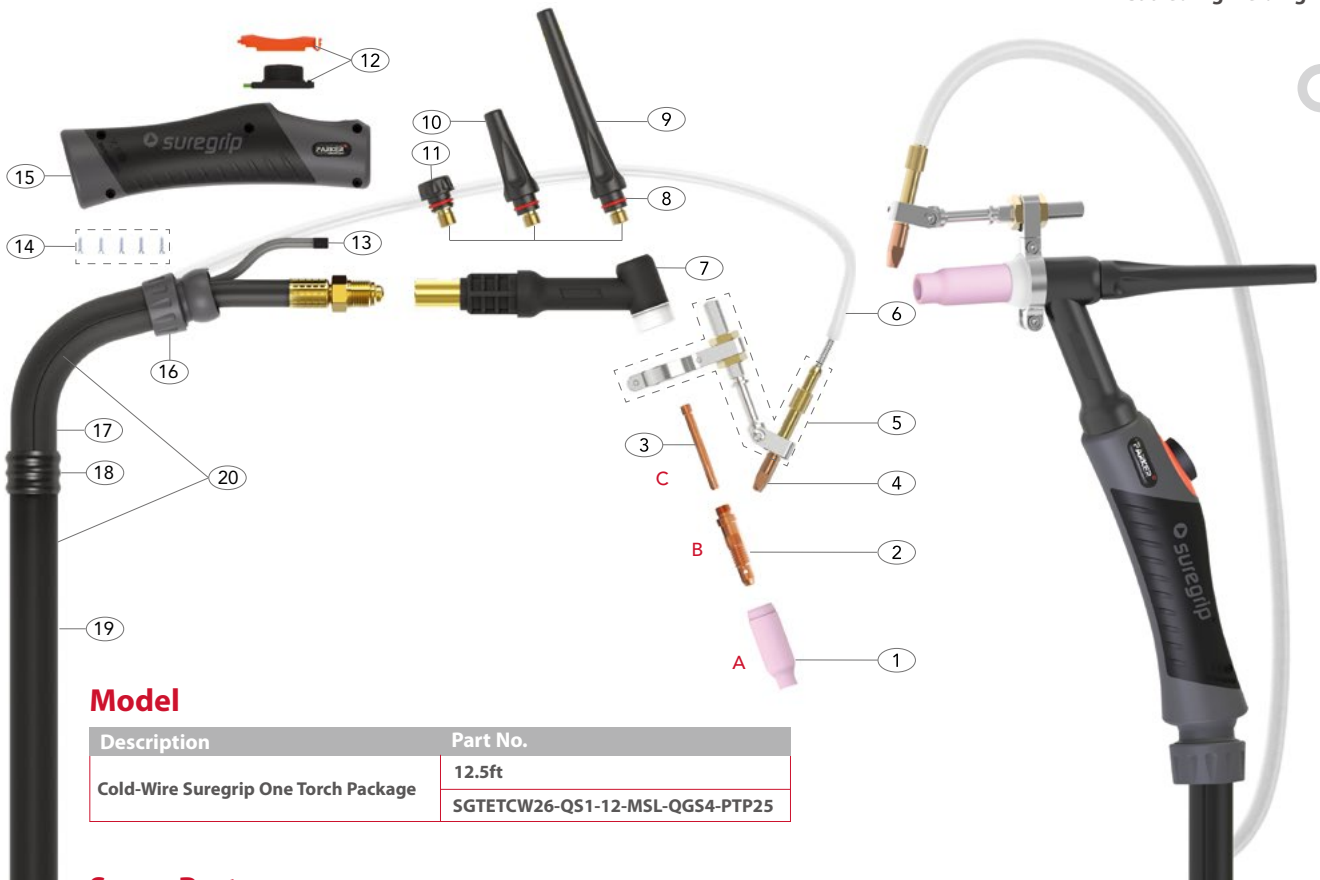

Model

Description	Part No.
Cold-Wire Suregrip One Torch Package	12.5ft SGTETCW26-QS1-12-MSL-QGS4-PTP25

Spare Parts

Part No.	Description
1 P10N48	Standard Ceramic Cup
2 P10N32	Standard Collet Body
3 P10N24	Standard Collet
4 PB2505-10	Contact Tip 1.0mm
5 PCWT172618SC-SPK	CW Torch Body Clamp Assembly
6 SRS-70-ID6MM-40	Insulation Tube 400mm
7 PCW26	Torch Body CWT
8 P98W18	Back Cap 'O' Ring
9 P57Y02	Back Cap Long
10 P300M	Back Cap Medium
11 P57Y04	Back Cap Short
12 PER1MS	Momentary Kit
13 PERSWLQ4	Trigger Lead 12.5ft

Part No.	Description
14 PERSP1	Screw Pack
15 PERH200	Suregrip Large Ergo Tig Handle
16 PERKJ200	Large Knuckle Joint and Lock Nut
17 PHWERLC200-08	Leather Cover x 0.8mt
18 PCWJK200	Jointing Repair Kit
19 PHWERNCL-32	Neoprene Cover x 3.2mt
20 PHWERC0200-40	Sheath x 12.5ft Inc Leather Cover

For information on Rear-End / Cable Parts please refer to Page 10

SGTETCW 26

Cold-Wire Suregrip One Tig Torch Range

Rating: 180A DC, 125A AC @ 35% duty cycle. Electrode Size: 1.0-4.0mm / 0.040"-5/32"

Air-Cooled Tig Welding Torch

Wear Parts

A Standard Ceramic Cups

Part No.	Description	Size	Bore A	
			mm	inch
P10N44	Standard Ceramic Cup	12	19	3/4
P10N45	Standard Ceramic Cup	10	16	5/8
P10N46	Standard Ceramic Cup	8	12.5	1/2
P10N47	Standard Ceramic Cup	7	11	7/16
P10N48	Standard Ceramic Cup	6	10	3/8
P10N49	Standard Ceramic Cup	5	8	5/16
P10N50	Standard Ceramic Cup	4	6	1/4

C Standard Collets

Part No.	Description	Electrode Size	
		mm	inch
P10N22	Standard Collet	1.0	0.040
P10N23	Standard Collet	1.6	1/16
P10N23M	Standard Collet	2.0	5/64
P10N24	Standard Collet	2.4	3/32
P10N25	Standard Collet	3.2	1/8

B Standard Collet Bodies

Part No.	Description	Electrode Size	
		mm	inch
P10N30	Standard Collet Body	1.0	0.040
P10N31	Standard Collet Body	1.6	1/16
P10N31M	Standard Collet Body	2.0	5/64
P10N32	Standard Collet Body	2.4	3/32
P10N28	Standard Collet Body	3.2	1/8

Interconnection Cables

Part No.	Description
PCC2	Interconnection Cable x 2mt
PCC5	Interconnection Cable x 5mt



SGTETCW 18 Cold-Wire Suregrip One Tig Torch Range

Rating: 380A DC, 270A AC @ 100% duty cycle. Electrode Size: 1.0-4.0mm / 0.040"-5/32"
Liquid-Cooled Tig Welding Torch

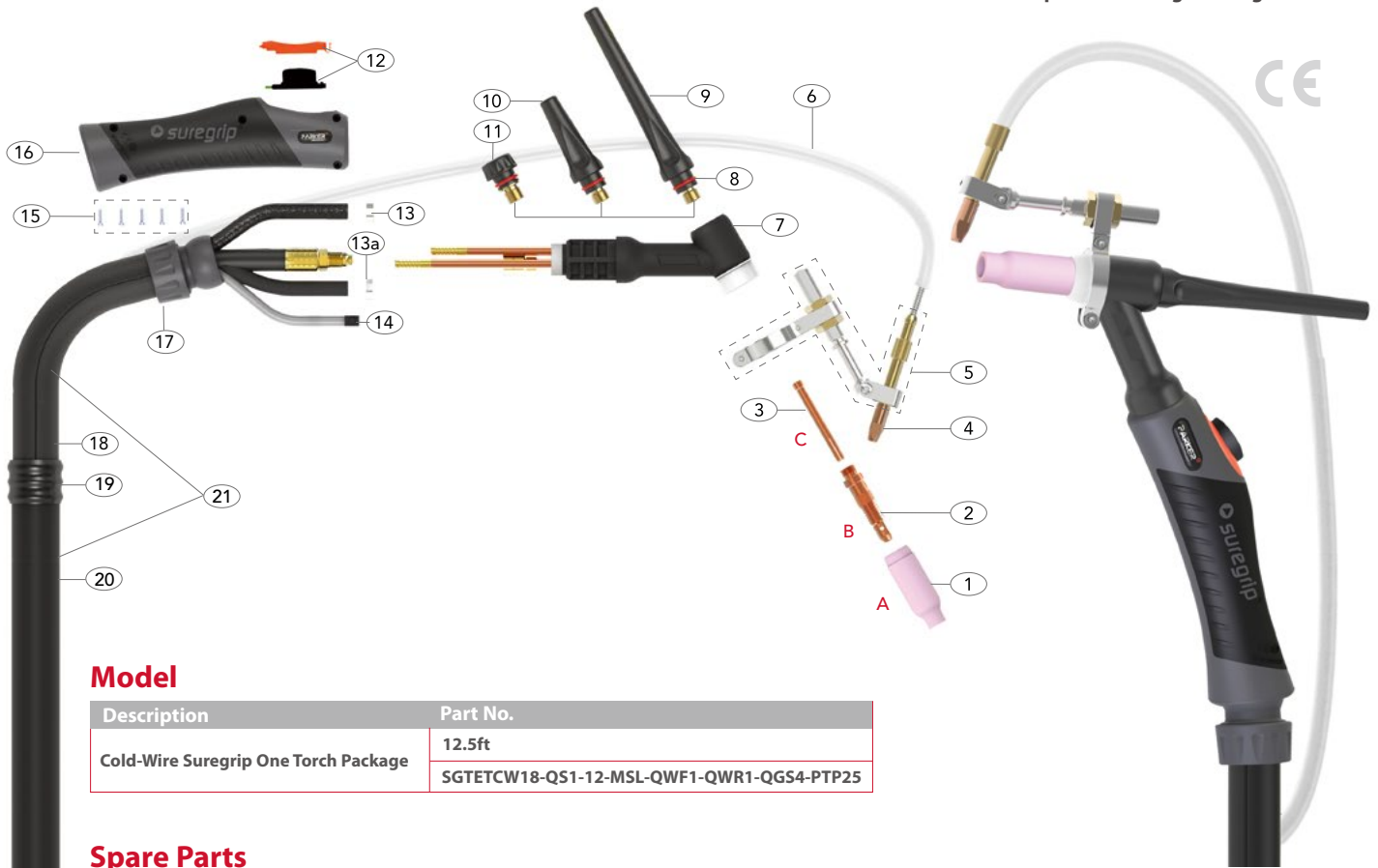

Model

Description	Part No.
Cold-Wire Suregrip One Torch Package	12.5ft SGTETCW18-QS1-12-MSL-QWF1-QWR1-QGS4-PTP25

Spare Parts

Part No.	Description	Part No.	Description
1	P10N46 Standard Ceramic Cup	13	PB5041 Hose Clamp 8.7mm
2	P10N28 Standard Collet Body	13a	PB5024 Hose Clamp 9.5mm
3	P10N25 Standard Collet	14	PERSWLQ4 Trigger Lead 12.5ft
4	PB2505-10 Contact Tip 1.0mm	15	PERSP1 Screw Pack
5	PCWT18-SPK CW Torch Body Clamp Assembly	16	PERH200N Suregrip Large Ergo Tig Handle
6	SRS-70-ID6MM-40 Insulation Tube 400mm	17	PERKJ200 Large Knuckle Joint and Lock Nut
7	PCW18 Torch Body CWT	18	PHWERLC200-08 Leather Cover x 0.8mt
8	P98W18 Back Cap 'O' Ring	19	PCWJK200 Jointing Repair Kit
9	P57Y02 Back Cap Long	20	PHWERNCL-32 Neoprene Cover x 3.2mt
10	P300M Back Cap Medium	21	PHWERCO200-40 Sheath x 12.5ft Inc Leather Cover
11	P57Y04 Back Cap Short		
12	PER1MS Momentary Kit		

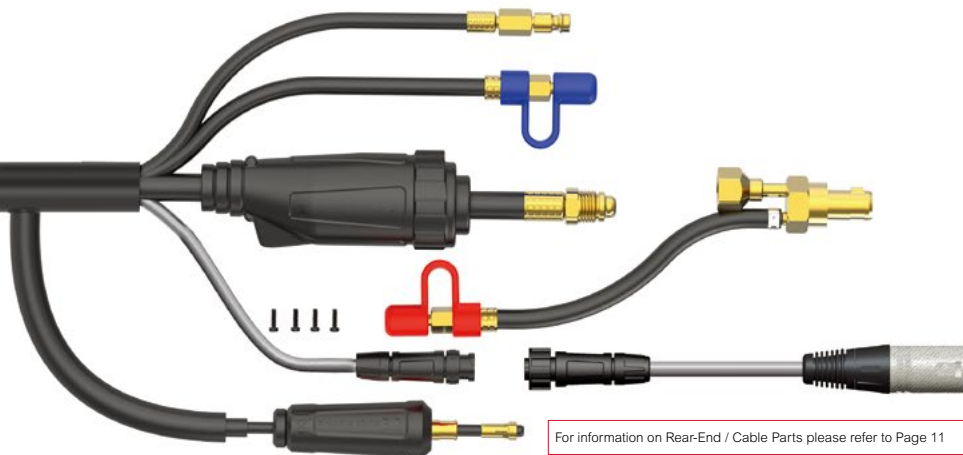

For information on Rear-End / Cable Parts please refer to Page 11

SGTETCW 18

Cold-Wire Suregrip One Tig Torch Range

Rating: 380A DC, 270A AC @ 100% duty cycle. Electrode Size: 1.0-4.0mm / 0.040"-5/32"
Liquid-Cooled Tig Welding Torch

Wear Parts

A Standard Ceramic Cups

Part No.	Description	Size	Bore A	
			mm	inch
P10N44	Standard Ceramic Cup	12	19	3/4
P10N45	Standard Ceramic Cup	10	16	5/8
P10N46	Standard Ceramic Cup	8	12.5	1/2
P10N47	Standard Ceramic Cup	7	11	7/16
P10N48	Standard Ceramic Cup	6	10	3/8
P10N49	Standard Ceramic Cup	5	8	5/16
P10N50	Standard Ceramic Cup	4	6	1/4

C Standard Collets

Part No.	Description	Electrode Size	
		mm	inch
P10N22	Standard Collet	1.0	0.040
P10N23	Standard Collet	1.6	1/16
P10N23M	Standard Collet	2.0	5/64
P10N24	Standard Collet	2.4	3/32
P10N25	Standard Collet	3.2	1/8
P54N20	Standard Collet	4.0	5/32

B Standard Collet Bodies

Part No.	Description	Electrode Size	
		mm	inch
P10N30	Standard Collet Body	1.0	0.040
P10N31	Standard Collet Body	1.6	1/16
P10N31M	Standard Collet Body	2.0	5/64
P10N32	Standard Collet Body	2.4	3/32
P406488	Standard Collet Body	4.0	5/32
P10N28	Standard Collet Body	3.2	1/8

Interconnection Cables

Part No.	Description
PCCW2	Interconnection Cable x 2mt
PCCW5	Interconnection Cable x 5mt



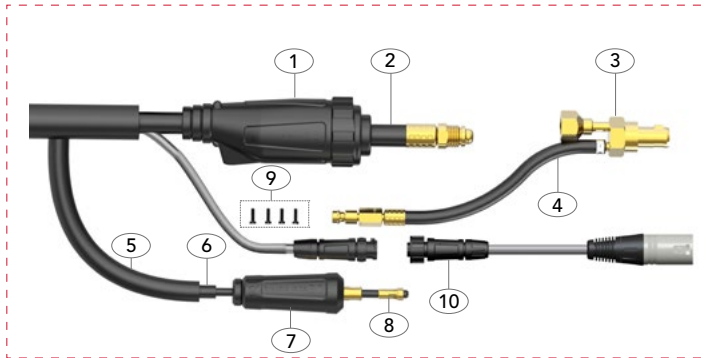

SGTETCW 17 - Cold-Wire

Part No.	Description
1	ML3550H-M MI Surelok Housing
2	PSL57Y01AOB Power Cable x 12.5ft Surelok O/B
3	ML3550-916 Mini Surelok Body 9/16"UNF
4	PCWSLOB-1-QGS4 Gas Supply Hose C/W 8.9mm Quick Fit O/B
5	PCWT-OLS Outer Liner Support Sleeve
6	PB5008M-40 Outer Liner 4mt
7	ETCW1025 Cable Plug Etcw1025 Assembly
8a	PHWB5033-40 Steel Liner x 12.5ft
8b	PHCWB2564-40 Pa Liner x 12.5ft
8c	PHCWB2564AL-40 Pa Liner x 12.5ft
9	PERSP1 Screw Pack
10	PTP25 5 Pin Quick Fit Switch Plug Kit

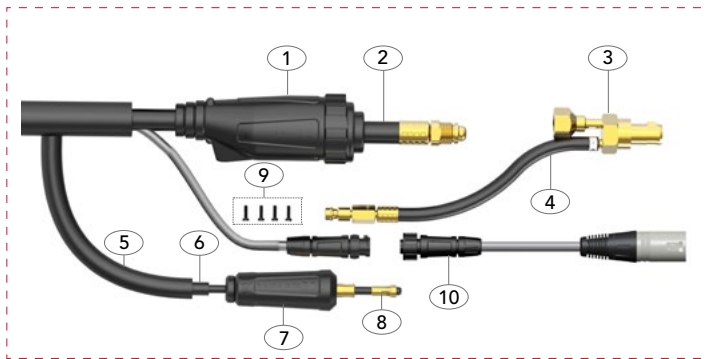

SGTETCW 26 - Cold-Wire

Part No.	Description
1	ML3550H-L MI Surelok Housing
2	PSL46V28AOB Power Cable x 12.5ft Surelok O/B
3	ML3550-916 Mini Surelok Body 9/16"UNF
4	PCWSLOB-1-QGS4 Gas Supply Hose C/W 8.9mm Quick Fit O/B
5	PCWT-OLS Outer Liner Support Sleeve
6	PB5008M-40 Outer Liner 4mt
7	ETCW1025 Cable Plug Etcw1025 Assembly
8a	PHWB5033-40 Steel Liner x 12.5ft
8b	PHCWB2564-40 Pa Liner x 12.5ft
8c	PHCWB2564AL-40 Pa Liner x 12.5ft
9	PERSP1 Screw Pack
10	PTP25 5 Pin Quick Fit Switch Plug Kit

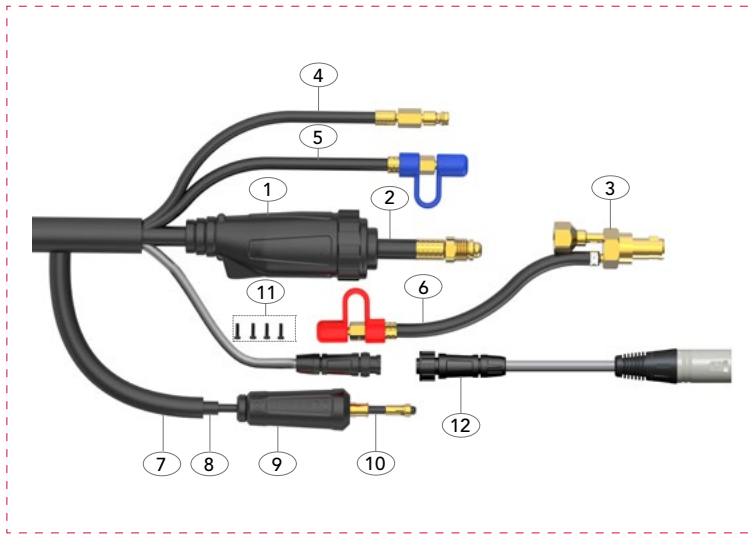

SGTETCW 18/18SC - Cold-Wire

Part No.	Description
1	ML3550H-M MI Surelok Housing
2a	PSL40V64AOB Power Cable x 12.5ft Surelok O/B (18)
2b	PSLHD40V64AOB Power Cable x 12.5ft Surelok O/B (18SC)
3	ML3550-916 Mini Surelok Body 9/16"UNF
4	P45V09-QGS4 Gas Supply Hose 12.5ft C/W 8.9mm Quick Fit PVC
5	PN45V07OB-QWF1 Water Feed 12.5ft C/W 8.9mm Quick Fit O/B
6	PCWSLOB-1-QWR1 Water Return Hose C/W 8.9mm Quick Fit O/B
7	PCWT-OLS Outer Liner Support Sleeve
8	PB5008M-40 Outer Liner 4mt
9	ETCW1025 Cable Plug Etcw1025 Assembly
10a	PHWB5033-40 Steel Liner x 12.5ft
10b	PHCWB2564-40 Pa Liner x 12.5ft
10c	PHCWB2564AL-40 Pa Liner x 12.5ft
11	PERSP1 Screw Pack
12	PTP25 5 Pin Quick Fit Switch Plug Kit



PARKER TORCHOLOGY B.V.

De Marowijne 11-A
1689 AR ZWAAG
THE NETHERLANDS

Tel: +31-(0)229 – 272796

E-mail: andrea@parkertorchology.com