

SPR
MIG/MAG SERIES



Welding Tools for the Professional

A Smart Approach

Parker Torchology is shaped by people with vision, a passion for improvement and a belief in delivering the very best Welding and Cutting Torch Range in the World.

We expect a great deal from our products, so we ask a lot of ourselves and our engineers.

Our mantra: **Innovation, Technology, Performance.**



DNA

Design and Engineering excellence are at the core of everything we do.

Every torch we build is driven by our relentless pursuit of perfection.

Premium Features

At Parker Torchology we do things differently, we strive to solve your problems with the perfect product to suit your needs. We create smart product features encased in cutting-edge design to ensure you always have the best tools to hand.





Production

A fusion of precision production engineering, our bespoke processing techniques and a fanatical attention to detail ensures every welding torch we produce is worthy of the Parker Torchology name.

Testing, Testing, Testing

It takes patience to develop a new product, it's a lot more than a great idea.

Product development is an iterative process, trying something over and over, changing one small variable at a time.

We build endless prototypes and test pieces that undergo months of rigorous testing. Only once a product has passed up to 88 different test procedures, with every single part tested separately do we consider our latest designs ready for market.

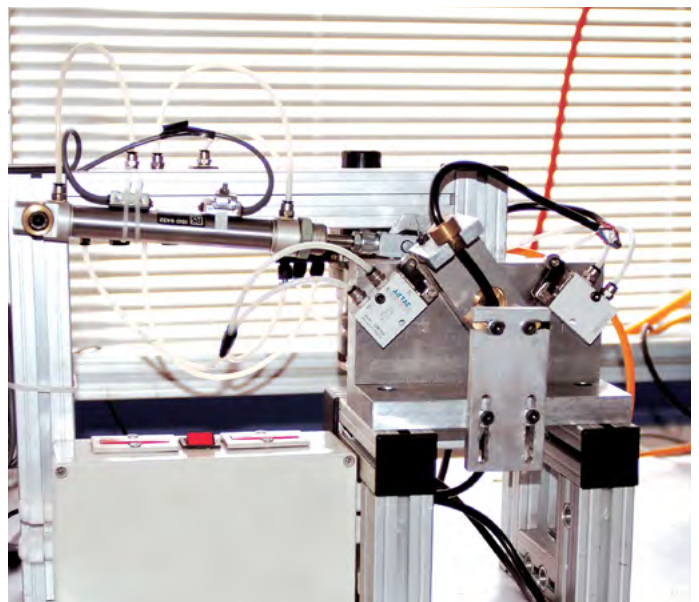

Partners

Our customers and business partners play a vital role in our development. With the core aim to strive together, we work with end users, distributors and academic institutions alike.

As a result we share fundamental values in order to succeed in our respective market places, supporting economic growth and collaborative opportunities with others.



A Bright Future

Technology doesn't stand still, which is why we are constantly innovating to bring you the best products on the market.

Our strong vision and focused innovation strategy, not to mention our passion to revolutionize the industry, ensure that Parker Torchology is a byword for excellence.

We Talk Torches

Contents

	SPR Mig/Mag Torch Range Features Focus	6
	SPR Mig/Mag Torch Range Overview and Ratings	7
	<hr/>	
	Torch Range	
Euro End	SPR 200A	8
	SPR 400A	9
	<hr/>	
	SPR Mig/Mag Torch Range Features Focus	10
	SPR Mig/Mag Torch Range Overview and Ratings	11
	<hr/>	
	Torch Range	
Universal System	SPR 200A	12
	SPR 400A	13
	<hr/>	
	Wear Parts	
	Nozzles	14
	Contact Tips	14
	Diffuser	14
	Liners	14
	<hr/>	
	Rear-End Spare Parts	16
	Universal Kits	18

SPR Mig/Mag Torch Range

Air-Cooled Features Focus

A straight handled series of torches developed to tackle the most demanding of Mig welding jobs.

Air-Cooled

Welding Tools for the Professional



Quality Wear Parts

All wear parts are manufactured to the same specification as the original manufacturer ensuring reliability, longevity and superior performance

Contact Tips

Heavy duty contact tips increase tip life and decrease downtime with fewer tip changes.

- Improved performance for high heat applications

Nozzles

Manufactured to the same specification as the original manufacturer ensuring reliability, longevity and superior performance.

Diffuser

Heavy duty diffusers used with heavy duty tips increase tip life.

- Improved performance for high heat applications.

Superior Flexibility and Durability

Every detail has been considered to ensure the welder has the very best handling in all positions

- Cable supports are designed to combine flexibility with smooth and consistent wire feeding
- Cable sets offer the ultimate in heat and abrasion resistance, fused by an electron beam process that maximizes flexibility and enhances durability



Tough and Resilient

Glass filled polymers are used to produce tough and resilient handle sets and rear end housings

- Euro bodies utilize industry standard (thanks to us!) spring pins
- A broad selection of optional rear-end terminations ensure worldwide compatibility

The Smart Way To Buy Welding and Cutting Tools



SPR Mig/Mag Torch Range

Ratings: 200 Amp to 300 Amp, Mixed Gas M21

Euro Terminations



Model	SPR 200A	SPR 400A
Technical Data		
Cooling Method	Air-Cooled	Air-Cooled
Rating: CO ₂	250A	400A
Rating: Mixed Gas	200A	300A
Duty Cycle	60%	60%
Wire Size	0.9-1.2mm 0.035-0.045"	1.0-1.6mm 0.045-1/16"

Order Codes	10ft/3mt	12ft/4mt	15ft/5mt
	PDUT2010TWE-SP	PDUT2012TWE-SP	PDUT2015TWE-SP
	PDUT4010TWE-SP	PDUT4012TWE-SP	PDUT4015TWE-SP

SPR 200A Mig/Mag Torch Range

Rating: 250A CO₂, 200A mixed gas, EN60974-7 @ 60% duty cycle. 0.9 to 1.2mm / 0.035-0.045" wires

Air-Cooled Mig Welding Torch
Euro Termination

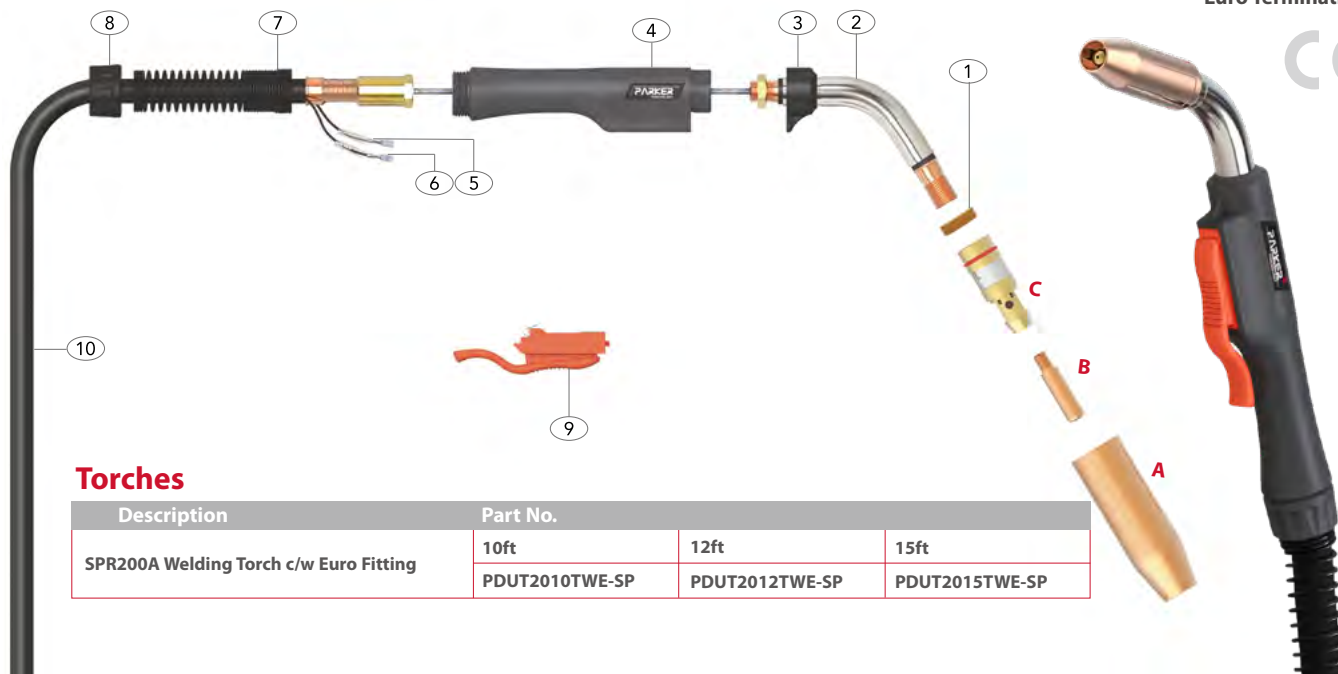

Torches

Description	Part No.		
	10ft	12ft	15ft
SPR200A Welding Torch c/w Euro Fitting	PDU2010TWE-SP	PDU2012TWE-SP	PDU2015TWE-SP

Wear Parts

A Nozzles

Part No.	Description	Bore	Wall	Material
PHD24-50	Nozzle 1/2"	12.7	1.5mm	Copper
*PHD24-62	Nozzle 5/8"	15.9	1.5mm	Copper
PHD24-75	Nozzle 3/4"	19	1.5mm	Copper
PHD24L-S2	Nozzle 5/8"	15.9	1.5mm	Copper

B Contact Tips

Part No.	Description	Material	Wire Size	
			mm	inch
*P16S-35	Contact Tip	Ecu	0.9	0.035
P16S-40	Contact Tip	Ecu	1.0	0.040
P16S-45	Contact Tip	Ecu	1.2	0.045
P16S-52	Contact Tip	Ecu	1.3	0.052
P16S-116	Contact Tip	Ecu	1.6	1/16"
P16S-564	Contact Tip	Ecu	2.0	5/64

C Diffusers

Part No.	Description	Material
*PHD54-16	Gas Diffusers	Brass

D Liners

Part No.	Description	Length	Wire Size	
			mm	inch
*PA42-3035-15	Steel Liner x 15ft	4.90mt	0.8-0.9	0.030-0.035
PA42-3035-25	Steel Liner x 25ft	8.10mt	0.8-0.9	0.030-0.035
PA42-4045-15	Steel Liner x 15ft	4.90mt	1.0-1.2	0.040-0.045
PA42-4045-25	Steel Liner x 25ft	8.10mt	1.0-1.2	0.040-0.045
P42N-4045-15	Polyamide Liner x 15ft	4.90mt	1.0-1.2	0.040-0.045
P42N-4045-25	Polyamide Liner x 25ft	8.10mt	1.0-1.2	0.040-0.045

Spare Parts

Part No.	Description
1 P64J-3S	Head Insulator
2 P205-60	Swan Neck Assembly
3 P210-6	Small Tregaskiss Handle End Cap
4 PRA20017K	Handle Assembly
5 PB1521	Cable Terminal
6 PB1521-C	Cable Terminal Cover
7 PTR8017	Spring Cable Support
8 PTR8003	Handle Lock Nut
9 P211-5	Trigger
10 PDU213-10-M12	Cable Assembly x 10ft
PDU213-12-M12	Cable Assembly x 12ft
PDU213-15-M12	Cable Assembly x 15ft

*Denotes torch package standard wear part set-up
For more information please refer to the following sections:
• Master Wear Parts Table Page 14-15
• Rear-End Spare Parts Page 16

SPR 400A Mig/Mag Torch Range

Rating: 400A CO₂, 300A mixed gas, EN60974-7 @ 60% duty cycle. 1.0 to 1.6mm / 0.040-1/16" wires

Air-Cooled Mig Welding Torch

Euro Termination

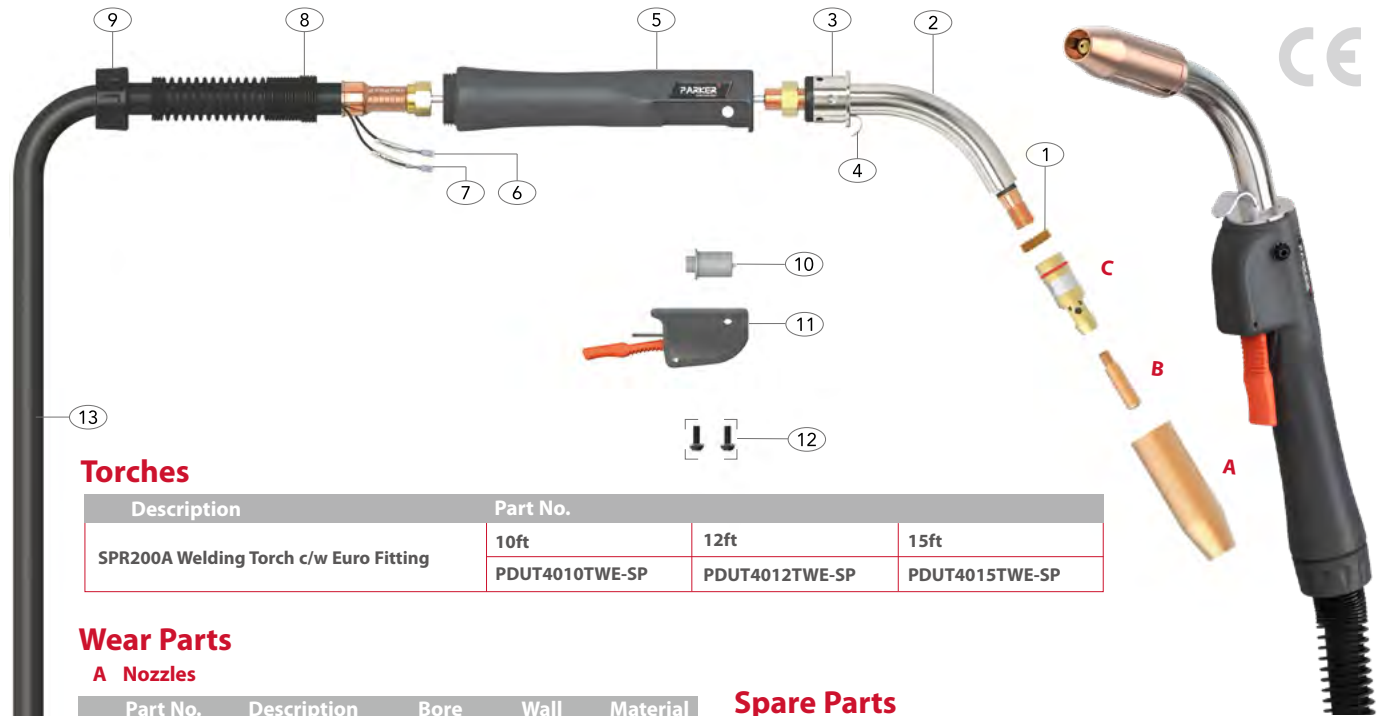

Torches

Description	Part No.		
	10ft	12ft	15ft
SPR200A Welding Torch c/w Euro Fitting	PDUT4010TWE-SP	PDUT4012TWE-SP	PDUT4015TWE-SP

Wear Parts

A Nozzles

Part No.	Description	Bore	Wall	Material
PHD24-50	Nozzle 1/2"	12.7	1.5mm	Copper
*PHD24-62	Nozzle 5/8"	15.9	1.5mm	Copper
PHD24-75	Nozzle 3/4"	19	1.5mm	Copper
PHD24L-52	Nozzle 5/8"	15.9	1.5mm	Copper

B Contact Tips

Part No.	Description	Material	Wire Size	
			mm	inch
P16S-35	Contact Tip	Ecu	0.9	0.035
P16S-40	Contact Tip	Ecu	1.0	0.040
*P16S-45	Contact Tip	Ecu	1.2	0.045
P16S-52	Contact Tip	Ecu	1.3	0.052
P16S-116	Contact Tip	Ecu	1.6	1/16"
P16S-564	Contact Tip	Ecu	2.0	5/64

C Diffusers

Part No.	Description	Material
*PHD54-16	Gas Diffusers	Brass

D Liners

Part No.	Description	Length	Wire Size	
			mm	inch
PA44-116-15	Steel Liner x 15ft	4.90mt	1.6	1/16"
PA44-116-25	Steel Liner x 25ft	8.10mt	1.6	1/16"
*PA44-3545-15	Steel Liner x 15ft	4.90mt	0.9-1.2	0.035-0.045
PA44-3545-25	Steel Liner x 25ft	8.10mt	0.9-1.2	0.035-0.045
P44N-116-15	Steel Liner x 15ft	4.90mt	1.6	1/16"
P44N-116-25	Steel Liner x 25ft	8.10mt	1.6	1/16"

Spare Parts

Part No.	Description
1 P64J-3S	Head Insulator
2 P405-60	Swan Neck Assembly
3 P407	Torch Body Assembly
4 PB2517	Hanger Hook
5 PRA30017K	Handle Assembly
6 PB1521	Cable Terminal
7 PB1521-C	Cable Terminal Cover
8 PTR8018	Cable Support
9 PTR8015	Handle Lock Nut
10 P411-1	Trigger Switch
11 PRA30017Q	Switch Housing c/w Trigger
12 P411-3	No.10-32 UNF Screws c/w Washer
13 PDU413-10-M12	Cable Assembly x 10ft
PDU413-12-M12	Cable Assembly x 12ft
PDU413-15-M12	Cable Assembly x 15ft

*Denotes torch package standard wear part set-up
For more information please refer to the following sections:
•Master Wear Parts Table Page 14-15
•Rear-End Spare Parts Page 16

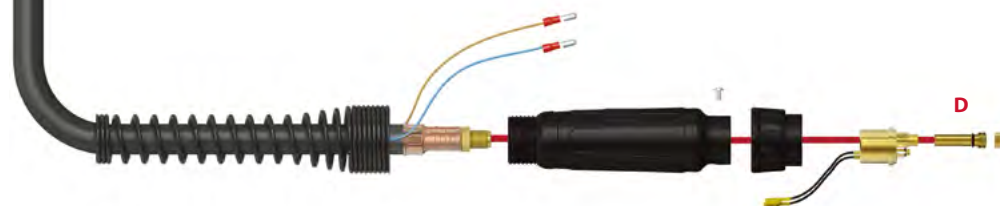

SPR Mig/Mag Torch Range

Air-Cooled Features Focus

A straight handled series of torches developed to tackle the most demanding of Mig welding jobs.

Air-Cooled

Welding Tools for the Professional



Quality Wear Parts

All wear parts are manufactured to the same specification as the original manufacturer ensuring reliability, longevity and superior performance

Contact Tips

Heavy duty contact tips increase tip life and decrease downtime with fewer tip changes.

- Improved performance for high heat applications

Nozzles

Manufactured to the same specification as the original manufacturer ensuring reliability, longevity and superior performance.

Diffuser

Heavy duty diffusers used with heavy duty tips increase tip life.

- Improved performance for high heat applications.

Superior Flexibility and Durability

Every detail has been considered to ensure the welder has the very best handling in all positions

- Cable supports are designed to combine flexibility with smooth and consistent wire feeding
- Cable sets offer the ultimate in heat and abrasion resistance, fused by an electron beam process that maximizes flexibility and enhances durability



Tough and Resilient

Glass filled polymers are used to produce tough and resilient handle sets and rear end housings

- A comprehensive range of USA and European style terminations ensures worldwide compatibility

The Smart Way To Buy Welding and Cutting Tools



SPR Mig/Mag Torch Range

Ratings: 200 Amp to 300 Amp, Mixed Gas

Universal System



Model	SPR 200A	SPR 400A
Technical Data		
Cooling Method	Air-Cooled	Air-Cooled
Rating: CO ₂	250A	400A
Rating: Mixed Gas	200A	300A
Duty Cycle	60%	60%
Wire Size	0.9-1.2mm 0.035-0.045"	1.0-1.6mm 0.045-1/16"

Order Codes	10ft/3mt	12ft/4mt	15ft/5mt
	PDUT2010TWAD-SP	PDUT2012TWAD-SP	PDUT2015TWAD-SP
	PDUT4010TWAD-SP	PDUT4012TWAD-SP	PDUT4015TWAD-SP

SPR 200A Mig/Mag Torch Range

Rating: 250A CO₂, 200A mixed gas, EN60974-7 @ 60% duty cycle. 0.9 to 1.2mm / 0.035-0.045" wires

Air-Cooled Mig Welding Torch
Universal System

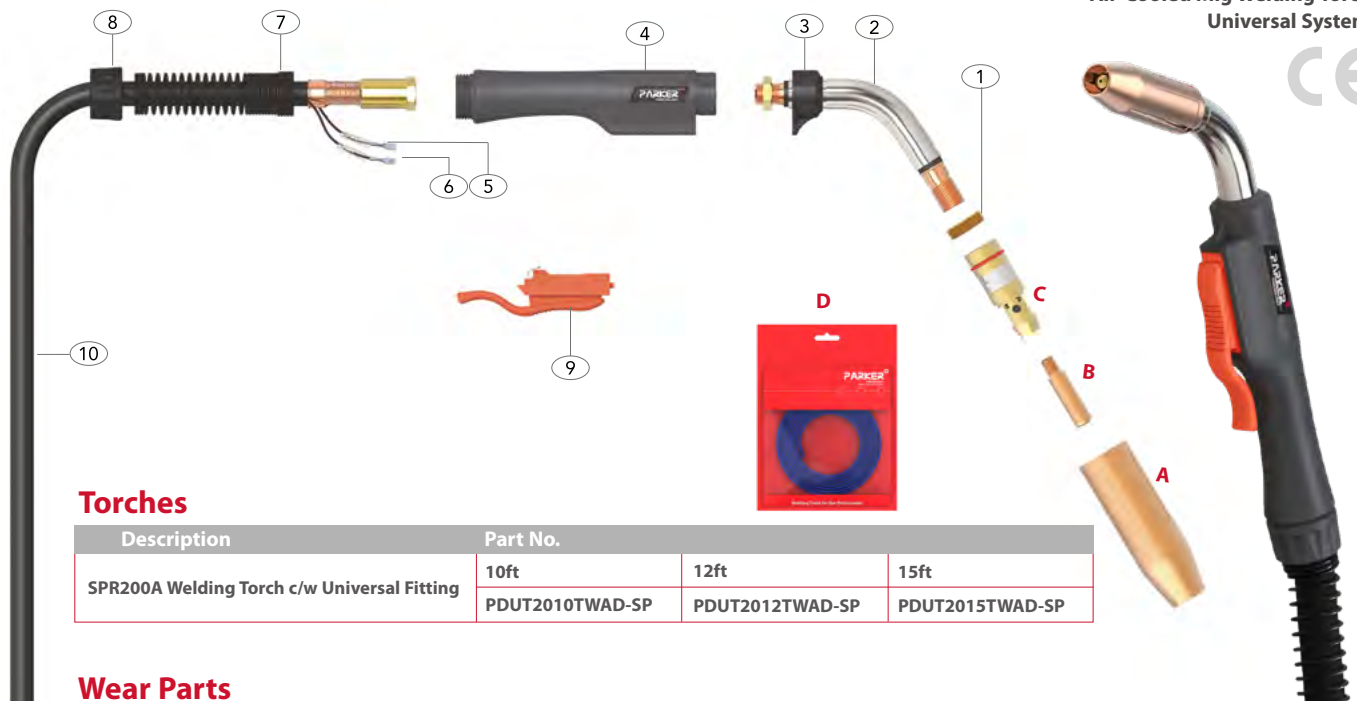

Torches

Description	Part No.		
	10ft	12ft	15ft
SPR200A Welding Torch c/w Universal Fitting	PDUT2010TWAD-SP	PDUT2012TWAD-SP	PDUT2015TWAD-SP

Wear Parts

A Nozzles

Part No.	Description	Bore	Wall	Material
PHD24-50	Nozzle 1/2"	12.7	1.5mm	Copper
*PHD24-62	Nozzle 5/8"	15.9	1.5mm	Copper
PHD24-75	Nozzle 3/4"	19	1.5mm	Copper
PHD24L-S2	Nozzle 5/8"	15.9	1.5mm	Copper

B Contact Tips

Part No.	Description	Material	Wire Size	
			mm	inch
*P16S-35	Contact Tip	Ecu	0.9	0.035
P16S-40	Contact Tip	Ecu	1.0	0.040
P16S-45	Contact Tip	Ecu	1.2	0.045
P16S-52	Contact Tip	Ecu	1.3	0.052
P16S-116	Contact Tip	Ecu	1.6	1/16"
P16S-564	Contact Tip	Ecu	2.0	5/64

C Diffusers

Part No.	Description	Material
*PHD54-16	Gas Diffusers	Brass

D Liners

Part No.	Description	Length	Wire Size	
			mm	inch
*PA42-3035-15	Steel Liner x 15ft	4.90mt	0.8-0.9	0.030-0.035
PA42-3035-25	Steel Liner x 25ft	8.10mt	0.8-0.9	0.030-0.035
PA42-4045-15	Steel Liner x 15ft	4.90mt	1.0-1.2	0.040-0.045
PA42-4045-25	Steel Liner x 25ft	8.10mt	1.0-1.2	0.040-0.045
P42N-4045-15	Polyamide Liner x 15ft	4.90mt	1.0-1.2	0.040-0.045
P42N-4045-25	Polyamide Liner x 25ft	8.10mt	1.0-1.2	0.040-0.045

Spare Parts

Part No.	Description
1 P64J-35	Head Insulator
2 P205-60	Swan Neck Assembly
3 P210-6	Small Tregaskiss Handle End Cap
4 PRA20017K	Handle Assembly
5 PB1521	Cable Terminal
6 PB1521-C	Cable Terminal Cover
7 PTR8017	Spring Cable Support
8 PTR8003	Handle Lock Nut
9 P211-5	Trigger
10 PDU213-10-M12	Cable Assembly x 10ft
PDU213-12-M12	Cable Assembly x 12ft
PDU213-15-M12	Cable Assembly x 15ft

*Denotes torch package standard wear part set-up
For more information please refer to the following sections:
• Master Wear Parts Table Page 14-15
• Rear-End Spare Parts Page 16

SPR 400A Mig/Mag Torch Range

Rating: 400A CO₂, 300A mixed gas, EN60974-7 @ 60% duty cycle. 1.0 to 1.6mm / 0.040-1/16" wires

Air-Cooled Mig Welding Torch
Universal System

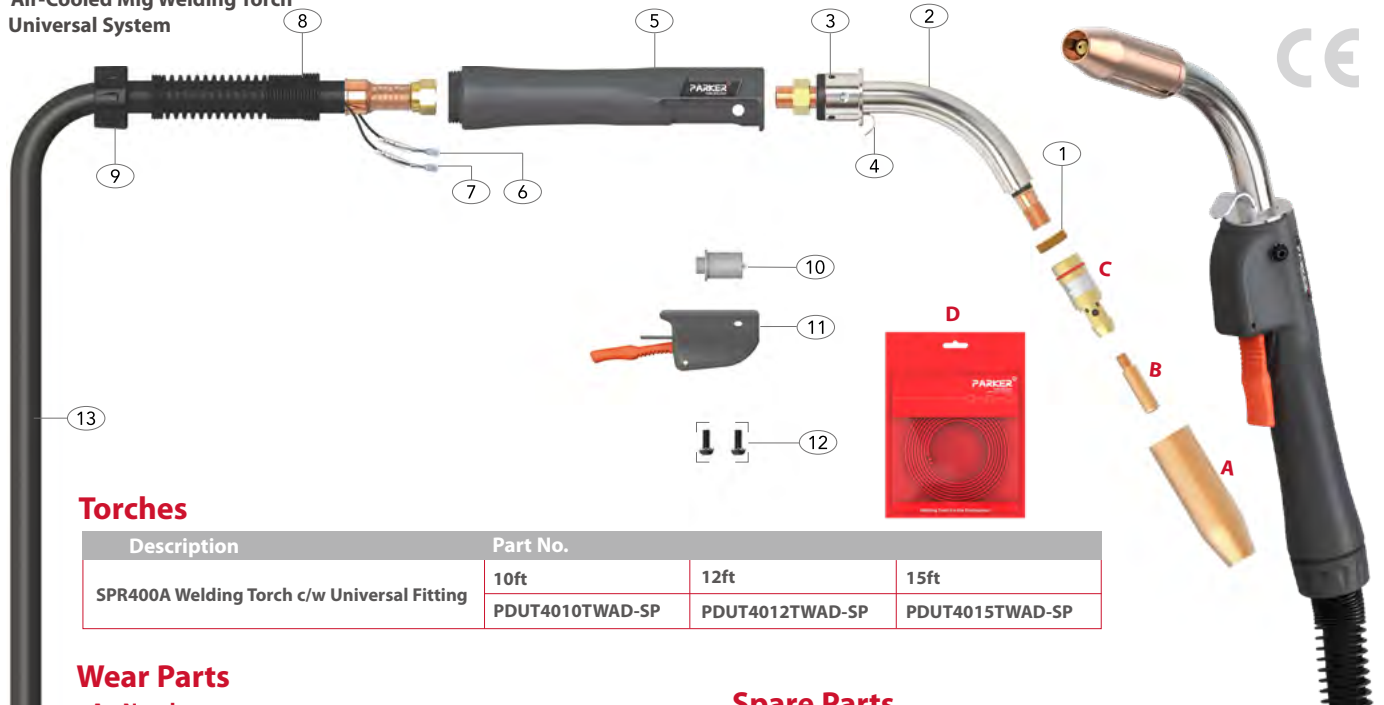

Torches

Description	Part No.		
	10ft	12ft	15ft
SPR400A Welding Torch c/w Universal Fitting	PDUT4010TWAD-SP	PDUT4012TWAD-SP	PDUT4015TWAD-SP

Wear Parts

A Nozzles

Part No.	Description	Bore	Wall	Material
PHD24-50	Nozzle 1/2"	12.7	1.5mm	Copper
*PHD24-62	Nozzle 5/8"	15.9	1.5mm	Copper
PHD24-75	Nozzle 3/4"	19	1.5mm	Copper
PHD24L-52	Nozzle 5/8"	15.9	1.5mm	Copper

B Contact Tips

Part No.	Description	Material	Wire Size	
			mm	inch
P16S-35	Contact Tip	Ecu	0.9	0.035
P16S-40	Contact Tip	Ecu	1.0	0.040
*P16S-45	Contact Tip	Ecu	1.2	0.045
P16S-52	Contact Tip	Ecu	1.3	0.052
P16S-116	Contact Tip	Ecu	1.6	1/16"
P16S-564	Contact Tip	Ecu	2.0	5/64

C Diffusers

Part No.	Description	Material
*PHD54-16	Gas Diffusers	Brass

D Liners

Part No.	Description	Length	Wire Size	
			mm	inch
PA44-116-15	Steel Liner x 15ft	4.90mt	1.6	1/16"
PA44-116-25	Steel Liner x 25ft	8.10mt	1.6	1/16"
*PA44-3545-15	Steel Liner x 15ft	4.90mt	0.9-1.2	0.035-0.045
PA44-3545-25	Steel Liner x 25ft	8.10mt	0.9-1.2	0.035-0.045
P44N-116-15	Steel Liner x 15ft	4.90mt	1.6	1/16"
P44N-116-25	Steel Liner x 25ft	8.10mt	1.6	1/16"

Spare Parts

Part No.	Description
1 P64J-35	Head Insulator
2 P405-60	Swan Neck Assembly
3 P407	Torch Body Assembly
4 PB2517	Hanger Hook
5 PRA30017K	Handle Assembly
6 PB1521	Cable Terminal
7 PB1521-C	Cable Terminal Cover
8 PTR8018	Cable Support
9 PTR8015	Handle Lock Nut
10 P411-1	Trigger Switch
11 PRA30017Q	Switch Housing c/w Trigger
12 P411-3	No.10-32 UNF Screws c/w Washer
13 PDU413-10-M12	Cable Assembly x 10ft
PDU413-12-M12	Cable Assembly x 12ft
PDU413-15-M12	Cable Assembly x 15ft

*Denotes torch package standard wear part set-up
For more information please refer to the following sections:
•Master Wear Parts Table Page 14-15
•Rear-End Spare Parts Page 16

Nozzles

SPR 200A/400A

Part No.	Description	Bore	Wall	Material
PHD24-50	Nozzle 1/2"	12.7	1.50mm	Copper
*PHD24-62	Nozzle 5/8"	15.9	1.50mm	Copper
PHD24-75	Nozzle 3/4"	19	1.50mm	Copper

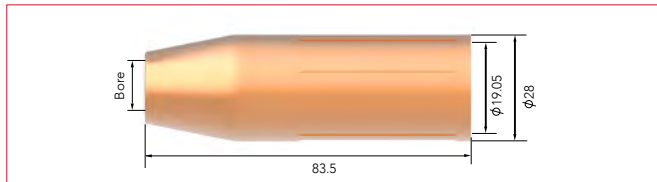

PHD24L-S2	Nozzle 5/8"	15.9	2mm	Copper
-----------	-------------	------	-----	--------

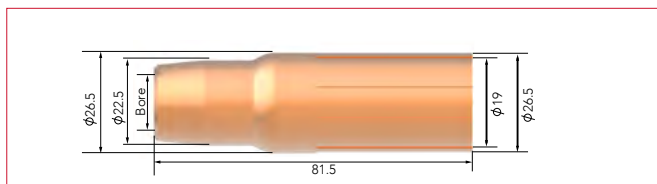

Contact Tips

SPR 200A/400A

Part No.	Description	Wire Size		Material
		mm	Inch	
*P16S-35	Contact Tip	0.9	0.035	Ecu
P16S-40	Contact Tip	1.0	0.040	Ecu
*P16S-45	Contact Tip	1.2	0.045	Ecu
P16S-52	Contact Tip	1.3	0.052	Ecu
P16S-116	Contact Tip	1.6	1/16"	Ecu
P16S-564	Contact Tip	2.0	5/64"	Ecu

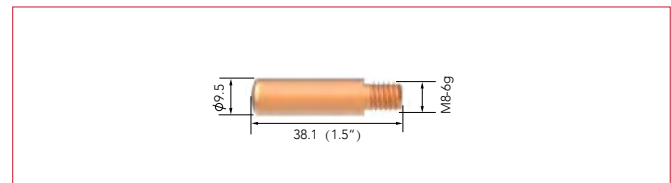

Diffuser

SPR 200A/400A

Part No.	Description	Material
*PHD54-16	Gas Diffuser	Brass

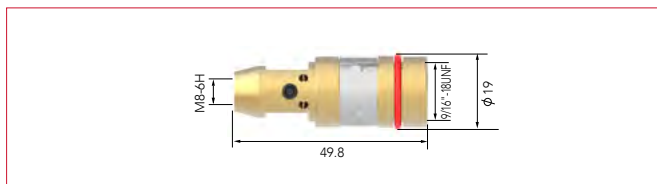

Liner Options 0.8-0.9mm

SPR 200A

Part No.	Description	Length	Nipple	Wire Size	
				mm	Inch
PA42-3035-15	Steel Liner x 15ft	4.90mt	Brass Nipple	0.8-0.9	0.030-0.035
PA42-3035-25	Steel Liner x 25ft	8.10mt	Brass Nipple	0.8-0.9	0.030-0.035

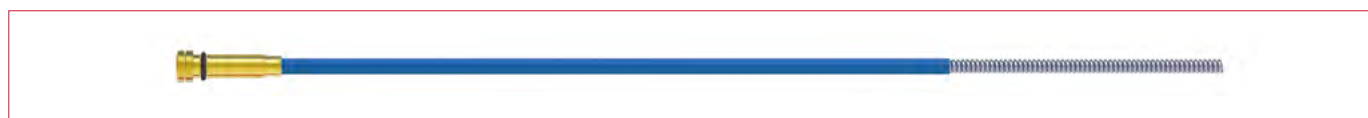

* Denotes torch package standard wear part set-up

Liner Options 0.9-1.2mm

SPR 200A

Part No.	Description	Length	Nipple	Wire Size	
				mm	inch
PA42-4045-15	Steel Liner x 15ft	4.90mt	Brass Nipple	1.0-1.2	0.040-0.045
PA42-4045-25	Steel Liner x 25ft	8.10mt	Brass Nipple	1.0-1.2	0.040-0.045



SPR 200A

Part No.	Description	Length	Nipple	Wire Size	
				mm	inch
P42N-4045-15	Polyamide Liner x 15ft	4.90mt	Brass Nipple	1.0-1.2	0.040-0.045
P42N-4045-25	Polyamide Liner x 25ft	8.10mt	Brass Nipple	1.0-1.2	0.040-0.045



SPR 400A

Part No.	Description	Length	Nipple	Wire Size	
				mm	inch
*PA44-3545-15	Steel Liner x 15ft	4.90mt	Brass Nipple	0.9-1.2	0.035-0.045
PA44-3545-25	Steel Liner x 25ft	8.10mt	Brass Nipple	0.9-1.2	0.035-0.045



SPR 400A

Part No.	Description	Length	Nipple	Wire Size	
				mm	inch
PA44-116-15	Steel Liner x 15ft	4.90mt	Brass Nipple	0.9-1.2	0.035-0.045
PA44-116-25	Steel Liner x 25ft	8.10mt	Brass Nipple	0.9-1.2	0.035-0.045



SPR 400A

Part No.	Description	Length	Nipple	Wire Size	
				mm	inch
P44N-116-15	Steel Liner x 15ft	4.90mt	Brass Nipple	0.9-1.2	0.035-0.045
P44N-116-25	Steel Liner x 25ft	8.10mt	Brass Nipple	0.9-1.2	0.035-0.045



* Denotes torch package standard wear part set-up

SPR 200A

Part No.	Description
1 PC3641	Cable Support
2 PXL1542	Cable End Lock Nut
3 SCPSP1-1	Gun Plug Housing Screw
4 SCP2578H-S	Gun Plug Housing
5 PBL1541	Gun Plug Screw
6 PECEM1575-2	Hybrid Plug Body TWC 1-4
7 PB1522	Cable Terminal Male
8 PQF-SW	Male Switch Wire Plug

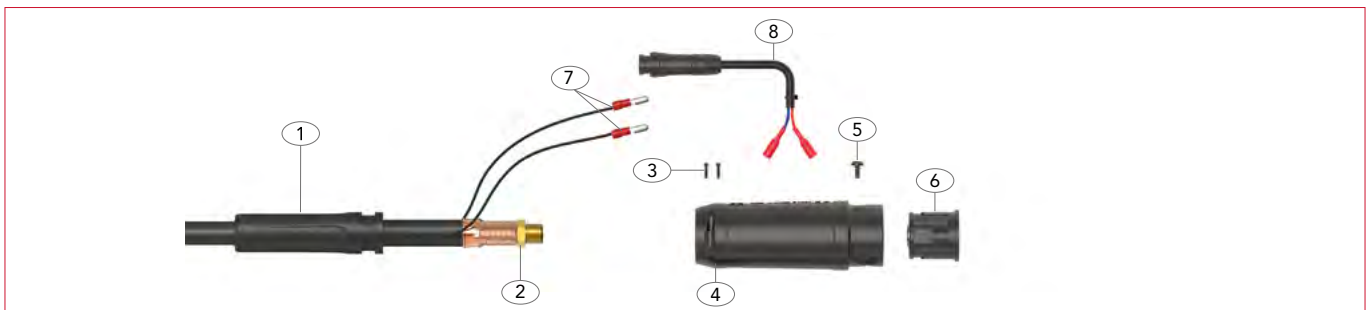

SPR 400A

Part No.	Description
1 PC8026	Housing Spring
2 PXL1542	Cable End Lock Nut
3 PBL1541	Gun Plug Screw
4 PT8028	Large Housing Spring Connector
5 PT5022	Gun Plug Housing Assembly
6 PECEM1575-2	Hybrid Plug Body TWC 1-4
7 PB1522	Cable Terminal Male
8 PQF-SW-C	Quick Fit Switch Wire Plug With Cover

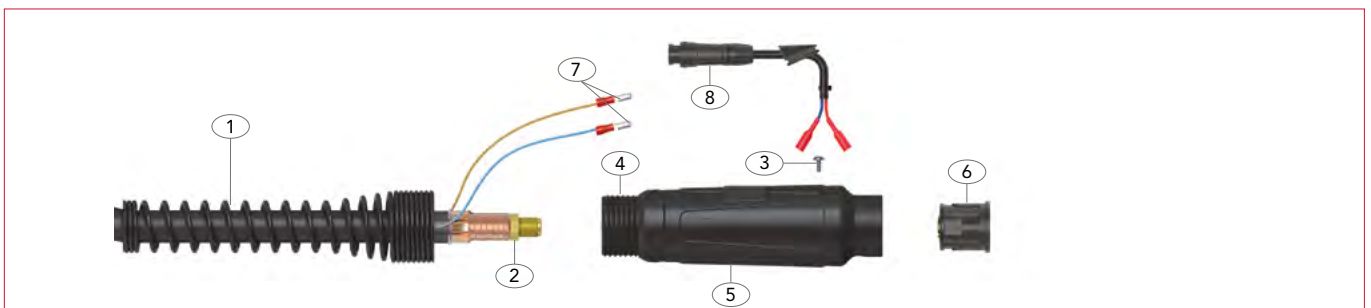

Euro Termination

SPR 200A

Part No.	Description
1 PC3641	Cable Support
2 PXL1542	Cable End Lock Nut (M12 x 1.0)
3 PB1522	Cable Terminal Male
4 SCPSP1-1	Gun Plug Housing Screw
5 SC2578/S	Gun Plug Housing
6 PBL1541	Gun Plug Screw
7 PC1519/S	Gun Plug Nut
8 PB1523	Gun Plug Terminal Female
9 PC174EX-1	Gun Plug Body
10 PB1524	Gun Plug 'O' Ring
11 PXL1826	Liner Retaining Nut

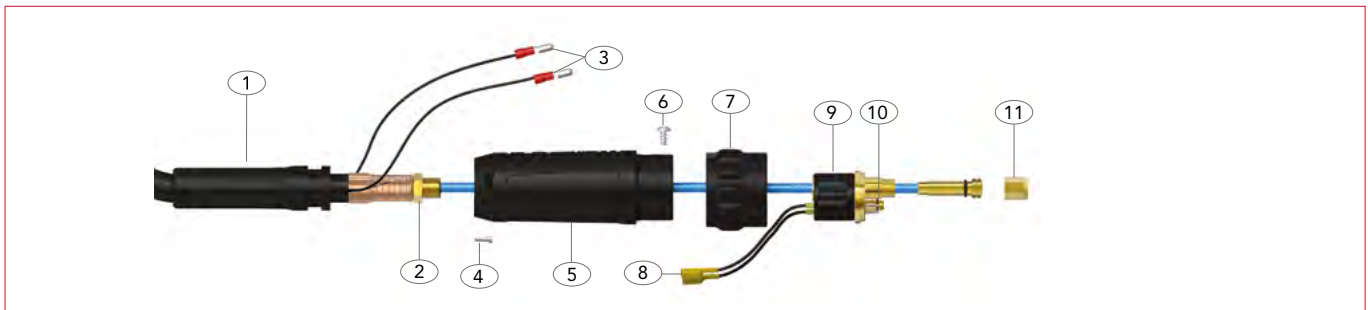

SPR 400A

Part No.	Description
1 PC8026	Housing Spring
2 PXL1542	Cable End Lock Nut (M12 x 1.0)
3 PB1522	Cable Terminal Male
4 PT8028	Cable Support Nut
5 PT5022	Large Housing
6 SCP8017	Large Housing Wire Cover
7 PB1526	Gun Plug Screw
8 PB1519/S	Gun Plug Nut
9 PB1523	Gun Plug Terminal Female
10 P174EX-1	Gun Plug Body
11 PB1524	Gun Plug 'O' Ring
12 PXL1826	Liner Retaining Nut

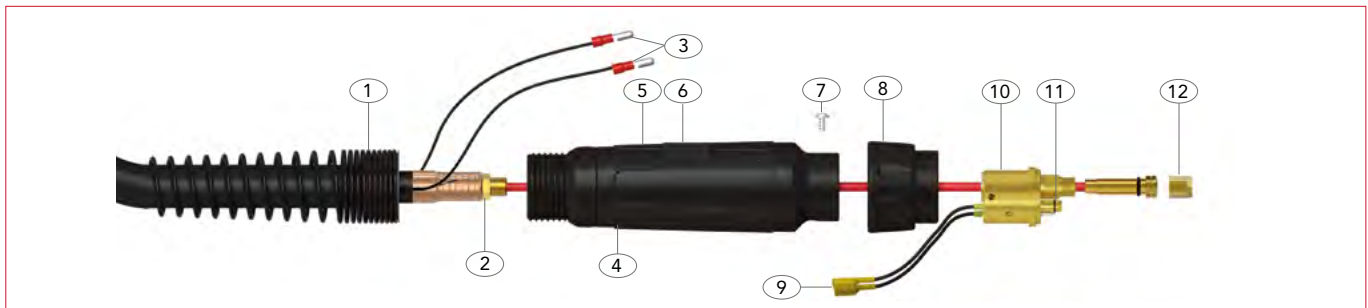

Tweco® Universal Kit

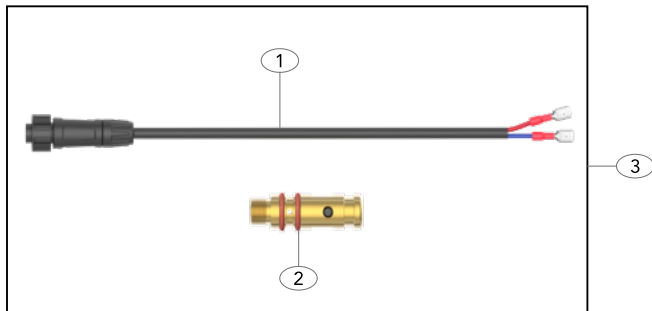

Direct Plug Connector	
Part Number	Description
1 ECEL1575-SW-Q	Quick Fit Switch Wire Assembly
2 ECET1575-1	Tweco® 1-4 Power Pin
3 ECET1575K-Q	Quick Fit Connector Kit Complete

Miller® Universal Kit

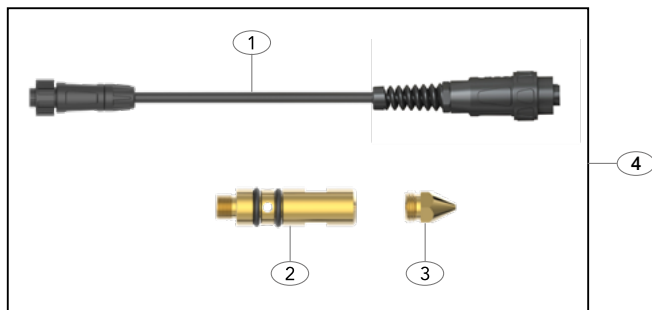

Direct Plug Connector	
Part Number	Description
1 ECEM1575-SW-Q	Quick Fit Miller® Plug Assembly
2 ECEM1575-1	Miller® Power Pin
3 ML1570	Wire Guide 0.35"-1/16"
ML1571	Wire Guide 5/16-3/32"(Option)
4 ECEM1575K-Q	Quick Fit Connector Kit Complete

Lincoln® Universal Kit

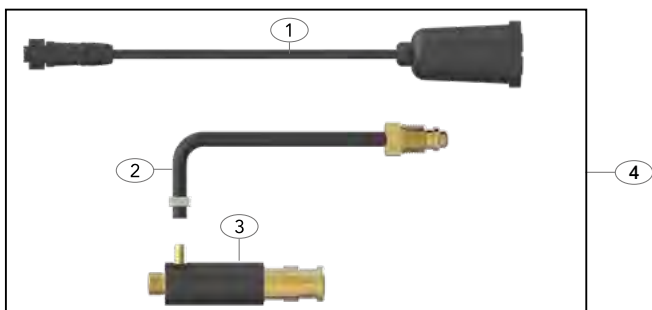

Direct Plug Connector	
Part Number	Description
1 M16725-Q	Quick Fit Lincoln® Plug Assembly
2 ECEL1575N-G	Lincoln® Gas Tube Assembly
3 ECEL1575N-T	Lincoln® Power Pin
4 ECEL1575K-Q	Quick Fit Connector Kit Complete

LPW Universal Kit

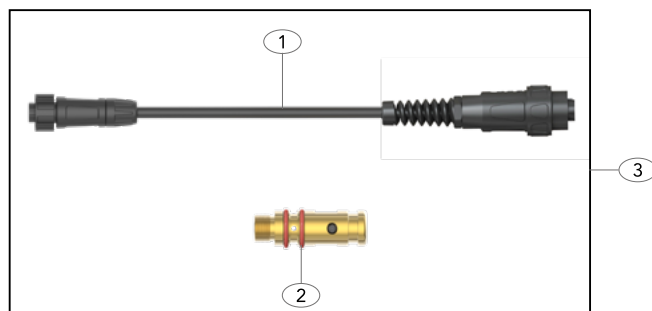

Direct Plug Connector	
Part Number	Description
1 ECEM1575-SW-Q	Quick Fit Miller® Plug Assembly
2 ECET1575-1	Tweco® 1-4 Power Pin
3 ECEW1575K-Q	Quick Fit Connector Kit Complete



Universal Set-up Guide
A simple step by step guide

All products conform to EN60974-7, **CE** and are RoHS2, REACH and WEEE compliant

Universal Kits

Connector Kits

LPB Universal Kit

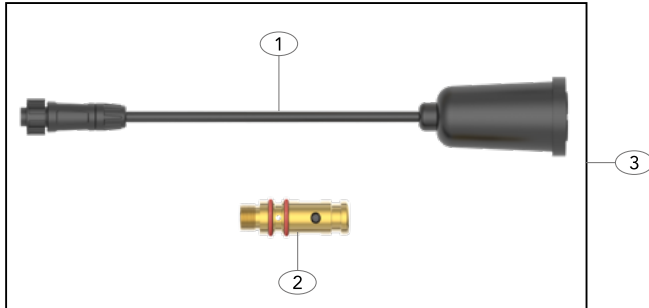

Direct Plug Connector

Part Number	Description
1 M16725-Q	Quick Fit Lincoln® Plug Assembly
2 ECET1575-1	Tweco® 1-4 Power Pin
3 ECEB1575K-Q	Quick Fit Connector Kit Complete

Euro Connector Kits

SPR 200A Universal Kit

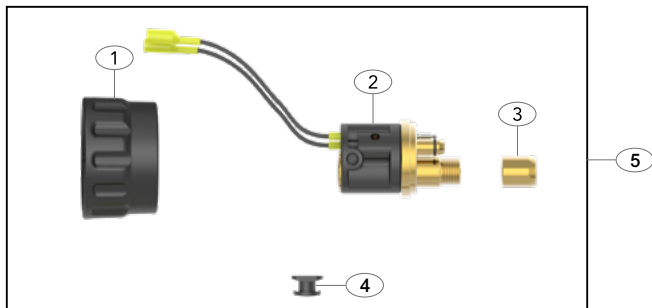

Direct Plug Connector

Part Number	Description
1 PC1519-S	Gun Plug Nut
2 PC174EX-1	Gun Plug Body
3 PXL1826	Liner Retaining Nut
4 SC2578-SP2	Housing Stopper
5 PC174EX-1-KIT-QS	Quick Fit Connector Kit Complete

SPR 400A Universal Kit

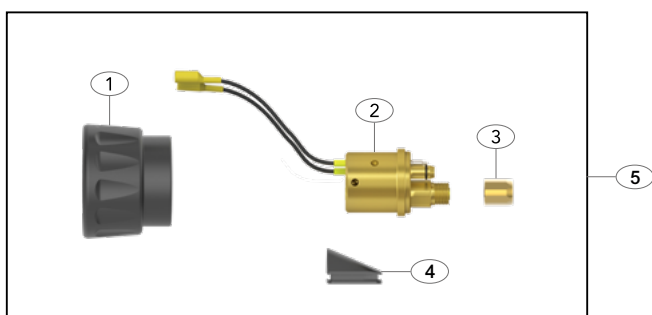

Direct Plug Connector

Part Number	Description
1 PB1519-S	Gun Plug Nut
2 P174EX-1	Gun Plug Body
3 PXL1826	Liner Retaining Nut
4 SC8017	Large Housing Wire Cover
5 P17EX-1-KIT-QL	Quick Fit Connector Kit Complete



Universal Set-up Guide
A simple step by step guide

* Denotes torch package standard wear part set-up



JINAN UNIARC WELDING TECHNOLOGY CO., LTD
13A Zhangjin Comprehensive Bonded Zone
33688, Jing Shi Dong Road
Jinan Area of China (Shandong) Pilot Free Trade Zone
Jinan 250102, P.R. China

Tel: +86 531 88239823

Website: www.uniarctorchology.com

Email: info@uniarctorchology.com

MPP012 / V.2025.01